

REFER TO 400 878 200 0_006 FOR RADAR AND FASCIA POSITIONING.

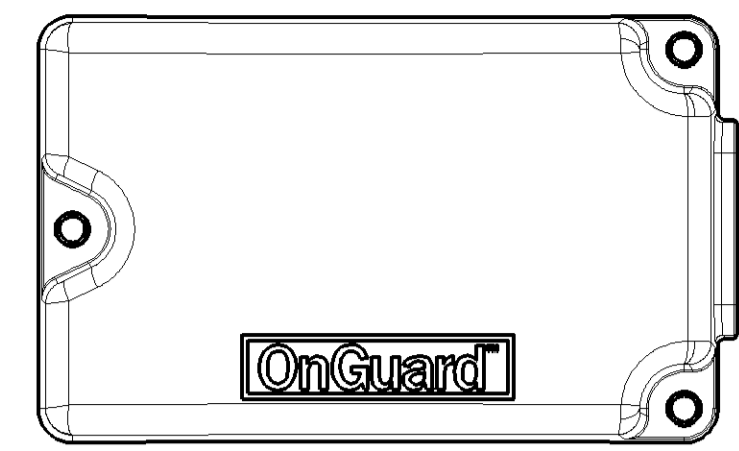

400 878 200 0- RADAR FASCIA COVER-REGD
 FOR REFERENCE ONLY-NOT INCLUDED
 SEE 400 878 200 0 DOC 005 FOR FURTHER INFORMATION

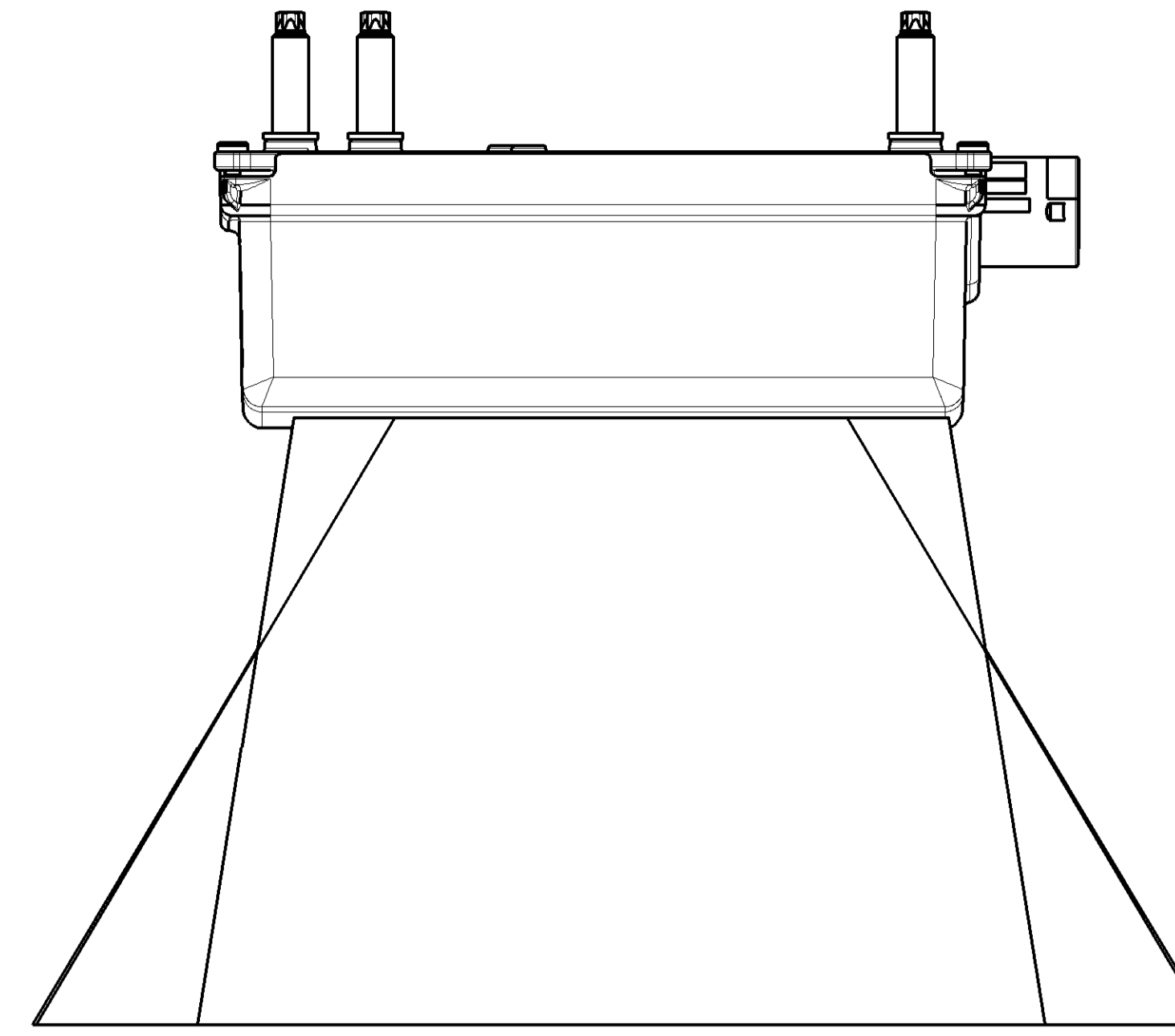
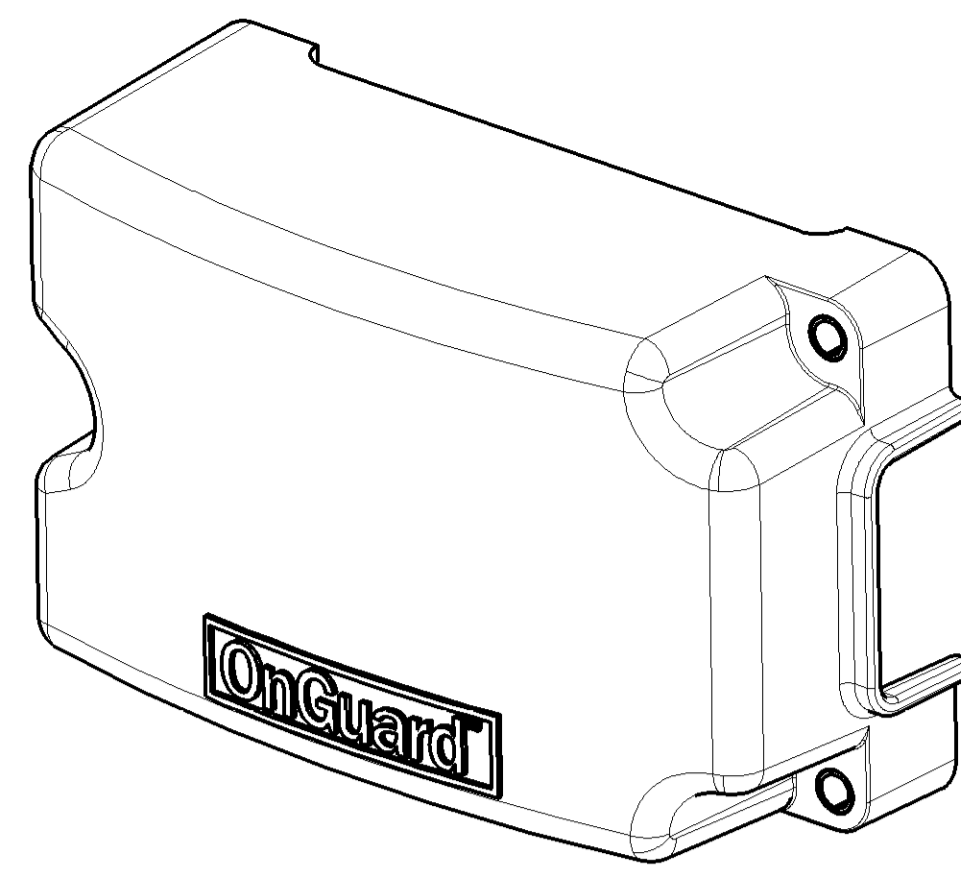
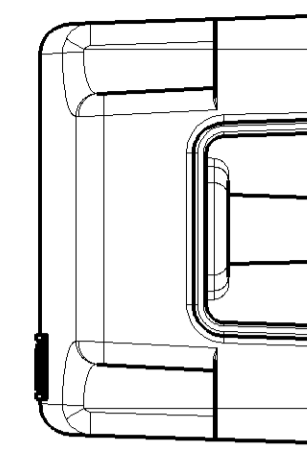

SOCKET HOUSING ACC. TO AMP-NO. 1-1534229-1 CODING A
 COUPLER NOT INCLUDED IN DELIVERY AND IS RESPONSIBILITY OF THE OEM

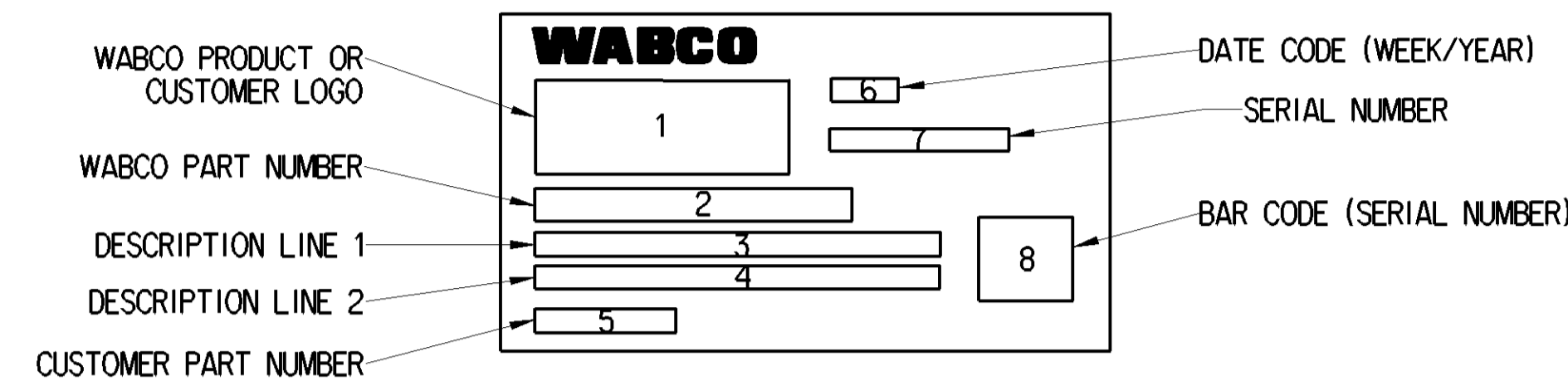

DETAIL A
 FOR REFERENCE ONLY

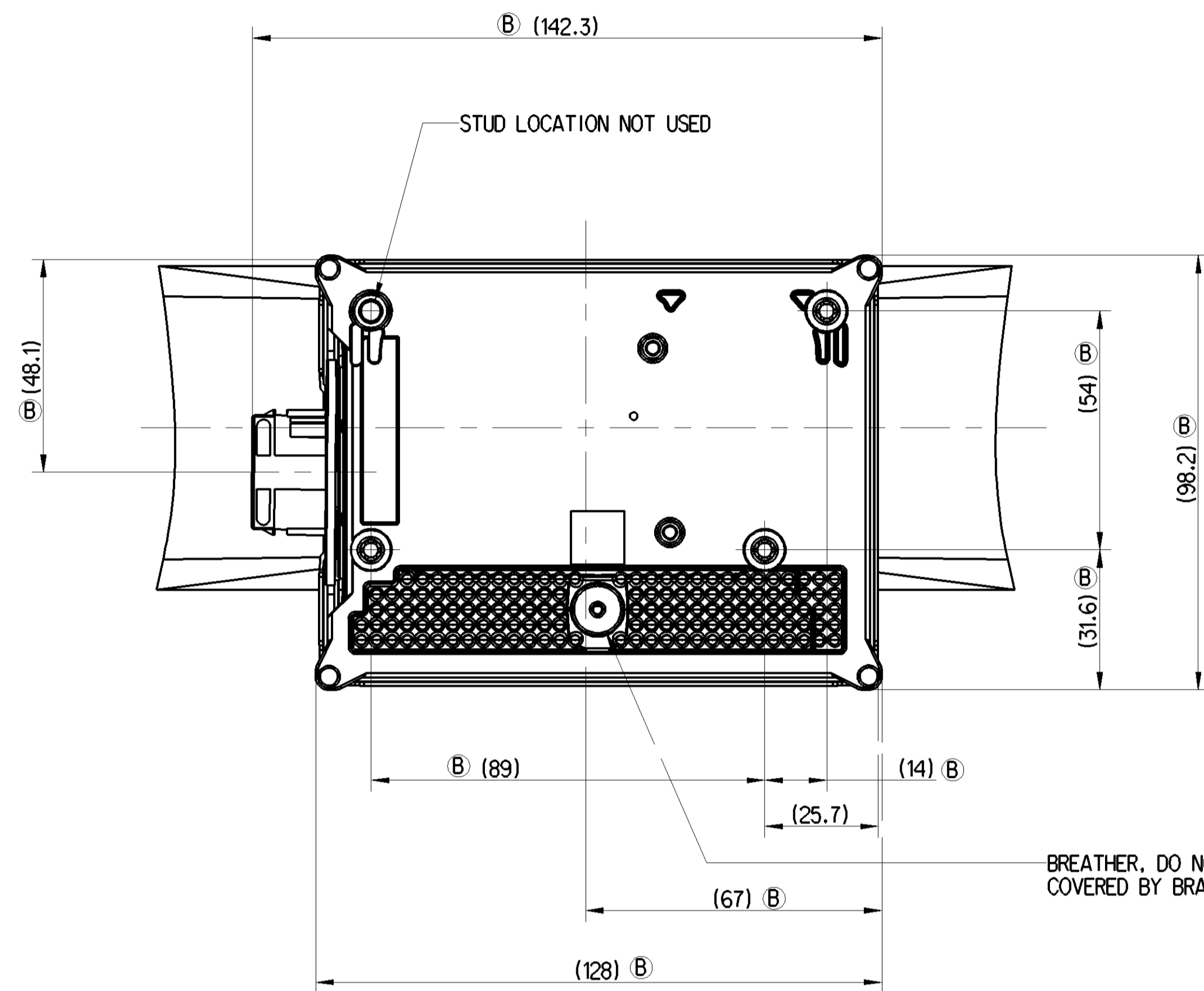

BREATHER. DO NOT PUSH THINGS THROUGH,
 COVERED BY BRACKET: 1P6KSK

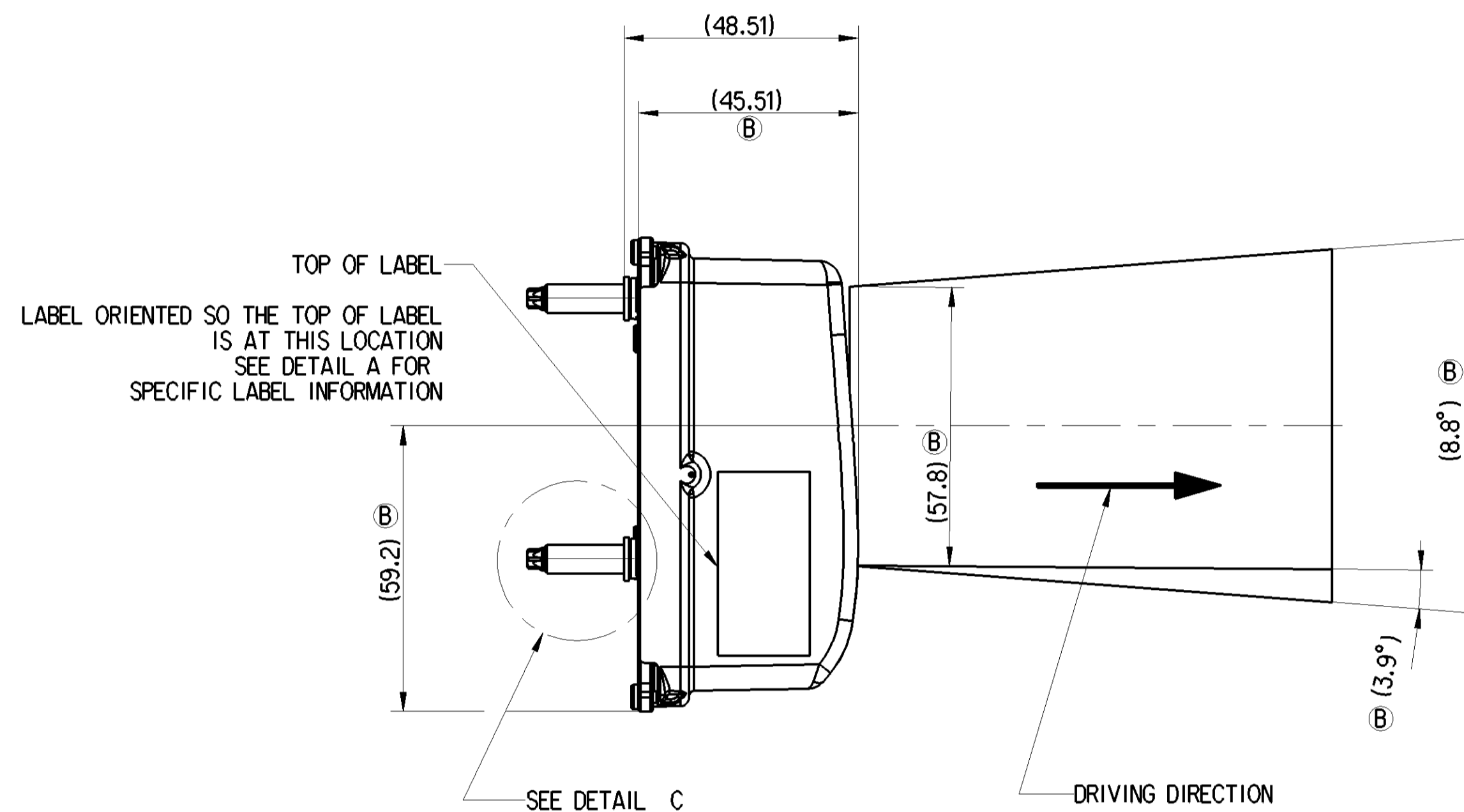

TOP OF LABEL
 LABEL ORIENTED SO THE TOP OF LABEL
 IS AT THIS LOCATION
 SEE DETAIL A FOR
 SPECIFIC LABEL INFORMATION

SEE DETAIL C
 DRIVING DIRECTION

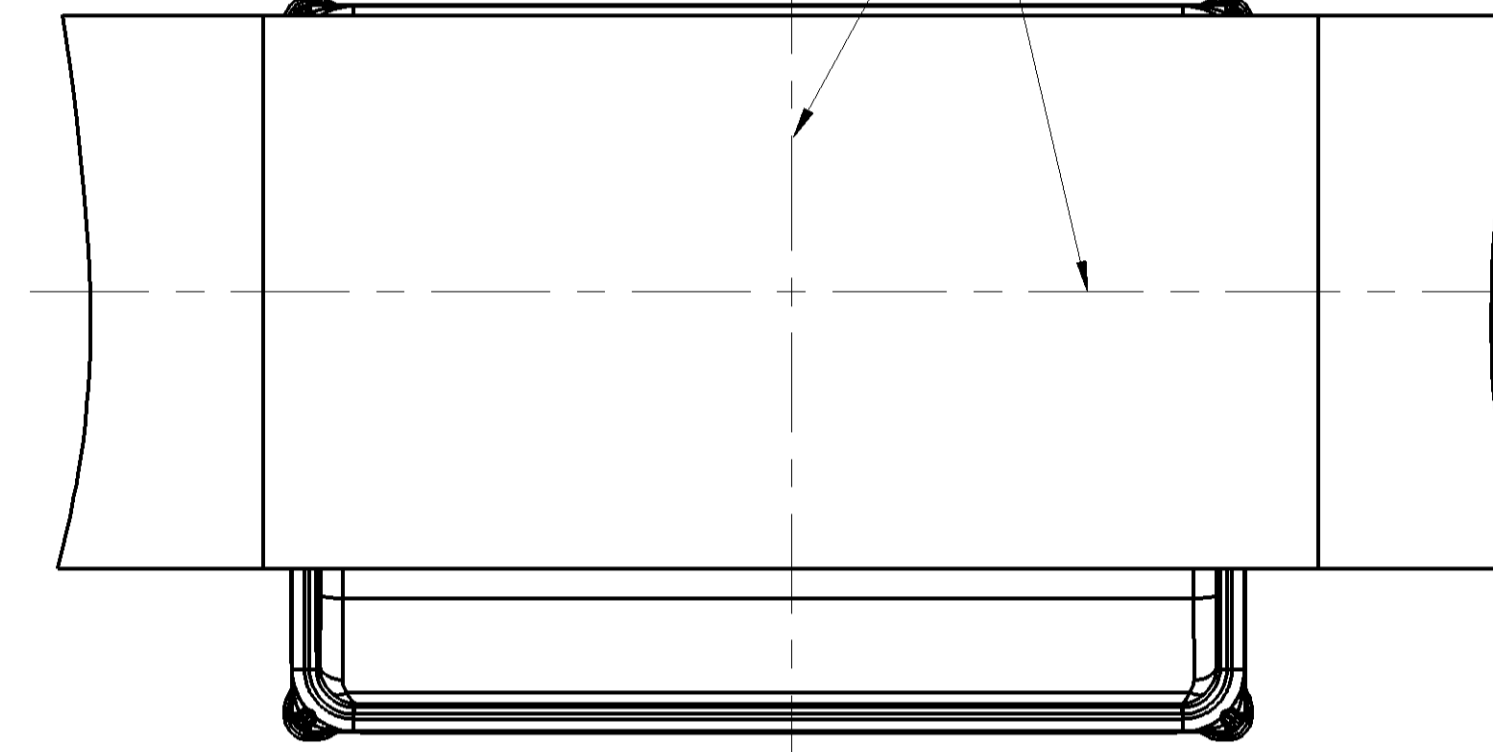

CENTER AXIS FOR RADAR BEAM

MATERIAL AND DESIGN OF COVERS IN THIS AREA NEED
 AGREEMENT WITH WABCO

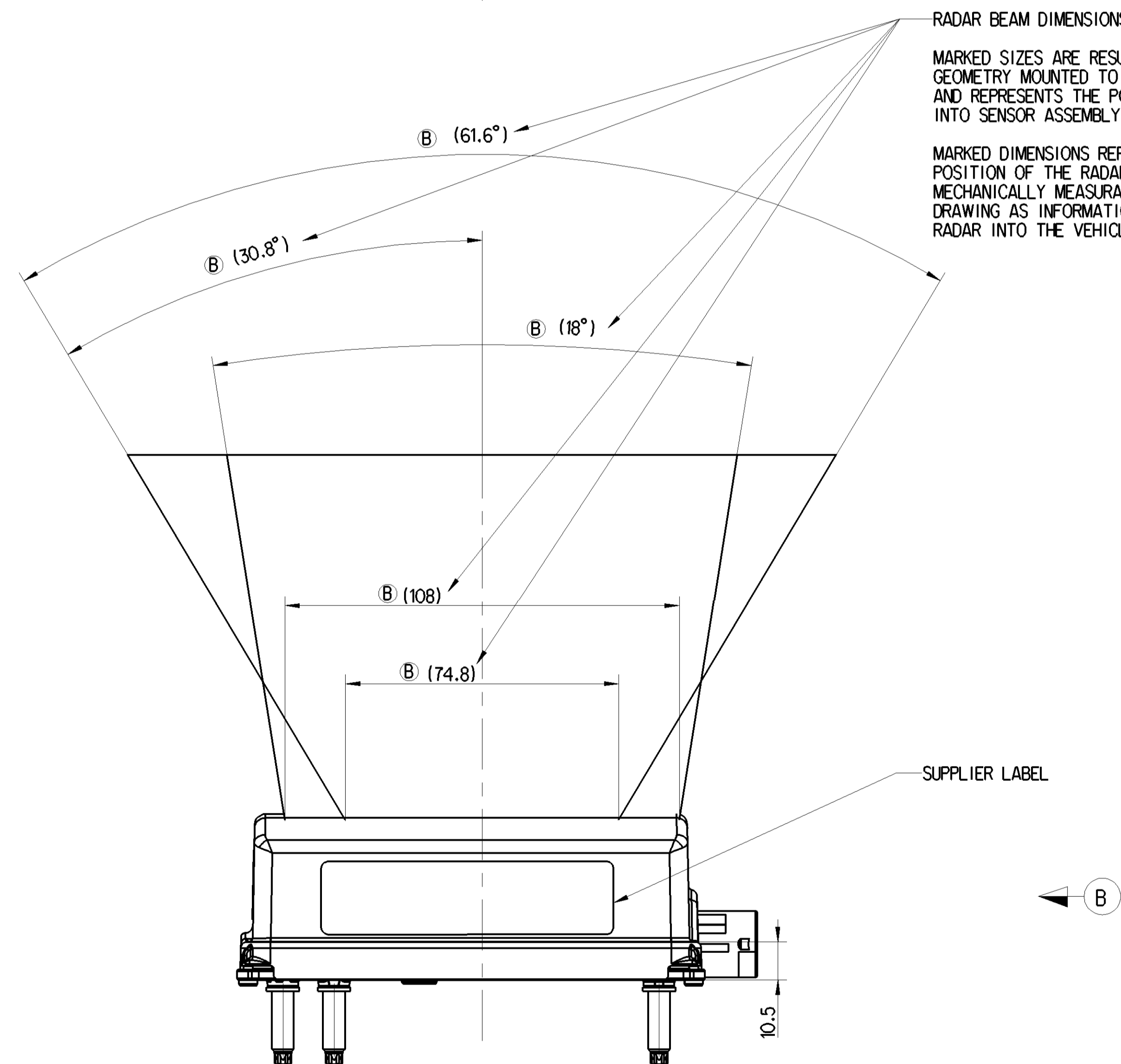
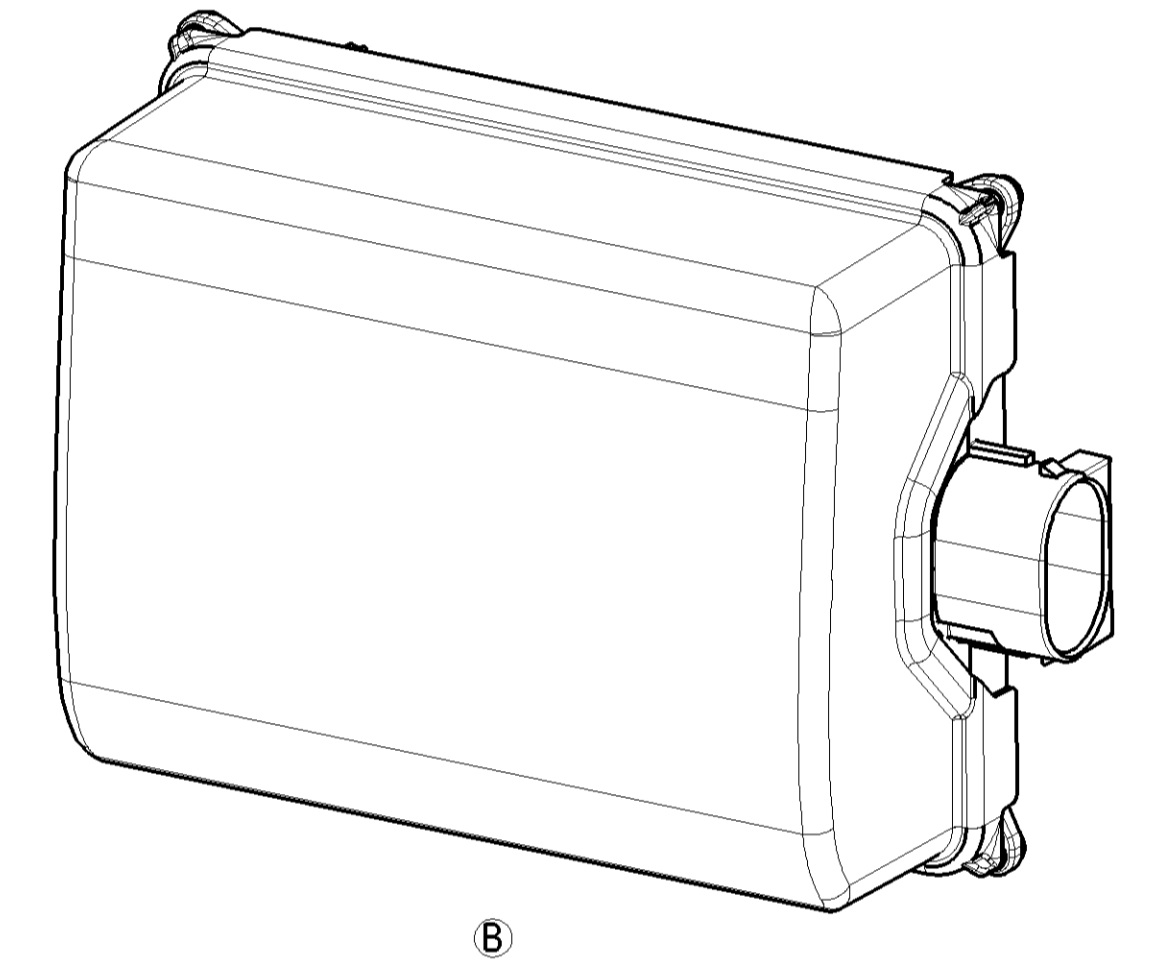
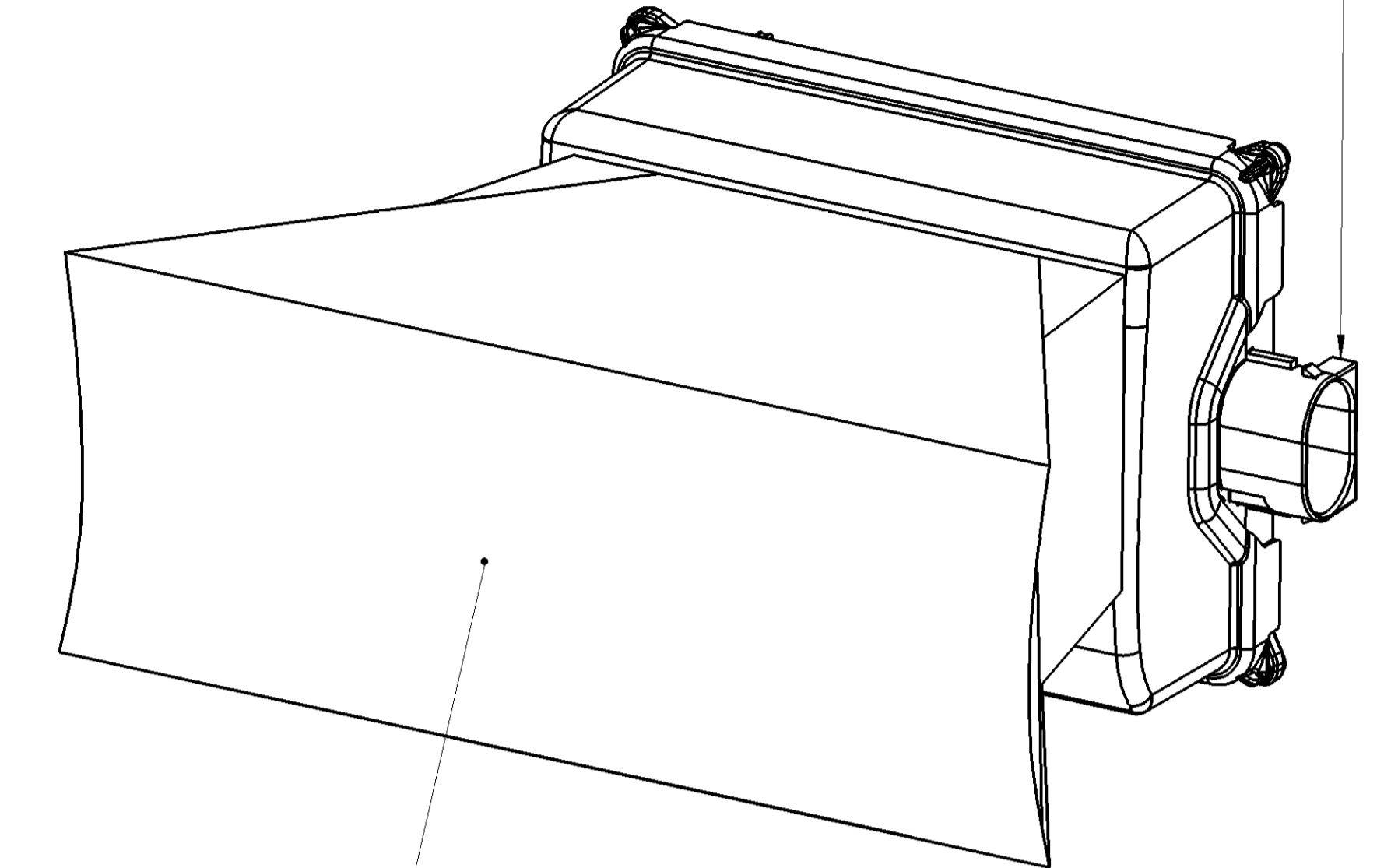

RADAR BEAM DIMENSIONS
 MARKED SIZES ARE RESULTING FROM THE PART
 GEOMETRY MOUNTED TO THE SENSOR ASSEMBLY
 AND REPRESENTS THE POSITION OF RADAR BEAM
 INTO SENSOR ASSEMBLY.
 MARKED DIMENSIONS REPRESENT THE ANGLE AND
 POSITION OF THE RADAR BEAM. THE SIZES ARE NOT
 MECHANICALLY MEASURABLE AND SHOWN IN THE
 DRAWING AS INFORMATION, FOR MOUNTING THE
 RADAR INTO THE VEHICLE.

SUPPLIER LABEL

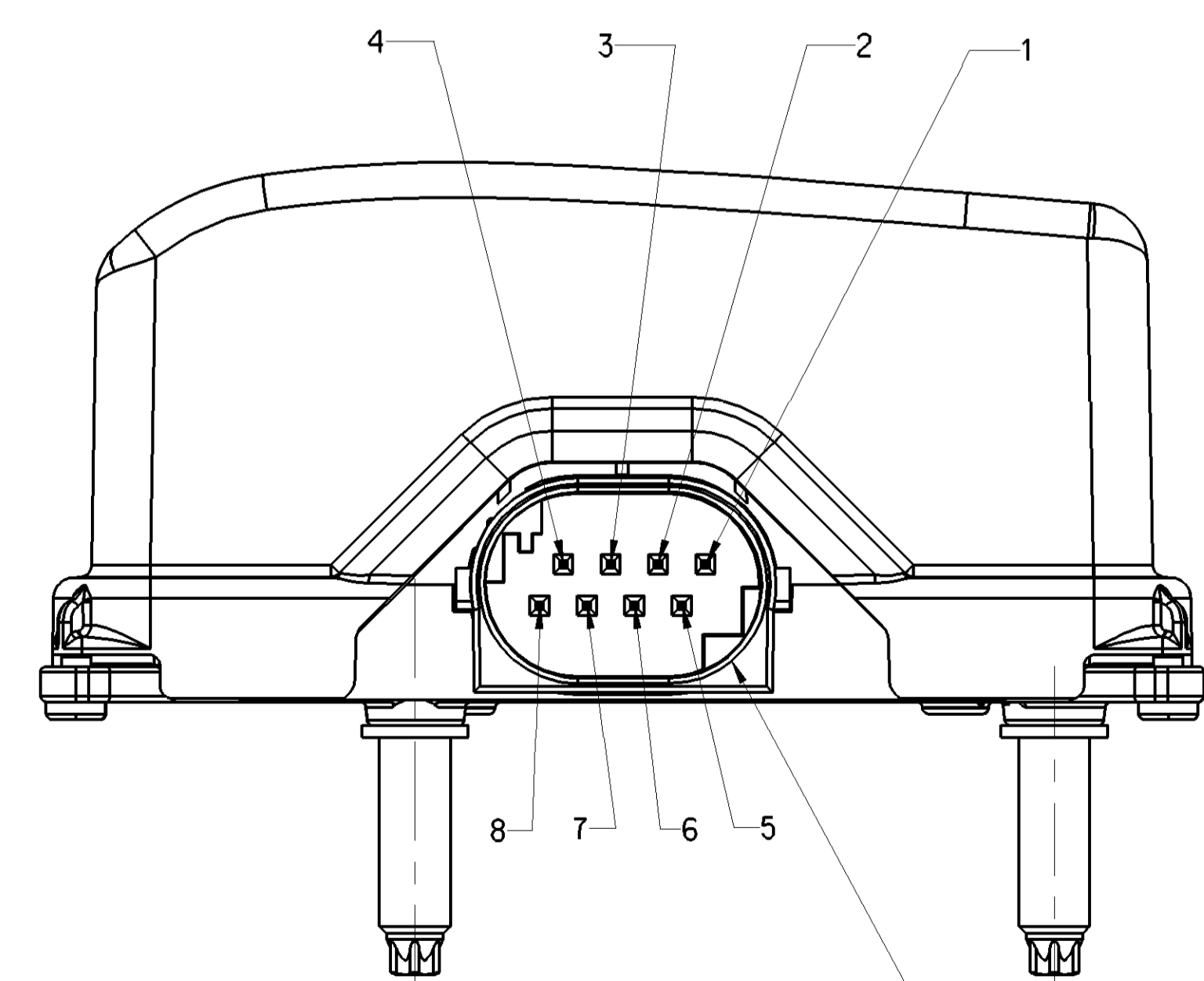
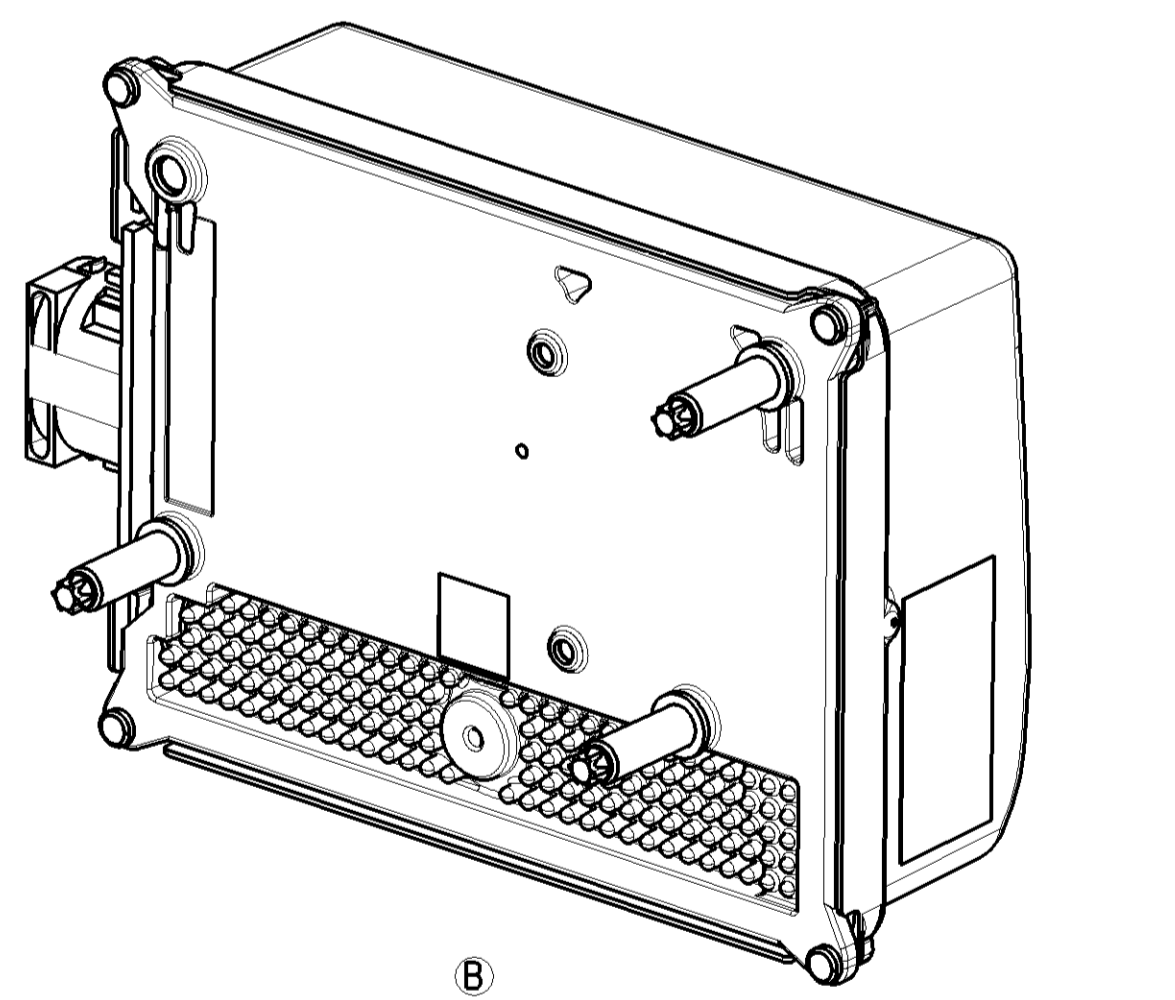

VIEW IN DIRECTION OF
 ARROW B
 SCALE 2:1

SHROUDED CONNECTOR 8-POLE
 ACC. TO AMP-NO.114-18063-034 CODING A;
 DO NOT TOUCH THE PINS

NR.	BELEGUNG
NO.	PINNING
1	UBATT
2	LINE WAKE
3	CAN 1 HIGH
4	CAN 0 LOW
5	LOAD
6	CAN 1 LOW
7	CAN 0 HIGH
8	GROUND

DETAIL C
 SCALE 5:1

MATERIAL: ST 8.8, SURFACE ZnNi5m OR ZnNi8m
 STOP SURFACE OF MOUNTING STUD SHALL BE
 IN FULL CONTACT WITH HOLE COLLAR
 NUT, BRACKET AND MOUNTING STUD SHALL BE
 ASSEMBLED FREE OF CLEARANCE.
 USE OF A LOCK NUT IS MANDATORY.

WABCO P/N	PARAMETER SET	SPARTAN P/N	VEHICLE MODEL	MOUNTING HEIGHT	ENGINE	RETARDER	TRANSMISSION	ABS SW	BAUD	SW LEVEL	ACC	DISPLAY
400 871 402 0	400 871 402 0_084	4421 - NN2 - 004	NEWMAR: KINGAIRE	406 mm								
400 871 403 0	400 871 403 0_084	4421 - NN2 - 003	ENTEGR: CORNERSTONE, ANTHEM	451 mm								
400 871 404 0	400 871 404 0_084	4421 - NN2 - 007	NEWMAR: KINGAIRE	406 mm								
400 871 405 0	400 871 405 0_084	4421 - NN2 - 006	ENTEGR: CORNERSTONE, ANTHEM	451 mm								
400 871 453 0	400 871 453 0_084	4520 - NN2 - 003	ENTEGR: CORNERSTONE, ANTHEM NEWMAR: LONDAINAIRE, ESSEX, MOUNTAINAIRE, KINGAIRE	451 mm								
400 871 464 0	400 871 464 0_084	4520 - NN2 - 005	FORETRAVEL: REALM	737 mm								
400 871 465 0	400 871 465 0_084	4855 - NN2 - 001	ENTEGR: CORNERSTONE, ANTHEM NEWMAR: LONDAINAIRE, ESSEX, MOUNTAINAIRE, KINGAIRE	451 mm								
400 871 466 0	400 871 466 0_084	4855 - NN2 - 002	FORETRAVEL: REALM	737 mm								
400 871 473 0	400 871 473 0_084	5151 - NN2 - 001	ENTEGR: CORNERSTONE, ANTHEM NEWMAR: DUTCHSTAR, LONDAINAIRE, ESSEX, MOUNTAINAIRE, KINGAIRE	451 mm								
400 871 474 0	400 871 474 0_084	5151 - NN2 - 002	FORETRAVEL: REALM	737 mm								
400 871 482 0	400 871 482 0_084	5151 - NN2 - 003	NEWMAR: NEWAIRE	451 mm								
400 871 498 0	400 871 498 0_084	4520 - NN2 - 006	ENTEGR: CORNERSTONE, ANTHEM NEWMAR: LONDAINAIRE, ESSEX, MOUNTAINAIRE, KINGAIRE	451 mm								
400 871 499 0	400 871 499 0_084	4520 - NN2 - 007	FORETRAVEL: REALM	737 mm								

- NOTES:
- STORAGE TEMPERATURE: -50°C TO 105°C
 OPERATING TEMPERATURE: -40°C TO 85°C
 ONLY CAN COMMUNICATION: 85°C TO 95°C
 - DO NOT PAINT RADAR SENSOR.
 - THE ORIENTATION OF THE RADAR SHALL HAVE
 THE CONNECTOR POSITIONED ON THE
 DRIVER SIDE OF THE VEHICLE.
 - FASTENER TORQUE: 61-75 IN-LS.

THIRD ANGLE PROJECTION

General Specifications: 400-500-1, Size 150 16400 LP

Further Technical Data: Sheet 1 of 1

Doc. Code: 2021-06-28

Copyright WABCO

2021-06-28

2021-07-27

Chromabond

Murphy

WABCO

RADAR-OnGuard

SPARTAN

Class: 11

File: 0.5

Width: 3.0

Height: 1.0

Depth: 2.0

Scale: 1:1

Part No: 400 871 480 0

Doc. Code: 053

EN 1/1

Part No: 508399

Size: 35x

Weight: 6832g