

A ADHESIVE TO HAVE A MAXIMUM OVERHANG OF 0.25 BEYOND BRACKET PROFILE WHEN VIEWING AS BELOW.

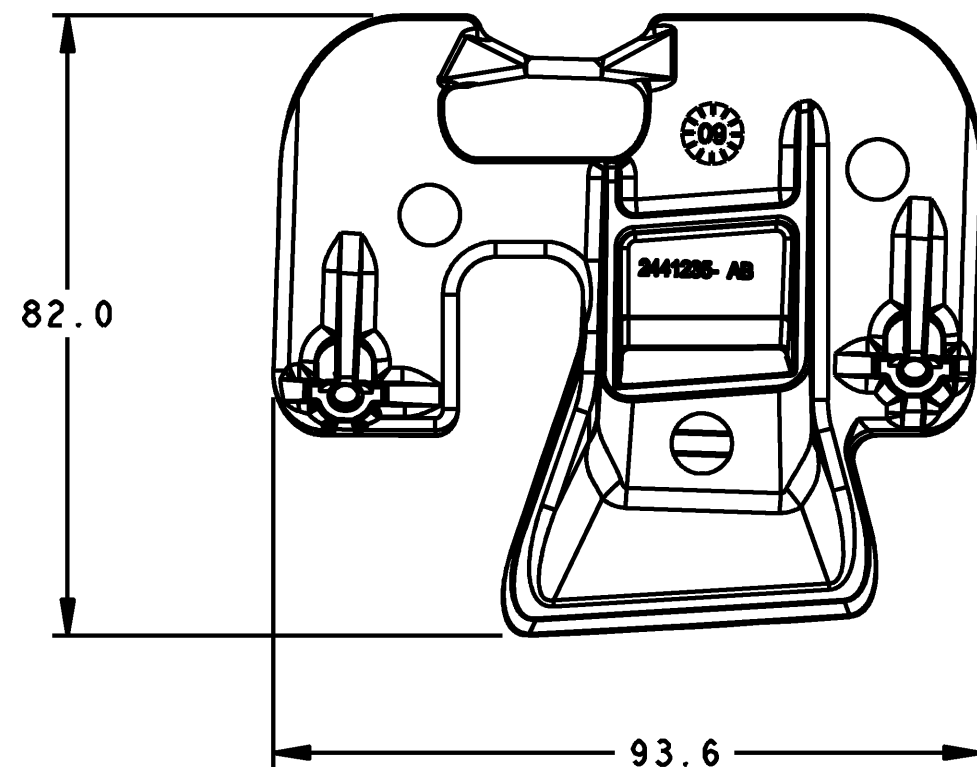

CLEAR POLY ADHESIVE LINER TO REMAIN INTACT ON THIS SIDE.

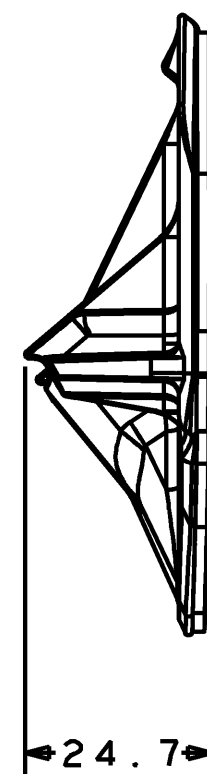

A
(1.0)

A
(0.5)

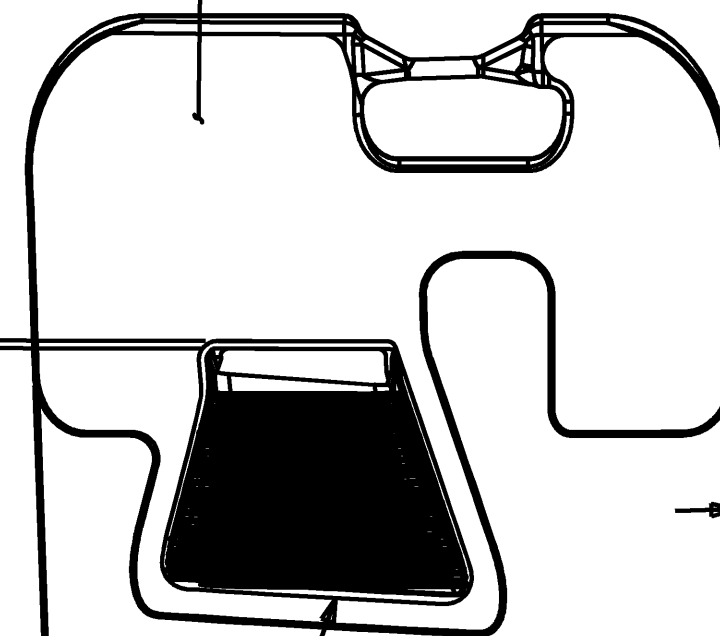

ENSURE THAT ADHESIVE CONTACTS METAL COMPLETELY AROUND PERIMETER OF OPENING.

APPLY ADHESION PROMOTER 2439895 TO CROSSHATCHED AREA OF BRACKET SURFACE.

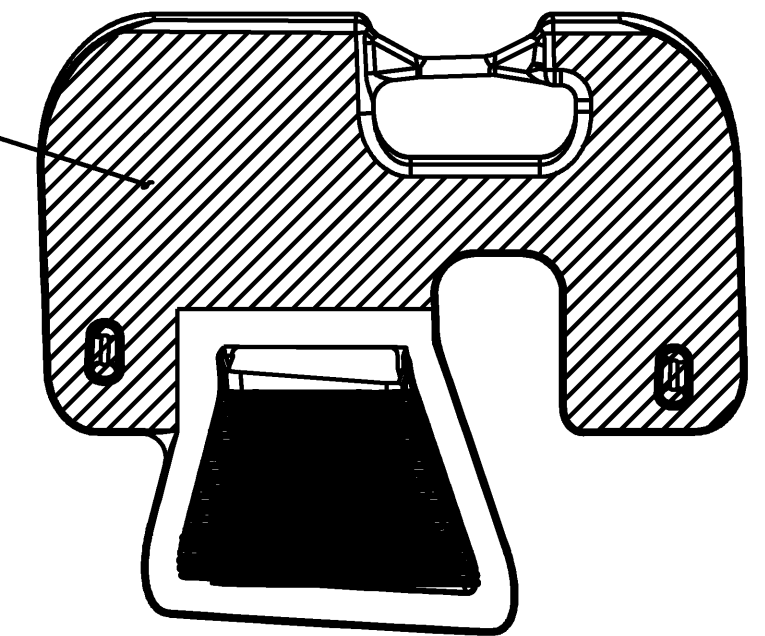

ADHESIVE REMOVED FROM VIEW

NOTE UNLESS OTHERWISE SPECIFIED:

1. ALL DIMENSIONS IN MILLIMETERS.
2. SEE UNIGRAPHICS CAD MODEL FOR ANY UNDEFINED GEOMETRY.
3. GENERAL TOLERANCES:
LINEAR - X.X = ± 0.3
- X.XX = ± 0.13
ANGULAR - $\pm 1^\circ$
4. PARTS SHALL BE FREE OF MOLD RELEASE, DIRT, GREASE, OIL, SALT RESIDUE, DETERGENTS AND OTHER PROCESSING CHEMICALS, FLASH, SINK, VOIDS, NICKS, SCRATCHES, TOOL MARKS, METAL FLAKES $> 0.13\text{MM}$ AND OTHER GENERAL CONTAMINANTS AND IMPERFECTIONS THAT MAY BE DETRIMENTAL TO PART FIT OR FUNCTION. (PERMISSIBLE: LESS THAN SIX METAL FLAKES $< 0.13\text{MM}$ ON INTERIOR SURFACES). PROCESSES ARE SUBJECT TO TK HOLDINGS, INC., ELECTRONICS ENGINEERING AUDIT OF THESE CHARACTERISTICS.
5. TRACEABILITY LABEL TO BE PLACED ON SHIPPING BAG.

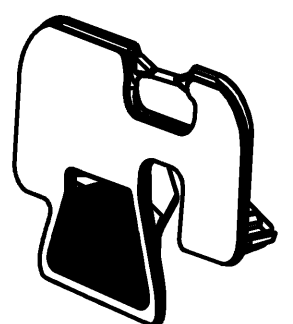
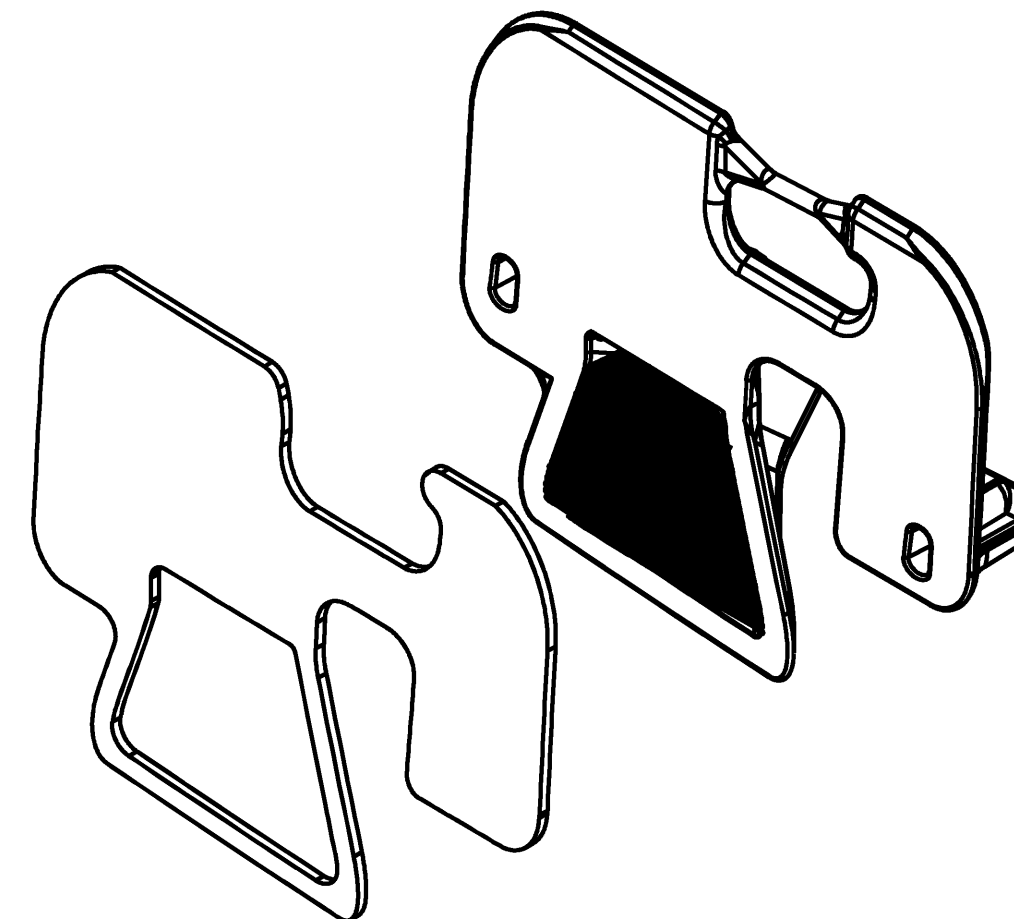

A

			SOLID MODEL DRAWING METRIC IN MM		MERITOR WABCO Vehicle Control Systems		
			DATE	SIGNATURE			
			DRAWN:				
			04/10/13		SUTTON		
			CHECKED:				
			04/12/13		BAPAT		
			RELEASE DATE:				
			04/12/13				
			MASS	SCALE	PRODUCT IDENTIFICATION NO.		
			KG	1.0	400 873 202 0		
			SIZE	T.R.I.	5511 005 1/1		
163988			1xA	02/20/14	DESIGN GROUP		
DCN-NO.			REV.	DATE	VDC		
					SHAPE CODE		
					REPLACEMENT FOR		
					EXPERT CODE		
					PRODUCT TYPE		