

MONTAGEBEDINGUNGEN
 BEFESTIGUNGSSCHRAUBEN: MB
 GUETEKLASSE: 10.9
 ANZIEHDREHMOMENT Mt: 30.0 Nm
 KOLBENBODENUNTERSTAND UNTER ZYLINDERBERKANTE: MIN. 0,1mm

BETRIEBSBEDINGUNGEN
 BETRIEBSDRUCK: P_{max} : 10 bar
 KUEHLWASSERDRUCK: P_{Wmax} : 2 bar
 KUEHLWASSERMENGE: Q_{Wmin} : 4 l/min

ANSCHLUESSE
 0 = SAUGANSCHLUSS
 2 = DRUCKANSCHLUSS
 91 = KUEHLWASSEREINTRITT
 92 = KUEHLWASSERAUSTRITT

EINZELHEIT X
 M 5:1

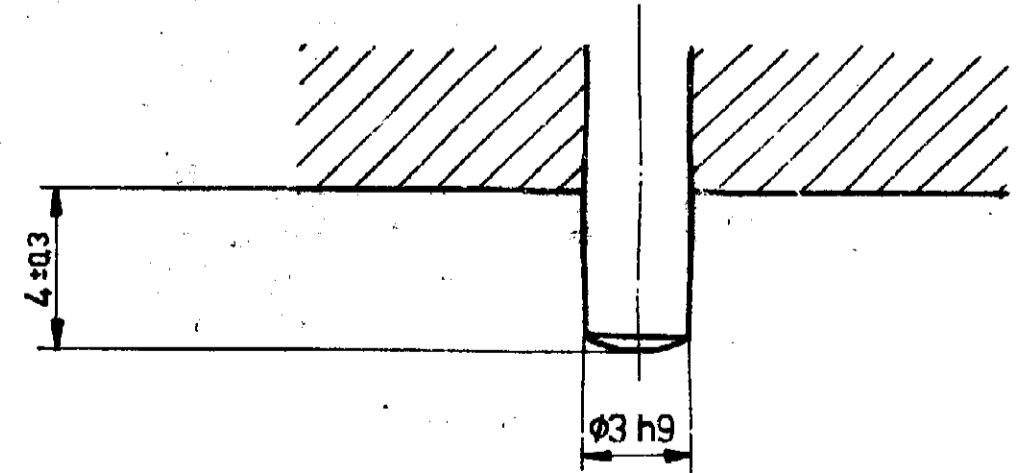

| | | | | | | | | | |
|---------|----------|----------|-----------|-----------------|----------------|---------------------|---------------|-----------------|-----------------|
| 061 091 | 92-03-06 | DATE | SIGNATURE | GENERAL SPEC | ALIGNMENT SPEC | SPL. GENERAL | SPEC. GENERAL | DRAWING NO. | REVISION NUMBER |
| 23 962 | 5 | 76-11-10 | Henger | | | | | WABCO | |
| 23 929 | 1 | 77-02-17 | Kaiser | | | | | | |
| 1 92 12 | 1 | 76-11-77 | Kaiser | | | | | | |
| 11 769 | 1 | 78-06-31 | Kaiser | | | | | | |
| | | | | STANDARDIZATION | | IDENTIFICATION CODE | | ZYLINDERKOPF | |
| | | | | DATE | SCALE | DRAWING NO. | | REVISION NUMBER | |
| | | | | 2.08 | 1:1 | 411 033 806 2 | | | |
| | | | | DATE | SCALE | DRAWING NO. | | REVISION NUMBER | |
| | | | | A1 | 140 | 605 | | | |