

BORE: BOHRUNG:	∅75 mm
STROKE: HUB:	36 mm
SWEPT VOLUME: HUBRAUM:	159 cm ³
MAX. WORKING SPEED: MAX. BETRIEBSDREHZAHL:	n _{max} = 3000 min ⁻¹
OVERSPEED (TEMPORARY MAX. 4 SEC.): UEBERDREHZAHL (KURZZEITIG MAX. 4 SEC.):	n _{ue} = 1.3 n _{max}
MAX. WORKING PRESSURE: MAX. BETRIEBSDRUCK:	p = 16 bar
SHORT TERM MAX. PRESSURE AT DISCHARGE PORT (TEMPORARILY ≤ 4 SEC.): KURZZEITIGER HOECHSTDRUCK AM DRUCKSTUTZEN (KURZZEITIG ≤ 4 SEC.):	p = 18 bar
WITH OIL COOLING; REQUIRED QUANTITY COOLING OIL: BEI OELKUEHLUNG; ERFORDERLICHE KUEHLOELMENGE:	6 l / min
END PLAY OF CRANKSHAFT: AXIALSPIEL DER KURBELWELLE:	0.2...0.6 mm
MAX. PERMISSIBLE TILT DURING CONTINUOUS WORKING: MAX. ZULAESSIGE NEIGUNG IM DAUERBETRIEB:	20° 20° 45° 15°
LUBRICATION; LUBRICATION SUPPLIED FROM ENGINE SCHMIERART; UMLAUFSCMIERUNG MIT DRUCKOELANSCHLUSS	

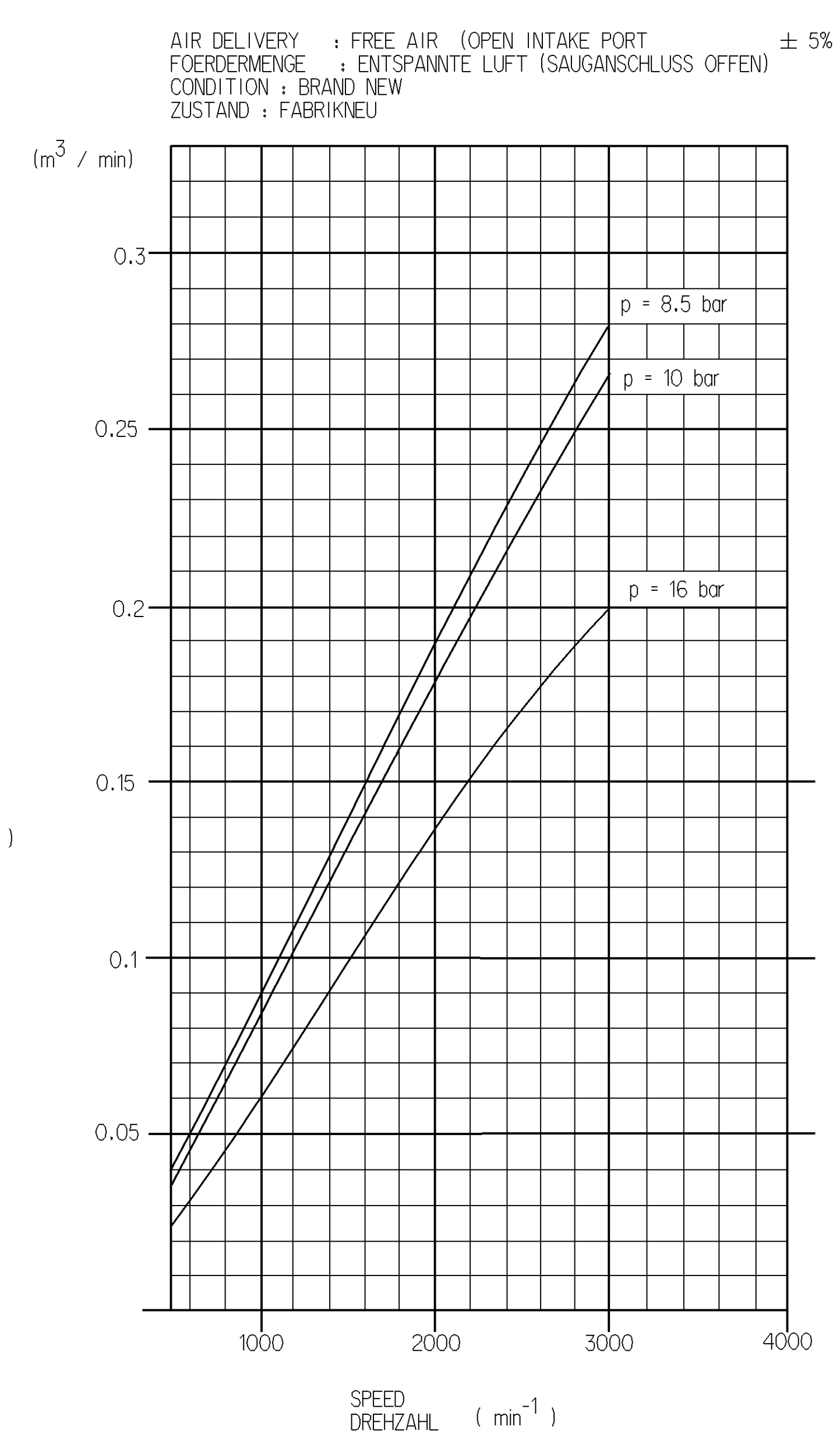

DRAWING VIEW W
ANSICHT

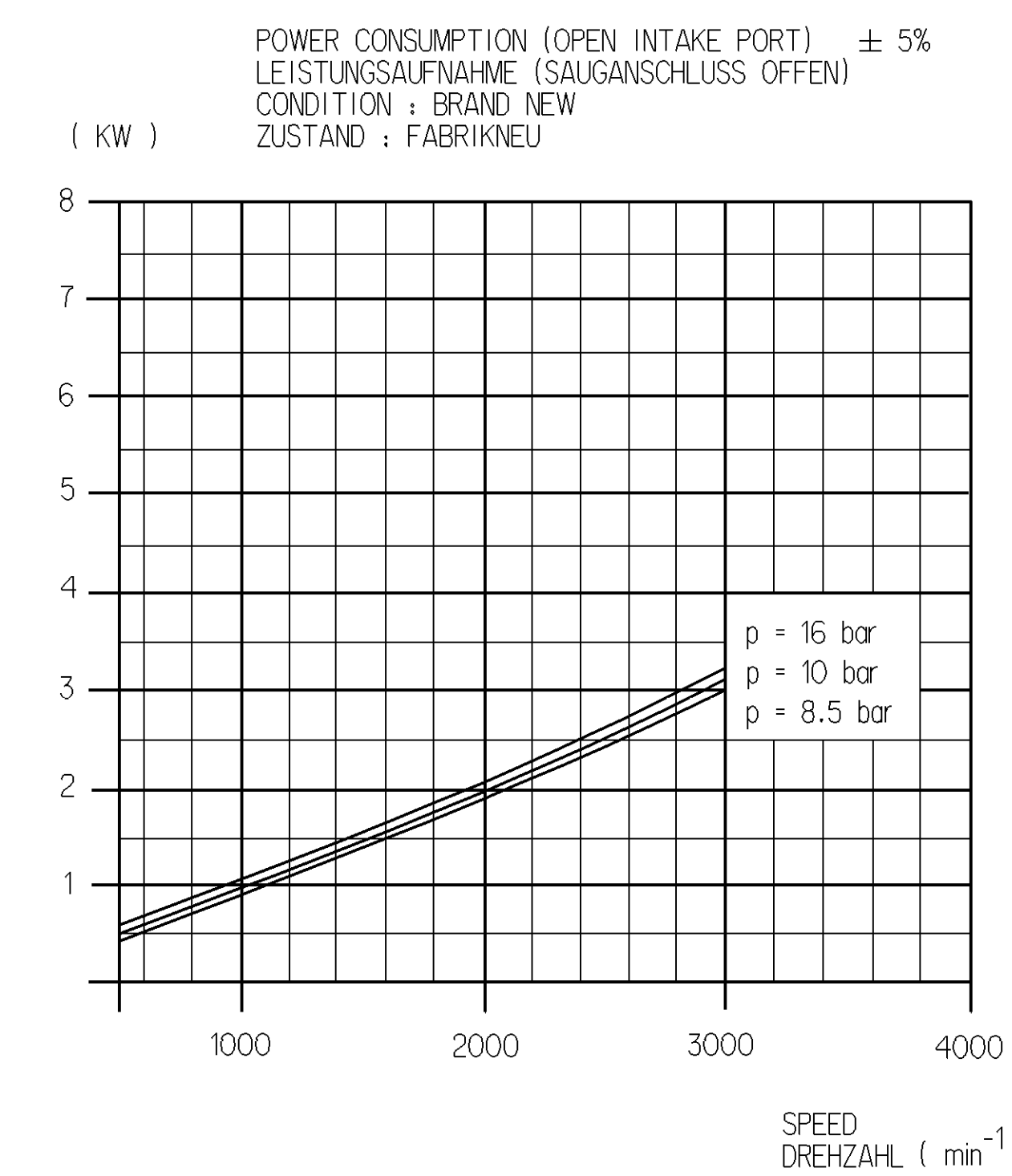
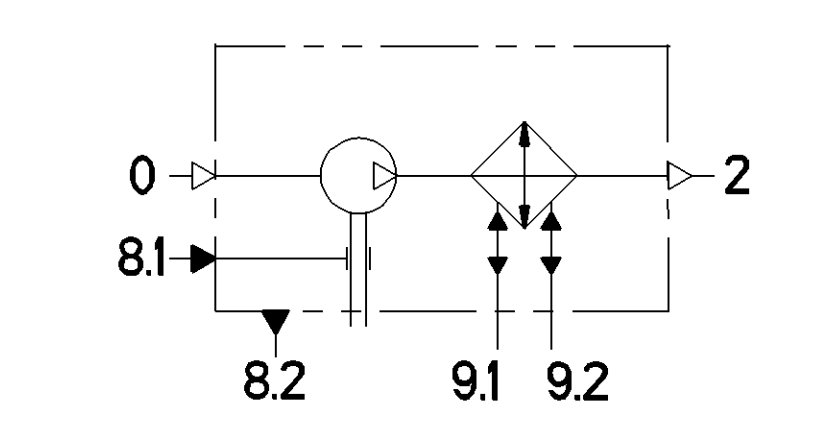
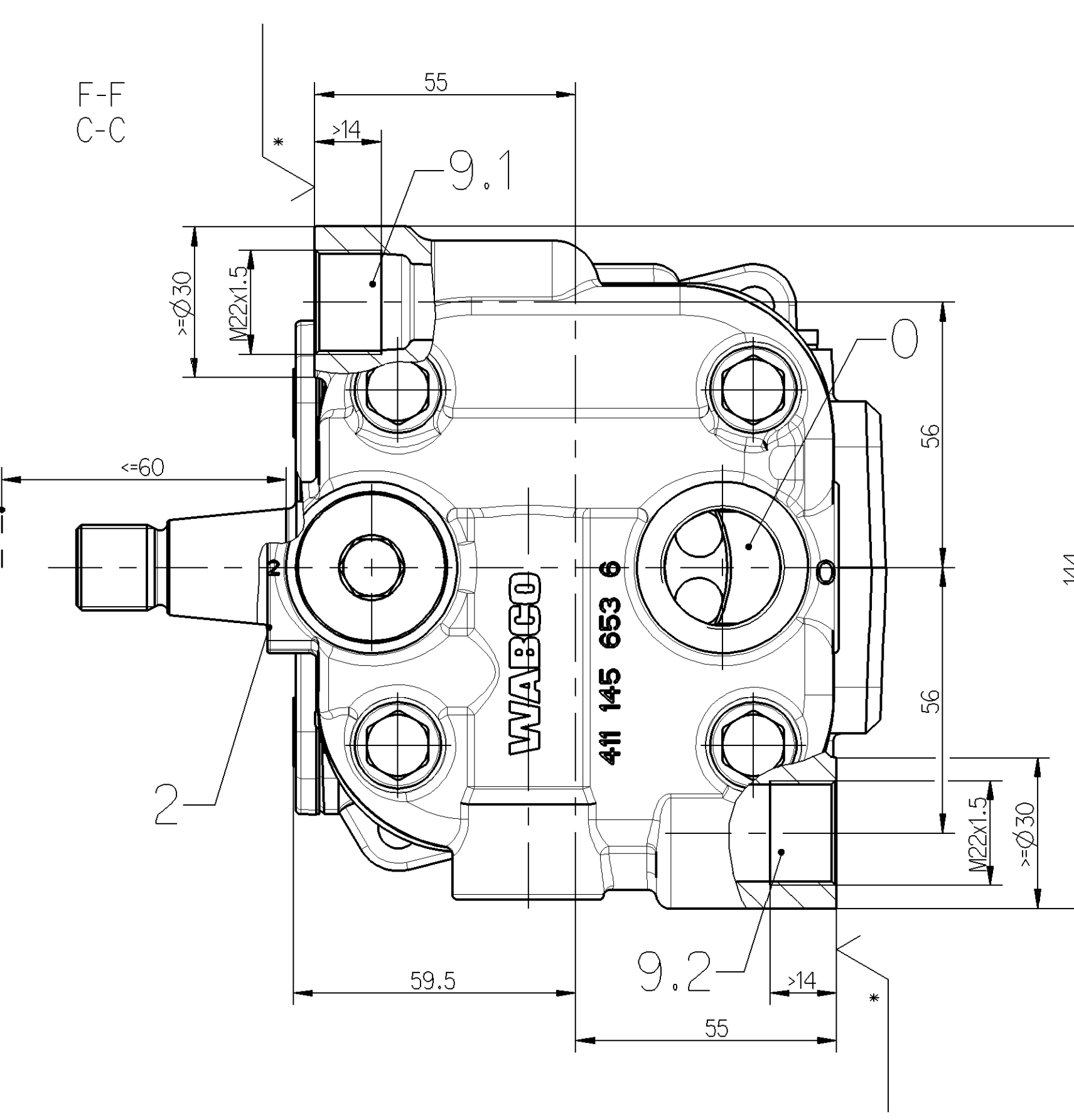
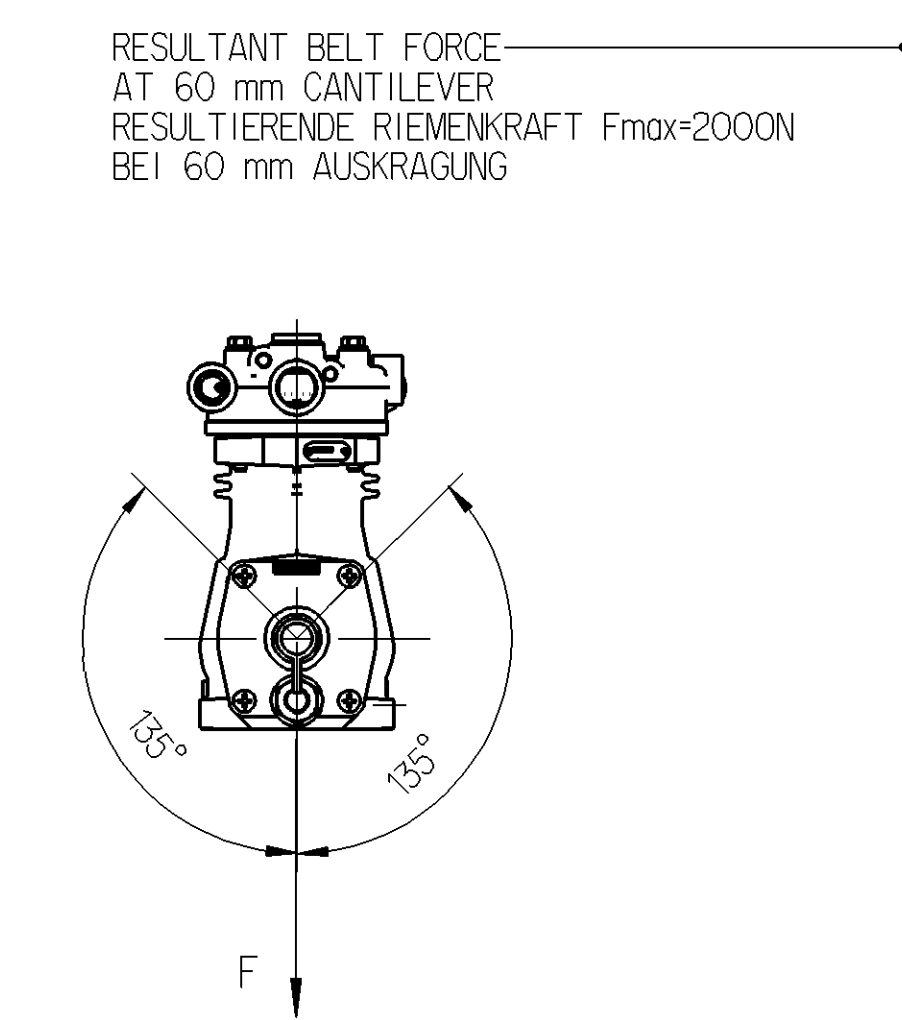
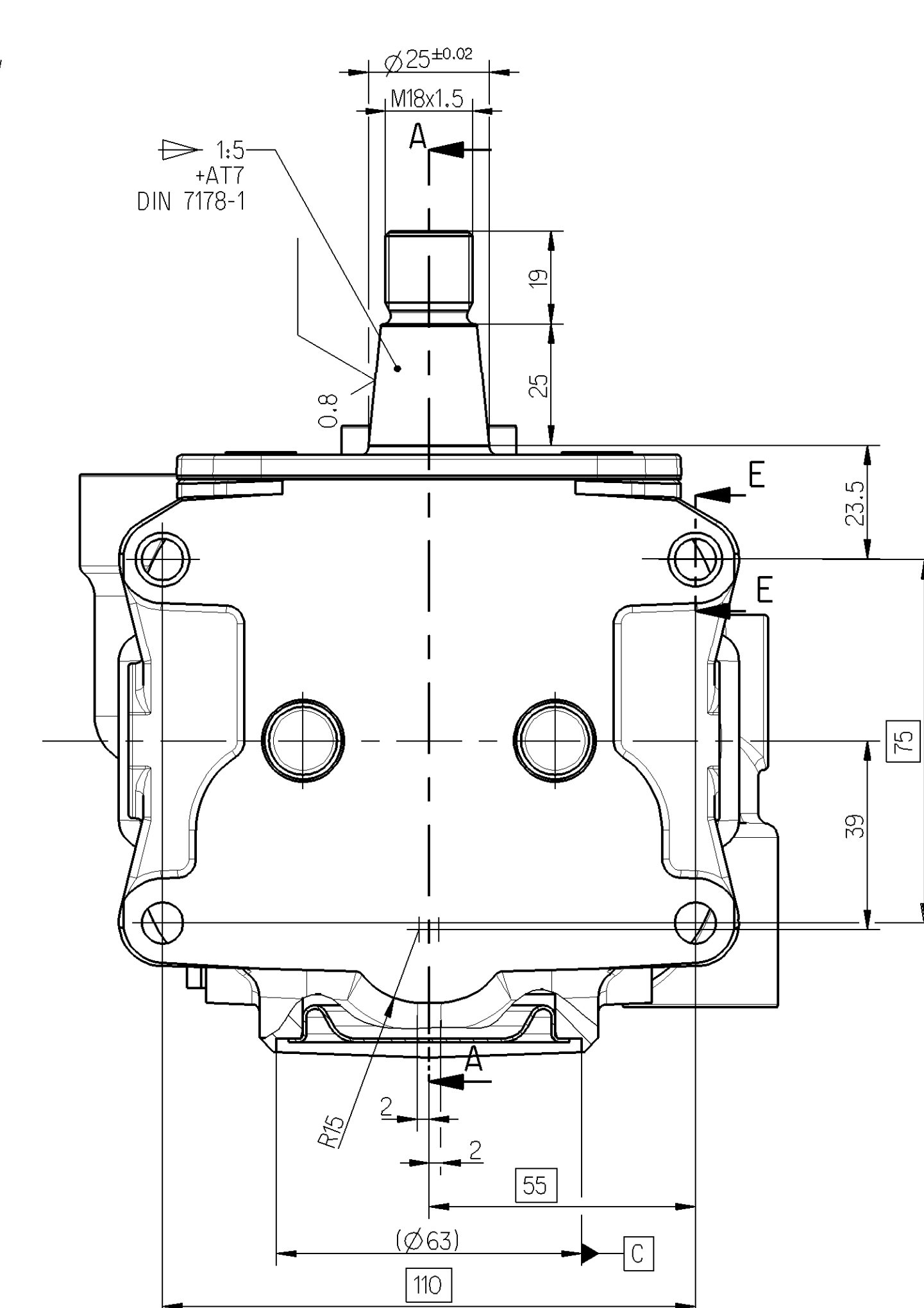

- 0 = INLET PORT
SAUGANSCHLUSS M= 100 Nm
- 2 = DISCHARGE PORT
DRUCKANSCHLUSS M= 100 Nm
- 8.1 = OIL SUPPLY
DRUCKOELANSCHLUSS M= 15 Nm
- 8.2 = OIL DRAIN
OELRUECKLAUF M= 60 Nm
- 9.1/9.2 = COOLANT CONNECTION
KUEHLWASSERANSCHLUSS M= 60 Nm
- 9.1 ↔ 9.2 DIRECTIONS OF FLOW
DURCHSTROMRICHTUNGEN

(...) AUXILIARY DIMENSION
HILFSSMASS

PORTS PROTECTED
ANSCHLUESSE GESCHUETZT

General Specification: ED-354-0	Copyright: WABCO	Material No.: 411 141 551 0	Code of 1st issue: 2012-09-19
Further Technical Data:	Sheet: 1 of 1	Doc. Code: 141551-0	Doc. Code: 141551-0
Drawn: 2012-09-19	Checked: 2012-09-19	Approved: 2012-09-19	Approved: 2012-09-19
Class: 11	± 0.10	± 0.05	± 0.05
Class: 12	± 0.10	± 0.05	± 0.05
Class: 13	± 0.10	± 0.05	± 0.05
Class: 14	± 0.10	± 0.05	± 0.05
Class: 15	± 0.10	± 0.05	± 0.05
Class: 16	± 0.10	± 0.05	± 0.05
Class: 17	± 0.10	± 0.05	± 0.05
Class: 18	± 0.10	± 0.05	± 0.05
Class: 19	± 0.10	± 0.05	± 0.05
Class: 20	± 0.10	± 0.05	± 0.05
Class: 21	± 0.10	± 0.05	± 0.05
Class: 22	± 0.10	± 0.05	± 0.05
Class: 23	± 0.10	± 0.05	± 0.05
Class: 24	± 0.10	± 0.05	± 0.05