

RESULTANT BELT FORCE AT 60 mm CANTILEVER
 RESULTIERENDE RIEMENKRAFT $F_{max}=2000N$ BEI 60 mm AUSKRAGUNG

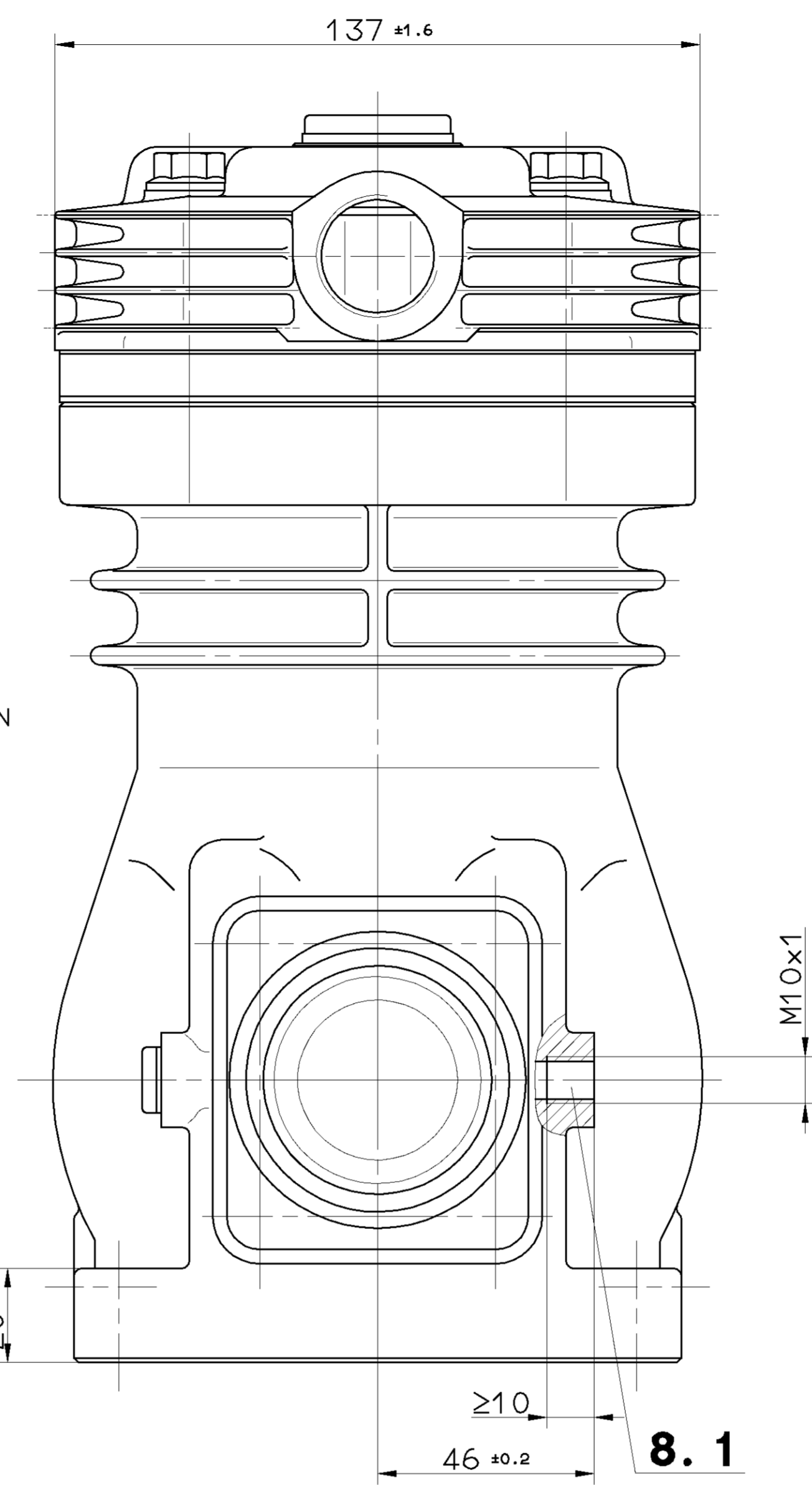
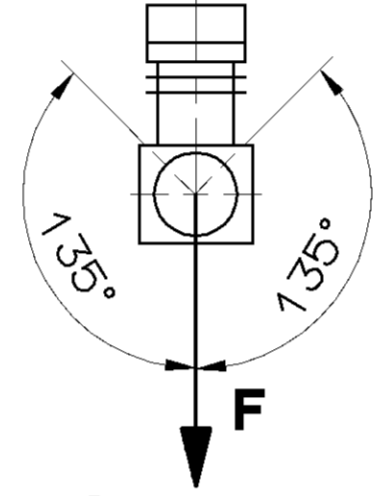

TECHNICAL DATA
 TECHNISCHE DATEN
 CARACTERISTIQUES TECHNIQUES
 CARATTERISTICHE TECNICHE

BORE: $\varnothing 90$ mm
 BOHRUNG:
 ALESAGE:
 ALESAGGIO:

STROKE: 46 mm
 HUB:
 COURSE:
 CORSA:

SWEPT VOLUME: 293 cm³
 HUBRAUM:
 CYLINDREE:
 CYLINDRATA:

MAX. WORKING SPEED: $n_{max} = 3000 \frac{1}{min}$
 MAX. BETRIEBSDREHZAHL:
 VITESSE D'UTILISATION MAXI.:
 VELOCITA DI ESERCIZIO MAX.:

OVERSPEED (TEMPORARY MAX. 4 SEC.): $n_{tr} = 1.3 \times n_{max}$
 UEBERDREHZAHL (KURZZEITIG MAX. 4 SEC.):
 SURVITESSE (DE' COURTE DUREE MAXI. 4 SEC.):
 SOVRAVELOCITA (BREVE TEMPO SOLO MAX. 4 SEC.):

MAX. WORKING PRESSURE: $p_e = 10$ bar
 MAX. BETRIEBSDRUCK:
 PRESSION D'UTILISATION MAXI.:
 PRESSIONE DI ESERCIZIO MAX.:

LUBRICATION: LUBRICATION SUPPLIED FROM ENGINE
 SCHMIERART: UMLAUFSCHMIERUNG MIT DRUCKOELANSCHLUSS (UD)
 GRAISSAGE: GRAISSAGE PAR CIRCULATION ALIMENTATION PAR LE MOTEUR
 LUBRIFICAZIONE: LUBRIFICAZIONE A CIRCOLAZIONE ALIMENTAZIONE DAL MOTORE

PERFORMANCE DIAGRAM: 411 143 000 0 (997)
 LEISTUNGSDIAGRAMM:
 DIAGRAMME DE PUISSANCE:
 DIAGRAMMA DI POTENZA:

REQUIRED COOLING AIR SPEED: 6m/s
 ERFORDERLICHE KUEHLLUFTGESCHWINDIGKEIT:
 VITESSE DE VENTILATION NECESSAIRE:
 VELOCITA DI VENTILAZIONE NECESSARIA:

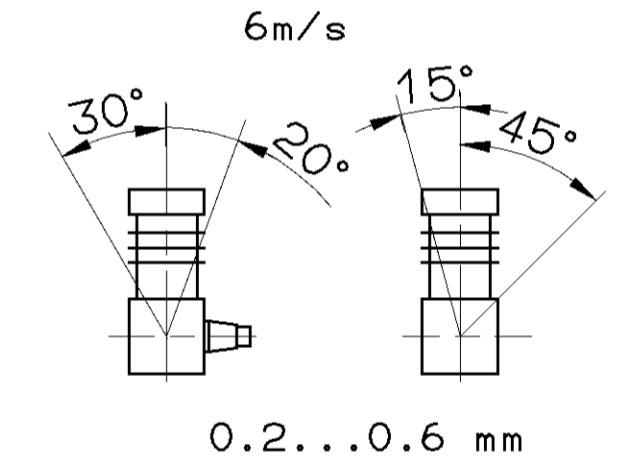

MAX. PERMISSIBLE TILT: 0.2...0.6 mm
 MAX. ZULAESSIGE EINBAUNEIGUNG:
 INCLINAISON ADMISSIBLE MAXI.:
 INCLINAZIONE AMMISSIBILE MASS.:

END PLAY OF CRANKSHAFT: 0.2...0.6 mm
 AXIALSPIEL DER KURBELWELLE:
 JEU AXIAL DU VILEBREQUIN:
 GIOCO ASSIALE DELL'ALBERO A GOMITO:

MAX. PERMISSIBLE PRESSURE TEMPERATURE IN SERVICE: 220°
 MAX. ZULAESSIGE DRUCKSTUTZENTEMPORATUR WAERHEND DES FAHRBETRIEBES 220°
 TEMPERATURE MAX. ADMISSIBLE EN SERVICE
 TEMPERATURA MAX. AMMISSIBILE IN SERVIZIO

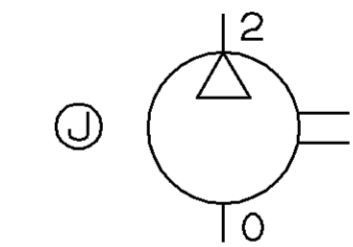

FREE FROM ASBESTOS
 ASBESTFREI
 EXEMPT D'AMIANTE
 ESENTE D'AMIANTO

- 0 = INLET PORT SAUGANSCHLUSS M ≤ 100 Nm ASPIRATION ASPIRAZIONE
- 2 = DISCHARGE PORT DRUCKANSCHLUSS M ≤ 100 Nm REFOULEMENT COMPRESSIONE
- 8.1 = OIL SUPPLY DRUCKOELANSCHLUSS M ≤ 25 Nm ORIFICE D'ARRIVEE D'HUILE ORIFIZIO D'ARRICO OLIO
- 8.2 = OIL DRAIN OELRUECKLAUF RETOUR D'HUILE RETORNO OLIO

TORQUE OF BELT PULLEY NUT
 ANZUGSMOMENT DER RIEMENSCHIBENMUTTER=100±10Nm
 COUPLE DE SERRAGE DE L'ECROU DE LA POUILLIE
 COPPIA DI SERRAGGIO DEL DADO DELLA PULEGGIA

TUTTE LE INFORMAZIONI DI REPRODUZIONE DI QUESTO DOCUMENTO, IN TUTTI I MEDI, SONO CONSIDERATE IL BENEFICIO DI UNO DEI SERVIZI DI REPRODUZIONE...
 ALL RIGHTS RESERVED. NO PART OF THIS DOCUMENT MAY BE REPRODUCED OR TRANSMITTED IN ANY FORM OR BY ANY MEANS, ELECTRONIC OR MECHANICAL, INCLUDING PHOTOCOPYING, RECORDING, OR BY ANY INFORMATION STORAGE AND RETRIEVAL SYSTEM, WITHOUT PERMISSION IN WRITING FROM WABCO.

GENERAL SPECIFICATION: JED-034		CAD/CAM DRAWING COPYRIGHT: WABCO	
FURTHER TECHNICAL DATA: SHEET: TO		DATE: 85-04-11 DRAWN: DUSCHEK	
GENERAL TOLERANCES		CHECKED: GELSE	
RANGE OF NOMINAL DIMENSIONS (± mm)		STANDARDIZATION: SOMMER	
CLASS	1)	≤50	51-180
		181-400	401-1000
		1000-2000	>2000
FINE	X	0,5	1,0
MEDIUM		1,0	2,0
COARSE		2,0	3,0
TAPPED HOLES ACC. ISO 4039 / JED-162		99993 85-04-11	
1) TOLERANCE CLASS APPLIED CROSSMARKED		DATE: 85-04-11	
SCALE: 1:1		PRODUCT IDENTIFICATION NO. 411 143 805 0	
SHEET: 1/1		REPLACEMENT FOR 411 143 805 0 OF 79-02-28	
DATE: 85-04-11		SHAPE CODE: 411 143 805 0 OF 79-02-28	
REV.:		EXPERT CODE: 7113	
DATE:		PRODUCT TYPE: 000	