

WORKING MEDIUM BETRIEBSMEDIUM :	AIR LUFT
COOLANT KUEHLMEDIUM :	WATER WITH ANTIFREEZE WASSER MIT FROSTSCHUTZ
BORE BOHRUNG :	Ø 85 mm
STROKE HUB :	62mm
SWEPT VOLUME HUBRAUM :	352 cm <sup>3</sup>
MAX. WORKING SPEED MAX. BETRIEBSDREHZAHL :	n <sub>max</sub> = 3000 min <sup>-1</sup>
OVERSPEED ( TEMPORARILY < 4 Sec. ) LEBERDREHZAH. ( KURZZEITIG < 4 Sek. ) :	n <sub>ue</sub> = 1.3 x n <sub>max</sub>
MAX. WORKING PRESSURE MAX. BETRIEBSDRUCK :	p <sub>e</sub> = 12.5 bar
MAX. PRESSURE HOECHSTDRUCK :	p <sub>e</sub> = 16 bar *

\* MEASURING POINT : DISCHARGE PORT  
MESSPUNKT : DRUCKANSCHLUSS

END PLAY OF CRANKSHAFT  
AXIALSPIEL DER KURBELWELLE : 0.05...0.35 mm

LUBRICATION : LUBRICATION SUPPLIED FROM ENGINE  
SCHMIERART : UMLAUFSCHEMUNG MIT DRUCKANSCHLUSS

FREE FROM ASBESTOS  
ASBESTFREI

PORTS PROTECTED  
ANSCHLUSSE GESCHUETZT

CRANKCASE : SURFACE PROTECTION JED-069M1 (OPTIONAL)  
KURBELGEHAEUSE : OBERFLAECHENSCHUTZ JED-069M1 (WAHLWEISE)

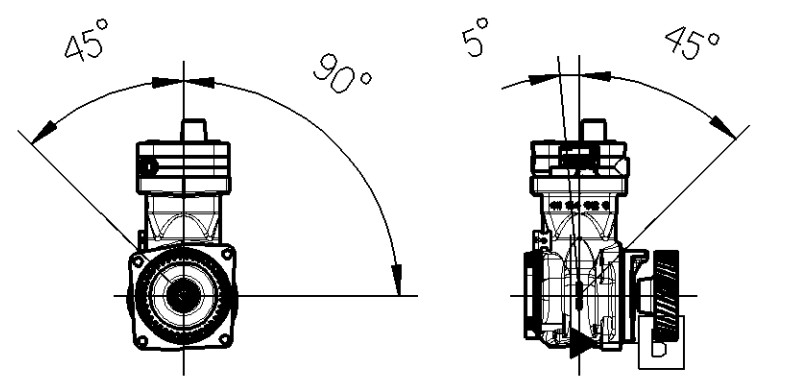

MAX. PERMISSIBLE TILT DURING CONTINUOUS WORKING  
MAX. ZULAESSIGE NEIGUNG IM DAUERBETRIEB

- 0 = INLET PORT  
SAUGANSCHLUSS
- 2 = DISCHARGE PORT  
DRUCKANSCHLUSS M : < 100 Nm
- 81 = OIL SUPPLY  
DRUCKOELANSCHLUSS
- 82 = OIL DRAIN  
OELRUECKLAUF
- 91 = COOLANT CONNECTION  
KUEHLMITTELANSCHLUSS M : ≈ 35 Nm
- 92 = DIRECTIONS OF FLOW  
DURCHSTROMRICHTUNGEN

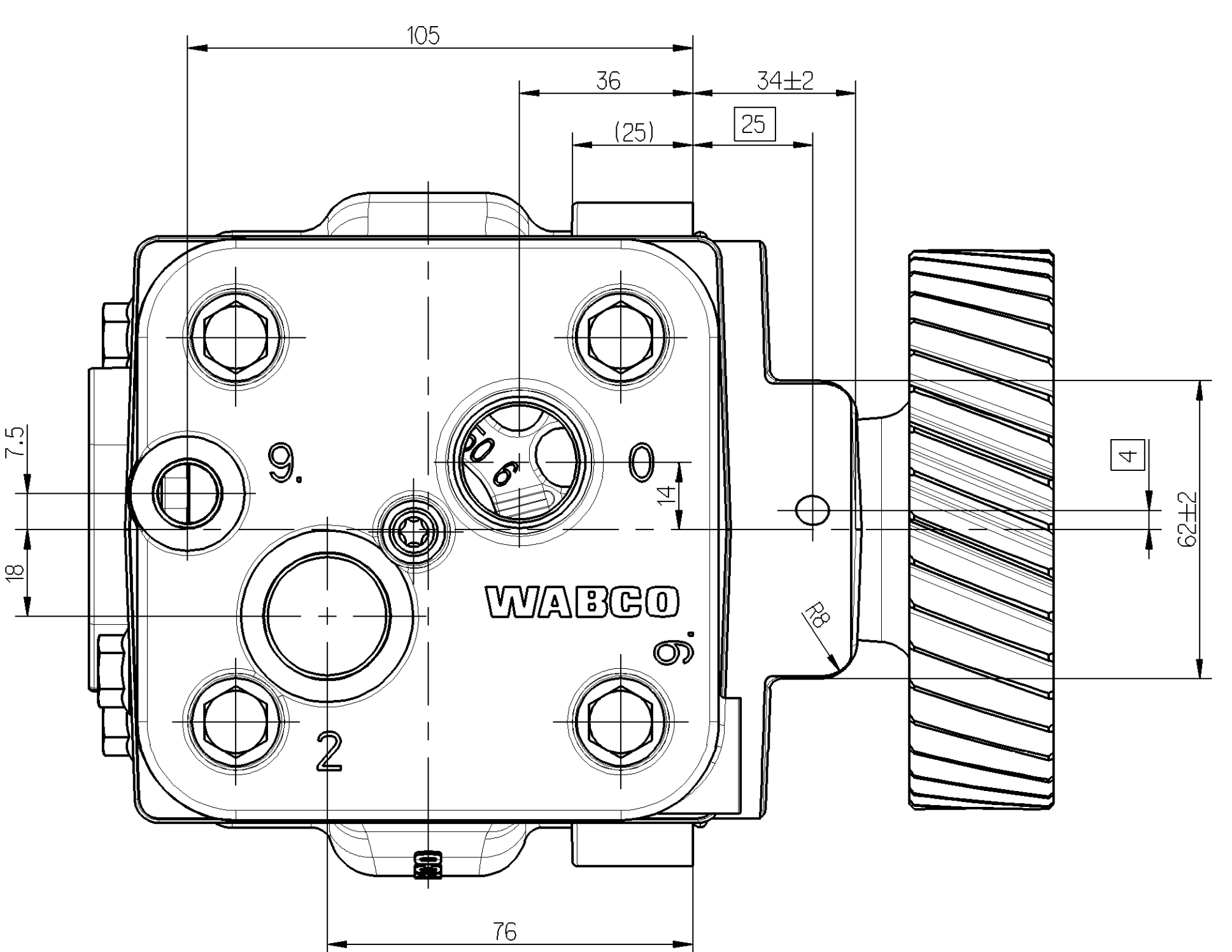
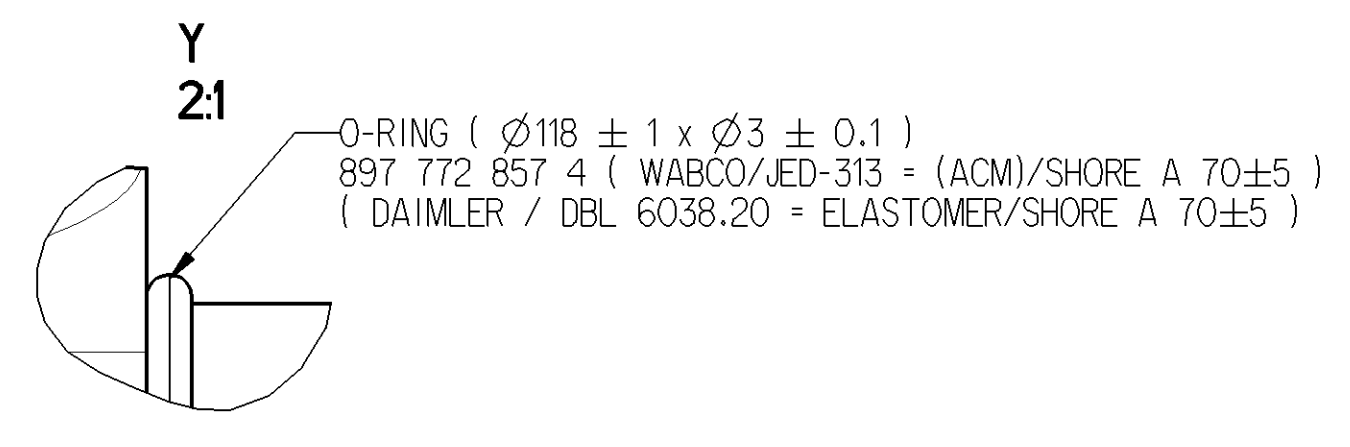
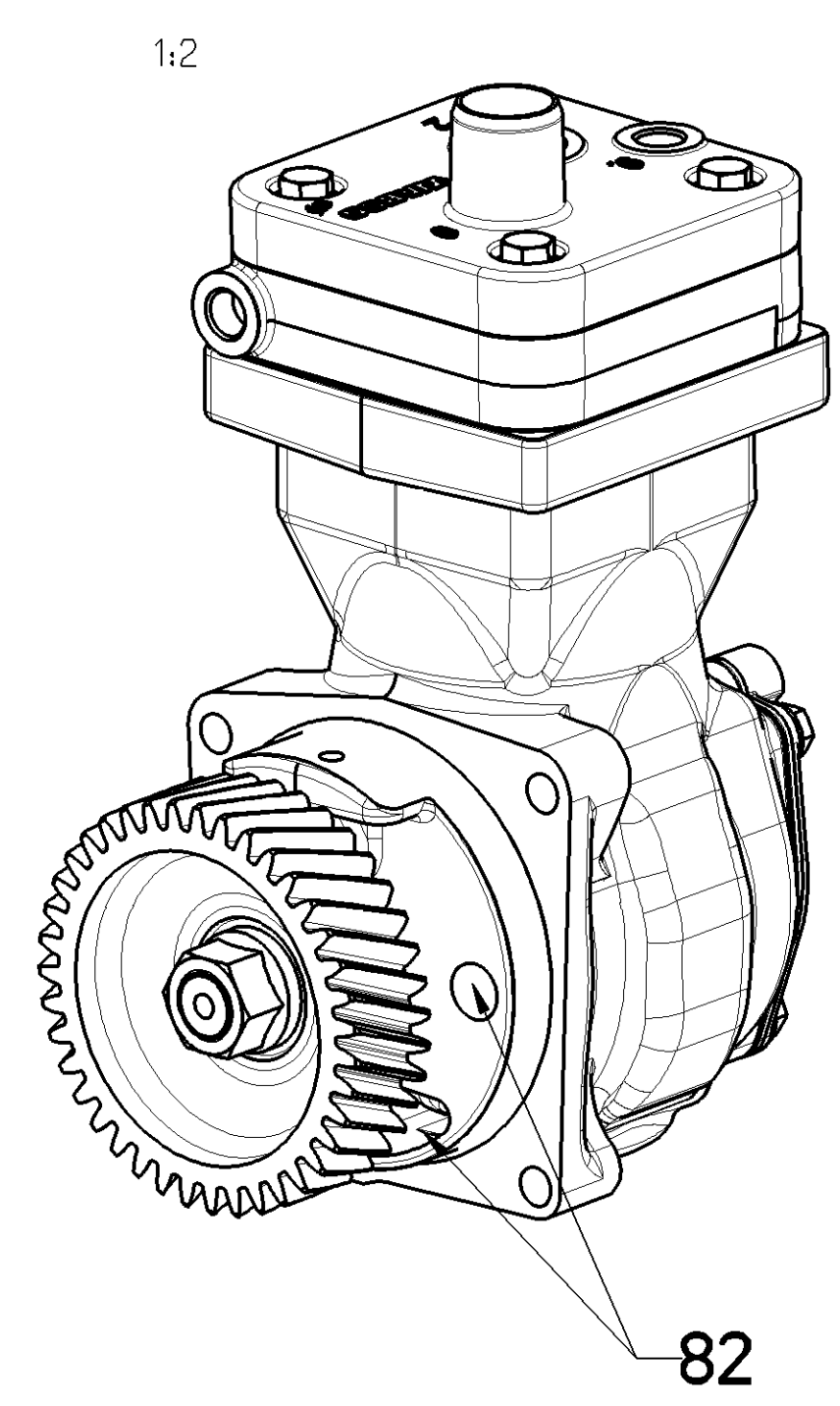

CLEANLINESS OF PARTS AND DEVICES: JED-593 ( SPECIFICATION T.B.D. )  
SAUBERKEIT VON GERAETEN UND TEILEN:

(FINAL DEFINITION AFTER INVESTIGATION WITH SUPPLIER MANAGEMENT CUSTOMER AND WABCO)  
(ENTGUELTIGE FESTLEGUNG NACH ERFOLGTEM UNTERSUCHUNGEN MIT DEM LIEFERANTENMANAGEMENT VOM KUNDEN UND WABCO)

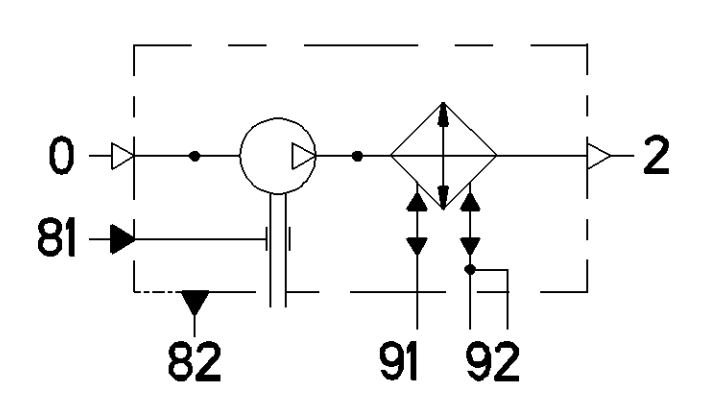
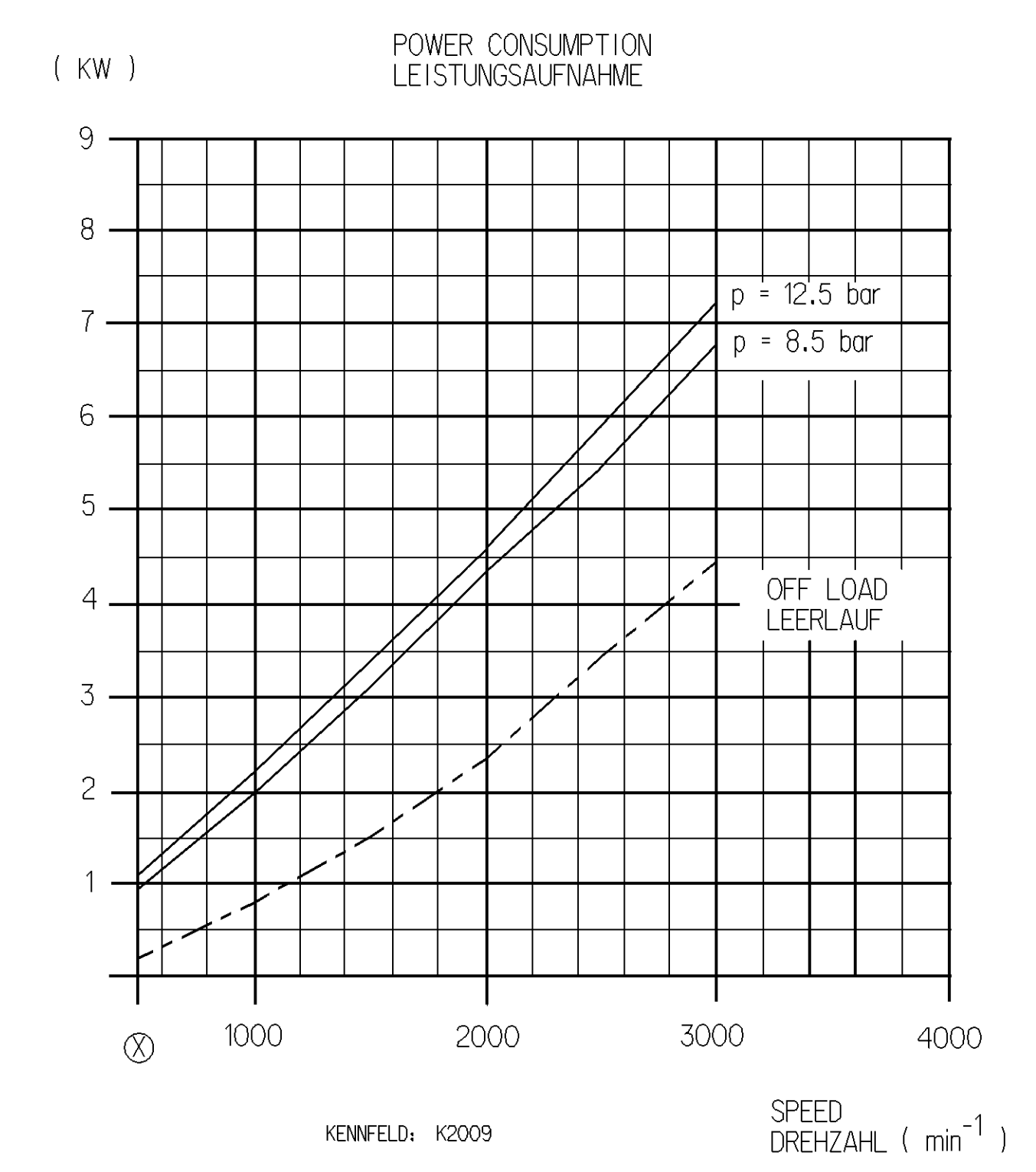
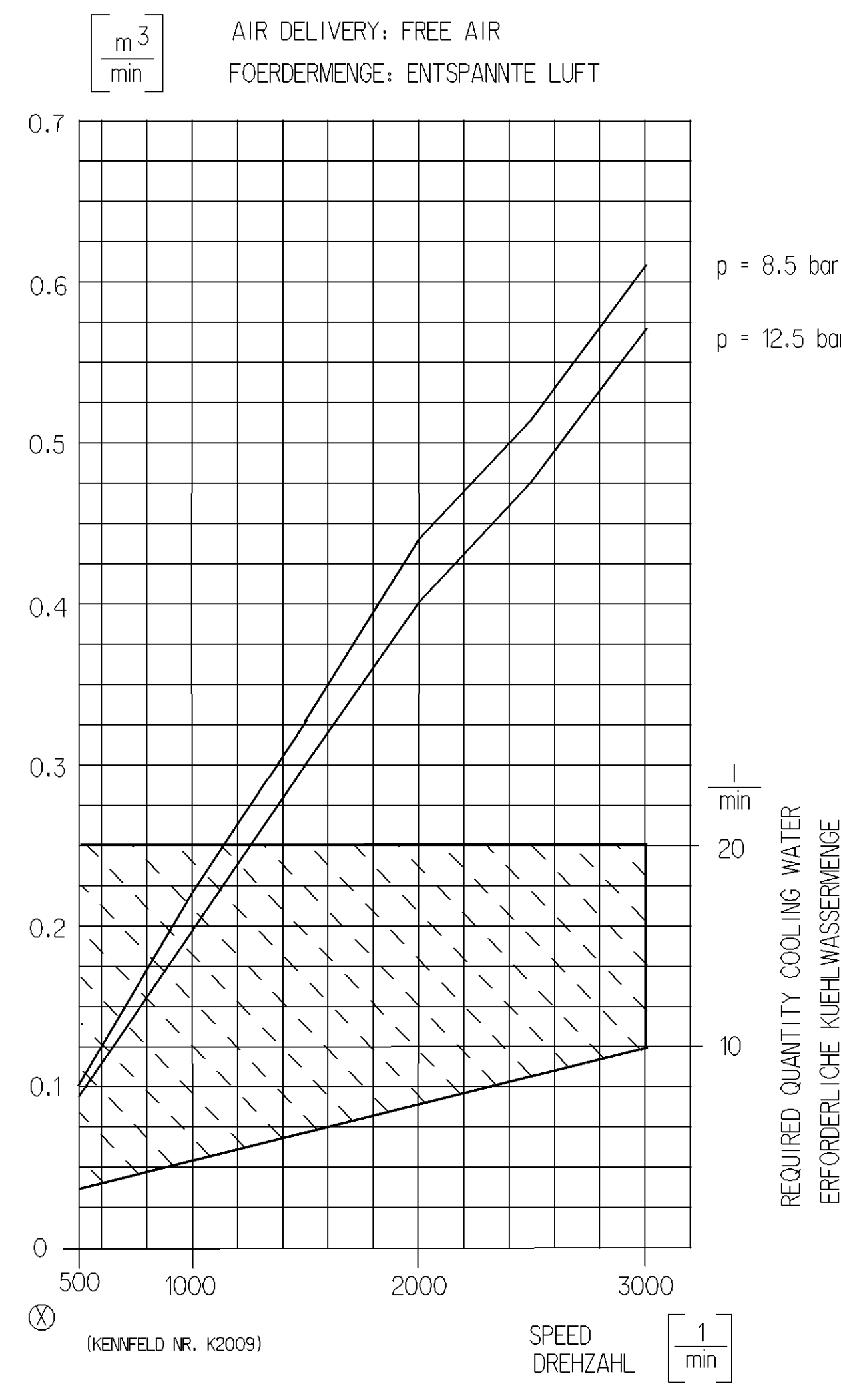

(...) AUXILIARY DIMENSION  
HILFSSMASS

General Specification: JED-354-0	Copyright WABCO	<b>WABCO</b>
Further Technical Data: 411 154 000 0	Date: 2010-09-30	Single Cylinder Compressor
Doc. Code: 538	Drawn: JLS To: S/L3	Einzylinder Kompressor
General Tolerances: JED-201	Checked: Burs	Compresseur Monocylindrique
Range of Nominal Dimensions (d, mm)	Drawn: JLS	Compressore Monocilindrico
Class 11 ± 0.10	Class 12 ± 0.05	
Class 12 ± 0.05	Class 13 ± 0.03	
Class 13 ± 0.03	Class 14 ± 0.02	
Class 14 ± 0.02	Class 15 ± 0.01	
Class 15 ± 0.01	Class 16 ± 0.005	
Class 16 ± 0.005	Class 17 ± 0.002	
Class 17 ± 0.002	Class 18 ± 0.001	
Class 18 ± 0.001	Class 19 ± 0.0005	
Class 19 ± 0.0005	Class 20 ± 0.0002	
Class 20 ± 0.0002	Class 21 ± 0.0001	
Class 21 ± 0.0001	Class 22 ± 0.00005	
Class 22 ± 0.00005	Class 23 ± 0.00002	
Class 23 ± 0.00002	Class 24 ± 0.00001	
Class 24 ± 0.00001	Class 25 ± 0.000005	
Class 25 ± 0.000005	Class 26 ± 0.000002	
Class 26 ± 0.000002	Class 27 ± 0.000001	
Class 27 ± 0.000001	Class 28 ± 0.0000005	
Class 28 ± 0.0000005	Class 29 ± 0.0000002	
Class 29 ± 0.0000002	Class 30 ± 0.0000001	
Class 30 ± 0.0000001	Class 31 ± 0.00000005	
Class 31 ± 0.00000005	Class 32 ± 0.00000002	
Class 32 ± 0.00000002	Class 33 ± 0.00000001	
Class 33 ± 0.00000001	Class 34 ± 0.000000005	
Class 34 ± 0.000000005	Class 35 ± 0.000000002	
Class 35 ± 0.000000002	Class 36 ± 0.000000001	
Class 36 ± 0.000000001	Class 37 ± 0.0000000005	
Class 37 ± 0.0000000005	Class 38 ± 0.0000000002	
Class 38 ± 0.0000000002	Class 39 ± 0.0000000001	
Class 39 ± 0.0000000001	Class 40 ± 0.00000000005	
Class 40 ± 0.00000000005	Class 41 ± 0.00000000002	
Class 41 ± 0.00000000002	Class 42 ± 0.00000000001	
Class 42 ± 0.00000000001	Class 43 ± 0.000000000005	
Class 43 ± 0.000000000005	Class 44 ± 0.000000000002	
Class 44 ± 0.000000000002	Class 45 ± 0.000000000001	
Class 45 ± 0.000000000001	Class 46 ± 0.0000000000005	
Class 46 ± 0.0000000000005	Class 47 ± 0.0000000000002	
Class 47 ± 0.0000000000002	Class 48 ± 0.0000000000001	
Class 48 ± 0.0000000000001	Class 49 ± 0.00000000000005	
Class 49 ± 0.00000000000005	Class 50 ± 0.00000000000002	
Class 50 ± 0.00000000000002	Class 51 ± 0.00000000000001	
Class 51 ± 0.00000000000001	Class 52 ± 0.000000000000005	
Class 52 ± 0.000000000000005	Class 53 ± 0.000000000000002	
Class 53 ± 0.000000000000002	Class 54 ± 0.000000000000001	
Class 54 ± 0.000000000000001	Class 55 ± 0.0000000000000005	
Class 55 ± 0.0000000000000005	Class 56 ± 0.0000000000000002	
Class 56 ± 0.0000000000000002	Class 57 ± 0.0000000000000001	
Class 57 ± 0.0000000000000001	Class 58 ± 0.00000000000000005	
Class 58 ± 0.00000000000000005	Class 59 ± 0.00000000000000002	
Class 59 ± 0.00000000000000002	Class 60 ± 0.00000000000000001	
Class 60 ± 0.00000000000000001	Class 61 ± 0.000000000000000005	
Class 61 ± 0.000000000000000005	Class 62 ± 0.000000000000000002	
Class 62 ± 0.000000000000000002	Class 63 ± 0.000000000000000001	
Class 63 ± 0.000000000000000001	Class 64 ± 0.0000000000000000005	
Class 64 ± 0.0000000000000000005	Class 65 ± 0.0000000000000000002	
Class 65 ± 0.0000000000000000002	Class 66 ± 0.0000000000000000001	
Class 66 ± 0.0000000000000000001	Class 67 ± 0.00000000000000000005	
Class 67 ± 0.00000000000000000005	Class 68 ± 0.00000000000000000002	
Class 68 ± 0.00000000000000000002	Class 69 ± 0.00000000000000000001	
Class 69 ± 0.00000000000000000001	Class 70 ± 0.000000000000000000005	
Class 70 ± 0.000000000000000000005	Class 71 ± 0.000000000000000000002	
Class 71 ± 0.000000000000000000002	Class 72 ± 0.000000000000000000001	
Class 72 ± 0.000000000000000000001	Class 73 ± 0.0000000000000000000005	
Class 73 ± 0.0000000000000000000005	Class 74 ± 0.0000000000000000000002	
Class 74 ± 0.0000000000000000000002	Class 75 ± 0.0000000000000000000001	
Class 75 ± 0.0000000000000000000001	Class 76 ± 0.00000000000000000000005	
Class 76 ± 0.00000000000000000000005	Class 77 ± 0.00000000000000000000002	
Class 77 ± 0.00000000000000000000002	Class 78 ± 0.00000000000000000000001	
Class 78 ± 0.00000000000000000000001	Class 79 ± 0.000000000000000000000005	
Class 79 ± 0.000000000000000000000005	Class 80 ± 0.000000000000000000000002	
Class 80 ± 0.000000000000000000000002	Class 81 ± 0.000000000000000000000001	
Class 81 ± 0.000000000000000000000001	Class 82 ± 0.0000000000000000000000005	
Class 82 ± 0.0000000000000000000000005	Class 83 ± 0.0000000000000000000000002	
Class 83 ± 0.0000000000000000000000002	Class 84 ± 0.0000000000000000000000001	
Class 84 ± 0.0000000000000000000000001	Class 85 ± 0.00000000000000000000000005	
Class		