

Tous droits de propriété industrielle réservés. Reservati tutti i diritti in caso di concessione di brevetti o di registrazione di un modello di utilità. Alle Rechte für den Fall der Patenterteilung oder Gebrauchsmuster-Eintragung vorbehalten.

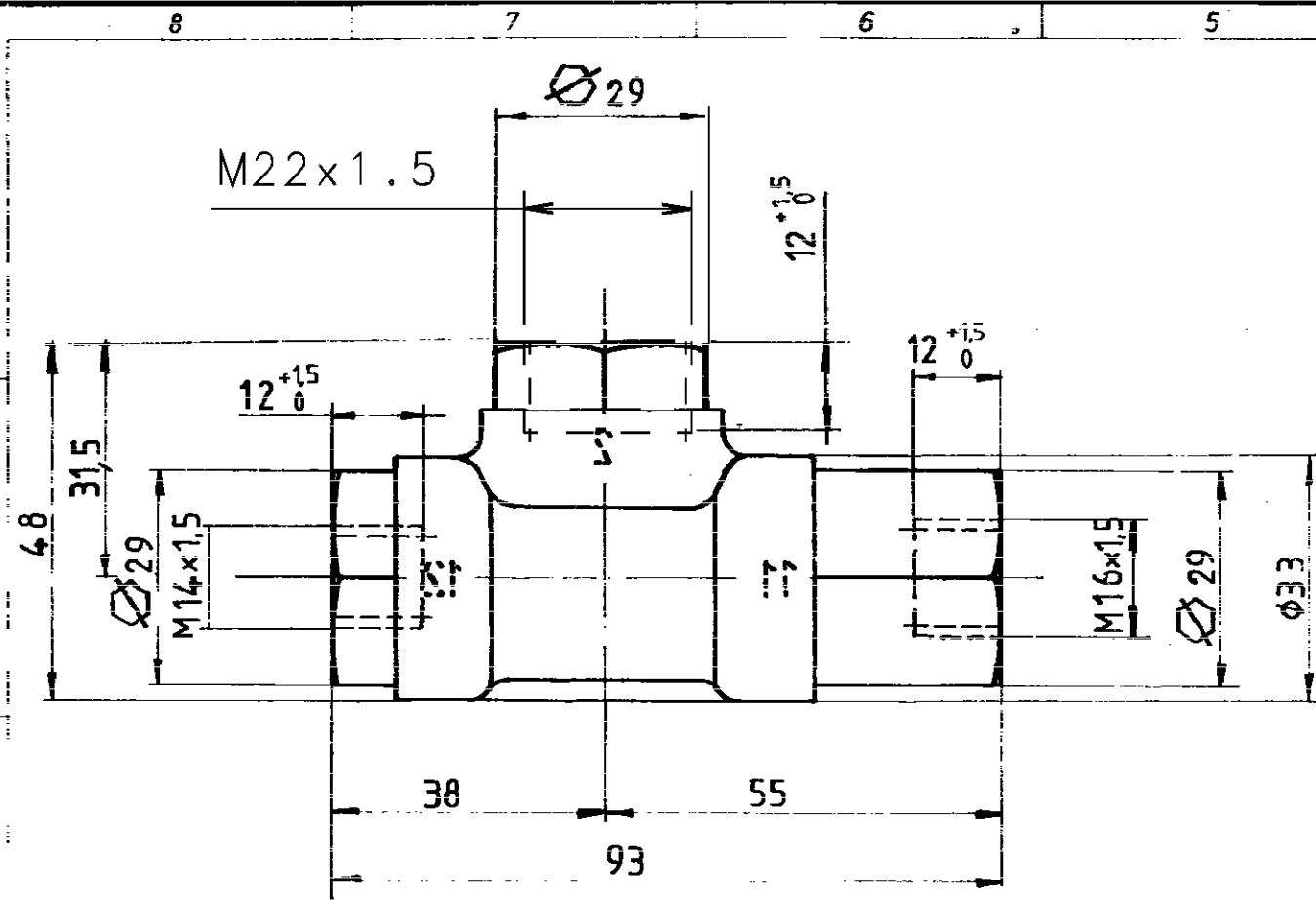

M22x1.5

11/12 INLET  
EINGANG  
ALIMENTATION  
ALIMENTAZIONE

2 OUTLET  
AUSGANG  
SORTIE  
USCITA

MAX. WORKING PRESSURE :  
MAX. BETRIEBSDRUCK :  
PRESSION D'UTILISATION MAXI. :  $P_e = 10\text{bar}$   
PRESSIONE DI ESERCIZIO MAX. :

THERMAL RANGE OF APPLICATION :  
THERM. ANWENDUNGSBEREICH :  
GAMME D'APPLICATION THERMIQUE :  $-40^\circ\text{C} \dots +80^\circ\text{C}$   
CAMPO DI APPLICAZIONE TERMICA :

INSTALLATION POSITION : OPTIONAL  
EINBAULAGE : BELIEBIG  
POSITION D'INSTALLATION : INDIFFERENT  
POSIZIONE DI MONTAGGIO : INDIFFERENTE

NOMINAL DIAMETER :  
NENNWEITE :  
DIAMETRE NOMINAL :  $\varnothing 10,5$   
DIAMETRO NOMINALE :

MEDIUM : AIR  
MEDIUM : LUFT  
FLUIDE : AIR  
FLUIDO : ARIA

WIRING DIAGRAM  
SCHALTSCHEMA  
SCHEMA DE CONNEXIONS  
SCHEMA DI COLLEGAMENTO :

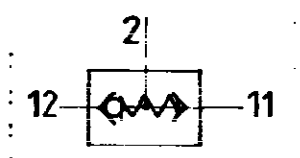

MARKING OF PORTS  
KENNZEICHNUNG DER ANSCHLUESSE  
MARQUAGE DES ORIFICES  
MARCATURA DEGLI ORIFIZI

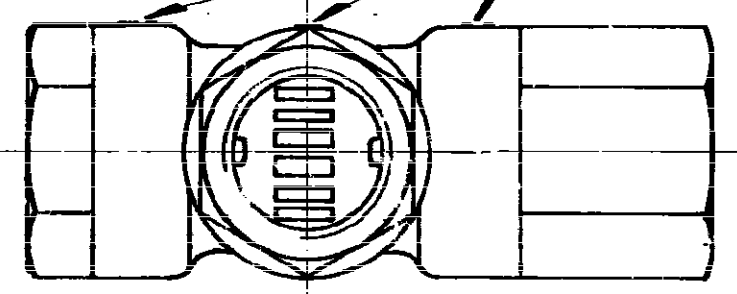

VALVE OPENING PRESSURE PORT 12  
VENTILOEFFNUNGSDRUCK BEI ANSCHLUSS 12 < 0,1bar  
PRESSION D'OUVERTURE ORIFICE 12  
PRESSIONE DI APERTURA ORIFIZIO 12

GENERAL TOLERANCES					
CLASS	RANGE OF NOMINAL DIMENSIONS (± mm)				FORCE POWER PRESSURE ETC
	0 - 50	> 50 - 180	> 180 - 400	> 400	
I	0.05	0.15	0.2	0.3	5
II	0.1	0.2	0.3	0.4	10
III	0.2	0.35	0.5	0.65	20

TAPPED HOLES ACC. ISO 4039  
TOLERANCE CLASS APPLIED CROSSMARKED

CHANG No.	LEFT	DATE
REPLACEMENT FOR	SIZE	TRI
884 612 039 0	A 3	210

COPYRIGHT BY WABCO		<b>WABCO</b>	
DATE	DRAWN	DOUBLE CHECK VALVE	
14-02-96	UL	ZWEIWEGEVENTIL	
14-02-96	BION	DOPPIA VALVOLA D'ARRESTO	
20-03-96	96081	DOUBLE VALVE D'ARRÊT	
MASS	SCALE	IDENTIFICATION	
0,390	1:1	434 208 054 0	
CODE FOR FUNCTION	CODE FOR SHAPE	CODE FOR DOCUMENT	
		605	