

Non è permesso consegnare o terzi o riprodurre questo documento, né utilizzare il contenuto o renderlo comunque noto a terzi
 without the express written permission of the manufacturer. It is forbidden to copy, reproduce or disseminate this document or its content in any form or by any means, electronic or mechanical, including photocopying, recording, or by any information storage and retrieval system.

Toute communication ou reproduction de ce document, toute exploitation ou communication de son contenu sont interdites, sauf
 autorisation expresse. Tout manquement à cette règle constitue un abus, éventuellement punissable, et engage son auteur au versant de dommages et
 intérêts. Tous droits de propriété industrielle réservés, notamment en matière de brevets et de modèles.

Copying of this document and giving it to others and the use or communication of the contents thereof, are forbidden without express
 written permission of the manufacturer. It is forbidden to copy, reproduce or disseminate this document or its content in any form or by any means,
 electronic or mechanical, including photocopying, recording, or by any information storage and retrieval system.

Weitergabe sowie Vervielfältigung dieser Unterlagen, Verwertung und Mitteilung ihres Inhalts nicht gestattet, soweit
 nicht ausdrücklich zugestimmt. Zuwiderhandlungen stellen einen strafrechtlichen Missbrauch dar und verpflichten zu Schadensersatz.
 Alle Rechte für den Fall der Patentierung oder Gebrauchsmuster-Eintragung vorbehalten.

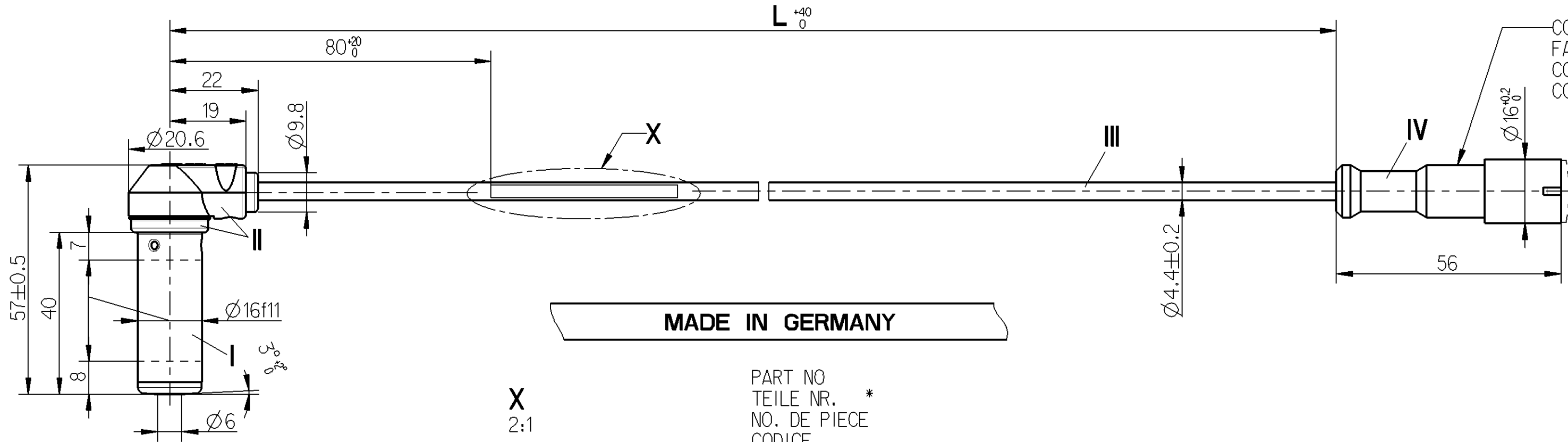

--- PROTECTION CAP
 SCHUTZKAPPE
 CAPOUCHON
 PROTETTORO

MADE IN GERMANY

WABCO 441 032 . . . 0
 PART NO
 TEILE NR. *
 NO. DE PIECE
 CODICE

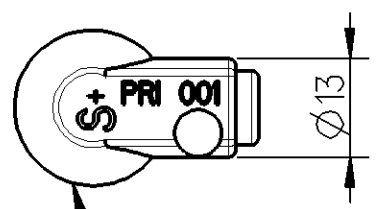

DATE OF MANUFACTURE
 HERSTELLDATUM + HT
 DATE DE FABRICATION
 DATA DI FABBRICAZIONE

THERMAL RANGE OF APPLICATION
THERMISCHER ANWENDBEREICH
GAMME D'APPLICATION THERMIQUE
CAMPO TERMICO D'APPLICAZIONE

- I -40 °C...+200 °C [1000h]
- II -40 °C...+150 °C
- III -40 °C...+180 °C
- IV -40 °C...+80 °C

WABCO-NO.	CUSTOMER-REF. ①	L [mm]	**	MASS [kg]
441 032 862 0		2500	BLACK SCHWARZ NOIR NERO	0.120
441 032 863 0			ORANGE ORANGE ORANGE ARANCIONE	
441 032 167 0		2900	BLACK SCHWARZ NOIR NERO	0.150
441 032 168 0			ORANGE ORANGE ORANGE ARANCIONE	
441 032 175 0		4200	BLACK SCHWARZ NOIR NERO	0.200
441 032 176 0			ORANGE ORANGE ORANGE ARANCIONE	

TWO CORE CABLE
 LEITUNG ZWEIADRIG
 CABLE A DEUX CONDUCTEURS
 CAVO A DUE CONDUTTORI } THERMORAD
 2x0.5mm²
 ASC 77799 A

STRAIN RELIEF CABLE
 ZUGENTLASTUNG KABEL
 ARRET DE CABLE
 SCARICO DI TRAZIONE DEL CAVO } MAX.50N @ -20°C

BEND RADIUS CABLE
 BIEGERADIUS KABEL
 RAYON DE COURBURE DE CABLE
 RAGGIO DI CURVATURA DEL CAVO } R 15 MIN, $\alpha 90^\circ$

* ABRASION RESISTANT PRINT
 ABRIEBFESTER AUFDRUCK
 IMPRESSION RESISTANTE A L' ABRASION
 IMPRONTA RESISTENTE ALL' ABRASIONE } RAL 9001

FURTHER TECHNICAL DATA SEE PRODUCT SPECIFICATION
 WEITERE TECHNISCHE DATEN SIEHE PRODUKT SPEZIFIKATION
 AUTRES DONNEES TECHNIQUES VOIR PRODUCT SPECIFICATION
 ULTERIORI DATI TECNICI VEDERE SPECIFICA DI PRODOTTO

441 032 191 0

1:1

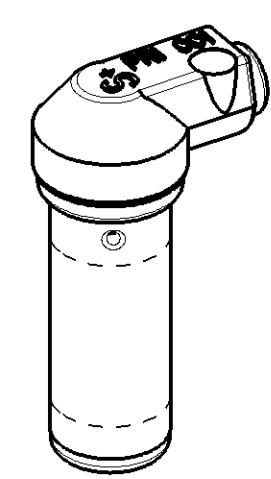

INSTRUCTIONS OF INSTALLATION SEE ADAPTATION SPECIFICATION
 EINBAUINWEISE SIEHE ADAPTION-SPEZIFIKATION
 INSTRUCTIONS D'INSTALLATION VOIR SPECIFICATION D'ADAPTION
 ISRUZIONI D'INSTALLAZIONE VEDERE SPECIFICA D'ADATTAMENTO

441 032 100 0

DEGREE OF PROTECTION (IN CONNECTION WITH PLUG)
 SCHUTZART (IN VERBINDUNG MIT KUPPLUNGSSTECCKER)
 DEGRE DE PROTECTION (DANS CONNECTION AVEC CONNECTEUR MALE)
 GRADO DI PROTEZIONE (IN COLLAGAMENTO CON SPINOTTO)

IP 69 K
ISO 20653

General Specification: JED-334-0		Copyright WABCO®		WABCO				
Further Technical Data:		Date	Signature					
Doc. Code:	Sheet:	To	Drawn	INDUCTIVE SENSOR WITH SOCKET KUPPLUNGSDOSE CAPTEUR AVEC CONNECTEUR FEMELLE SENSORE INDUTTIVO CON CONNETTORE				
General Tolerances JED-261			2010-02-04				Harnischmacher	
Range of Nominal Dimensions (± mm)			Checked				2010-02-04	Hoefler
Class 1) ≤ 50 > 50 > 180 > 400			Expert				Hoefler	
Fine			Mass	Scale	Material No.	Date of first issue: 1998-08-13		
Medium			/	1:1	441 032 861 0	Doc.Code	Language	Sheet
Coarse X			Size	CAD System		053	ML	1/1
Tapped Holes acc.			A 2	Pro/E	ECN-No.	Revision	Techn. Resp.	Replacement for
1) Tolerance Class Applied Crossmarked					152089	1x D	6310	

100mm