

ALTERNATIVE DESIGN PERMISSIBLE  
AUSFUEHRUNG ALTERNATIV ZULAESSIG  
REALISATION ALTERNATIVE ADMISSIBLE  
SOLUZIONE ALTERNATIVA AMMESSA

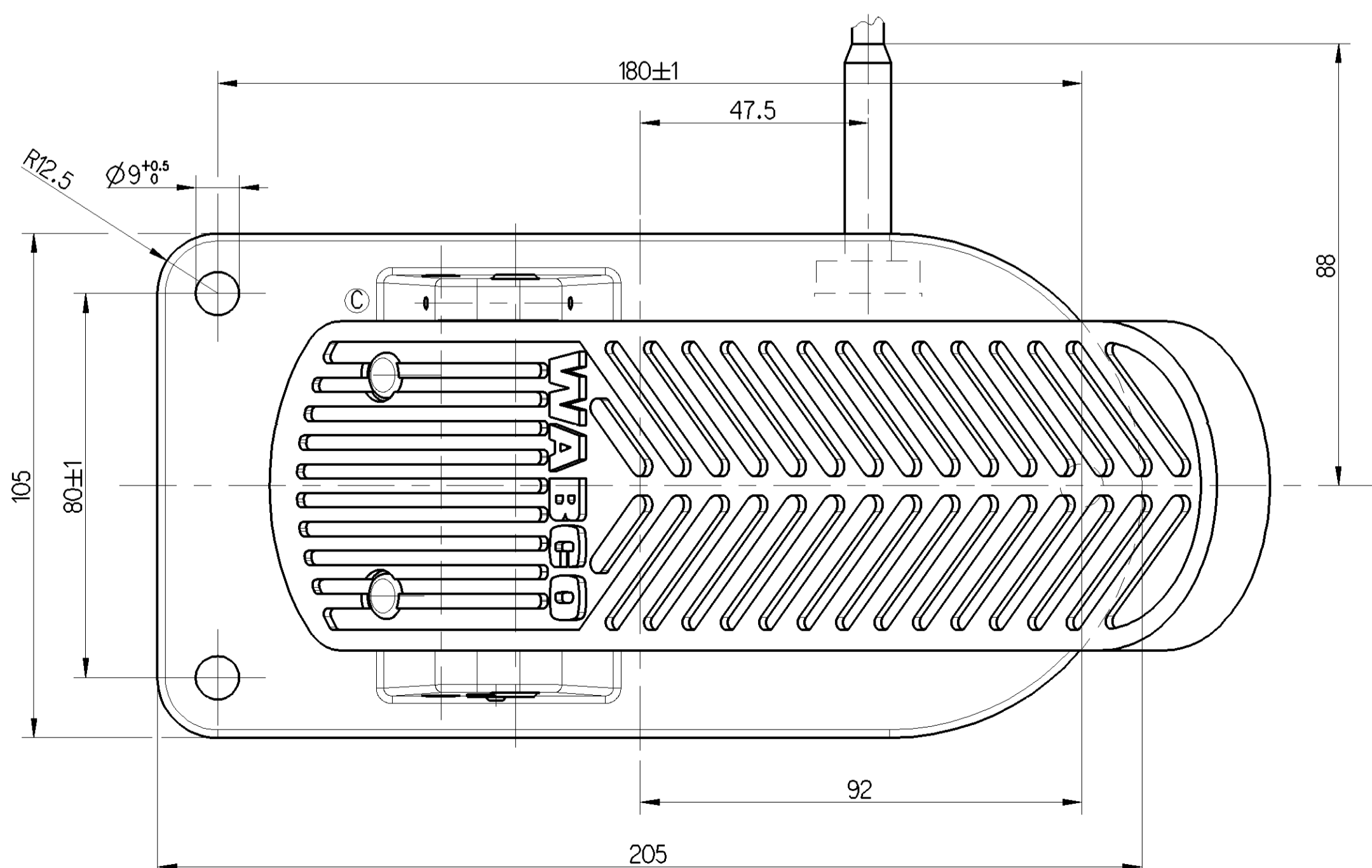
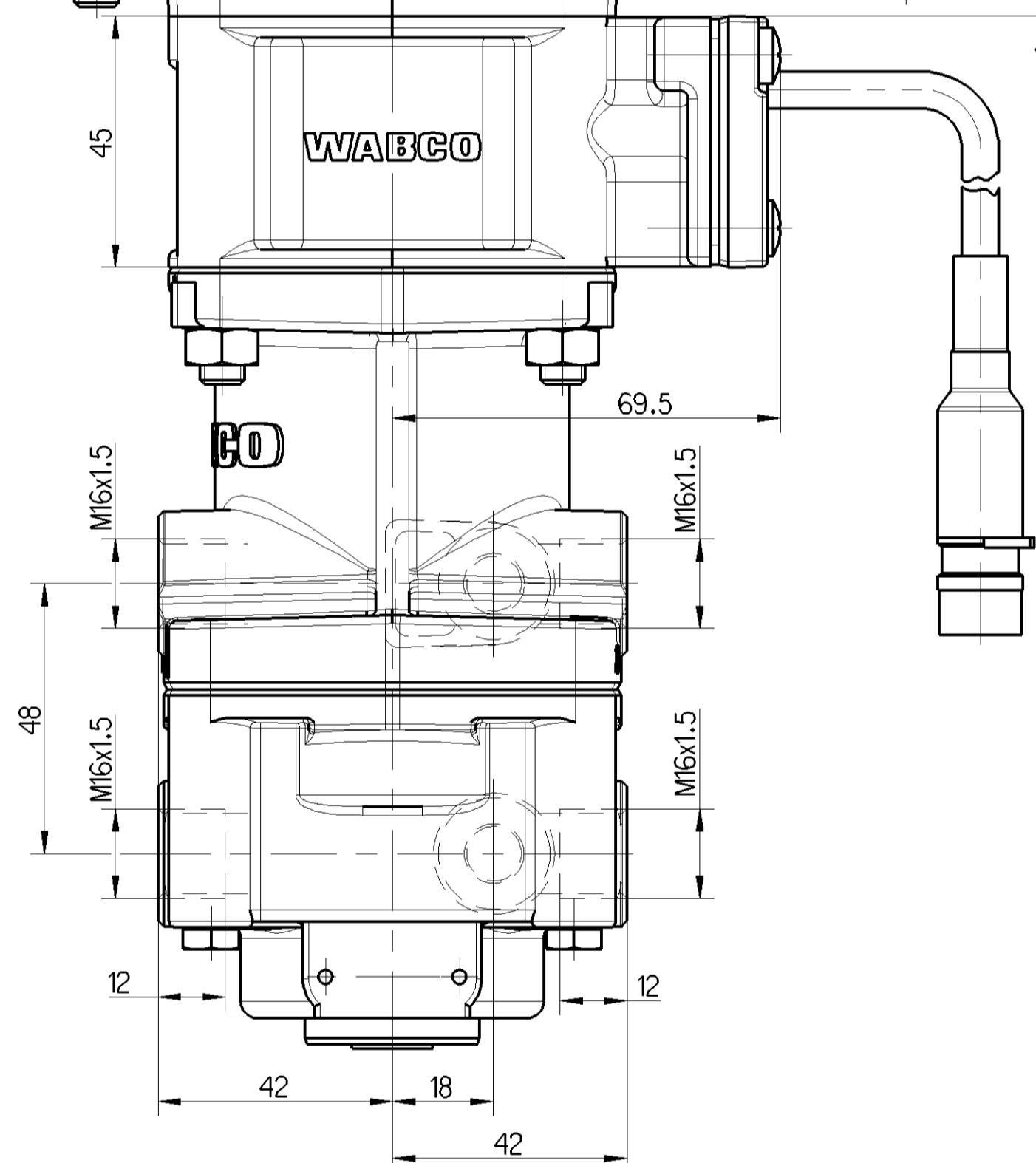
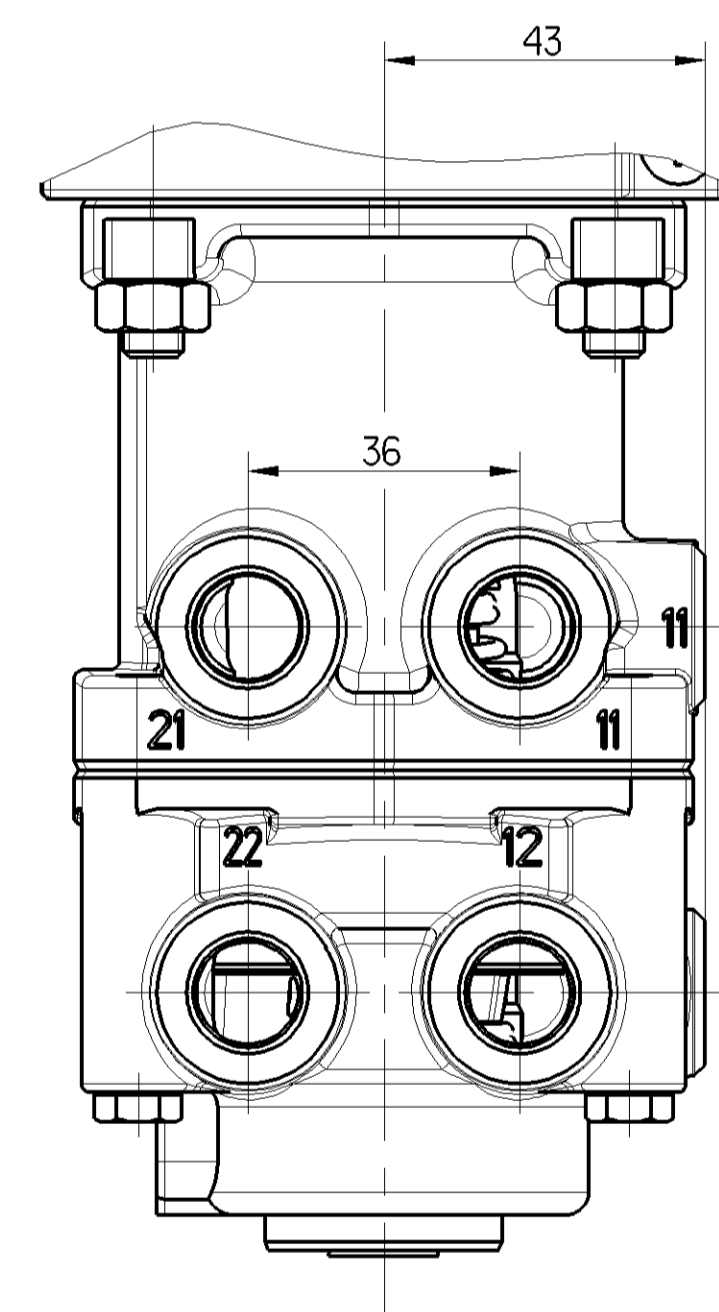
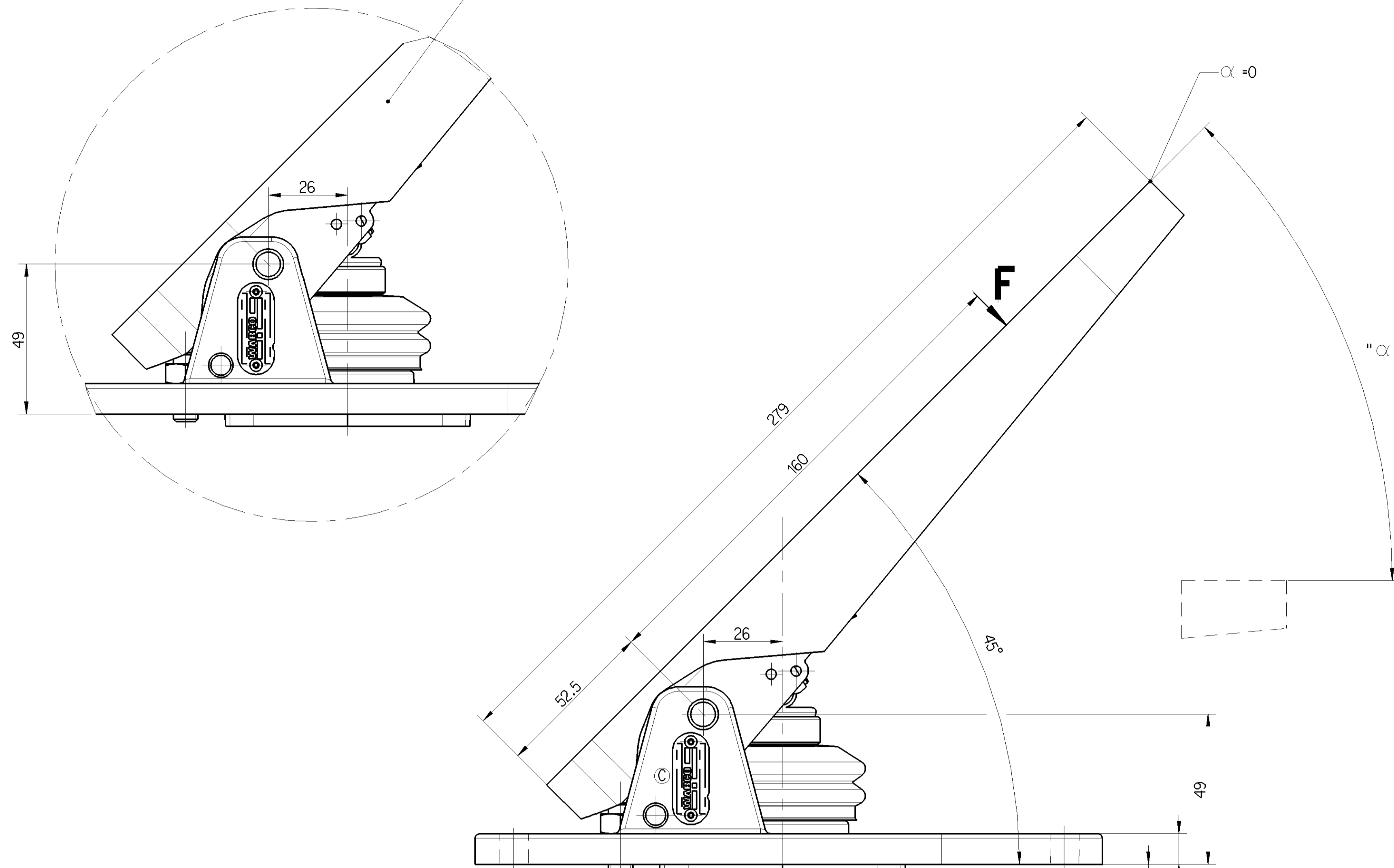

PULL OFF POINT (MECHANICAL)  
DRUCKPUNKT (MECHANISCH)  
POINT OF POUSSÉE (MECHANIQUE)  
PUNTO DI RESISTENZA (MECCANICO)

SWITCH ON POINT OF SWITCH I  
EINSCHALTPUNKT SCHALTER I  
POINT DE FERMETURE DU CONTACTEUR I  
PUNTO DI CHIUSURA DELL'INSERITORE I

SWITCH ON POINT OF SWITCH III  
EINSCHALTPUNKT SCHALTER III  
POINT DE FERMETURE DU CONTACTEUR III  
PUNTO DI CHIUSURA DELL'INSERITORE III

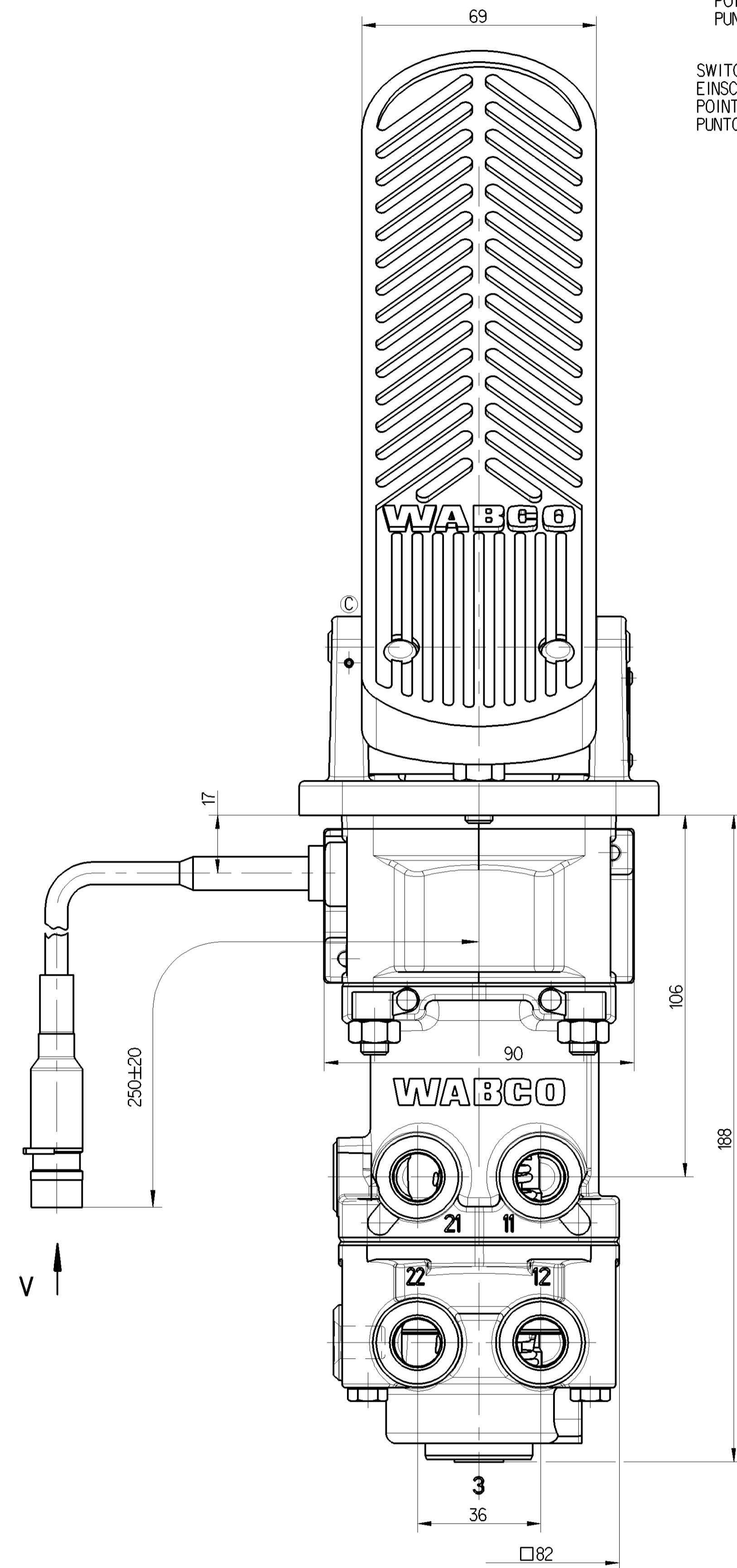
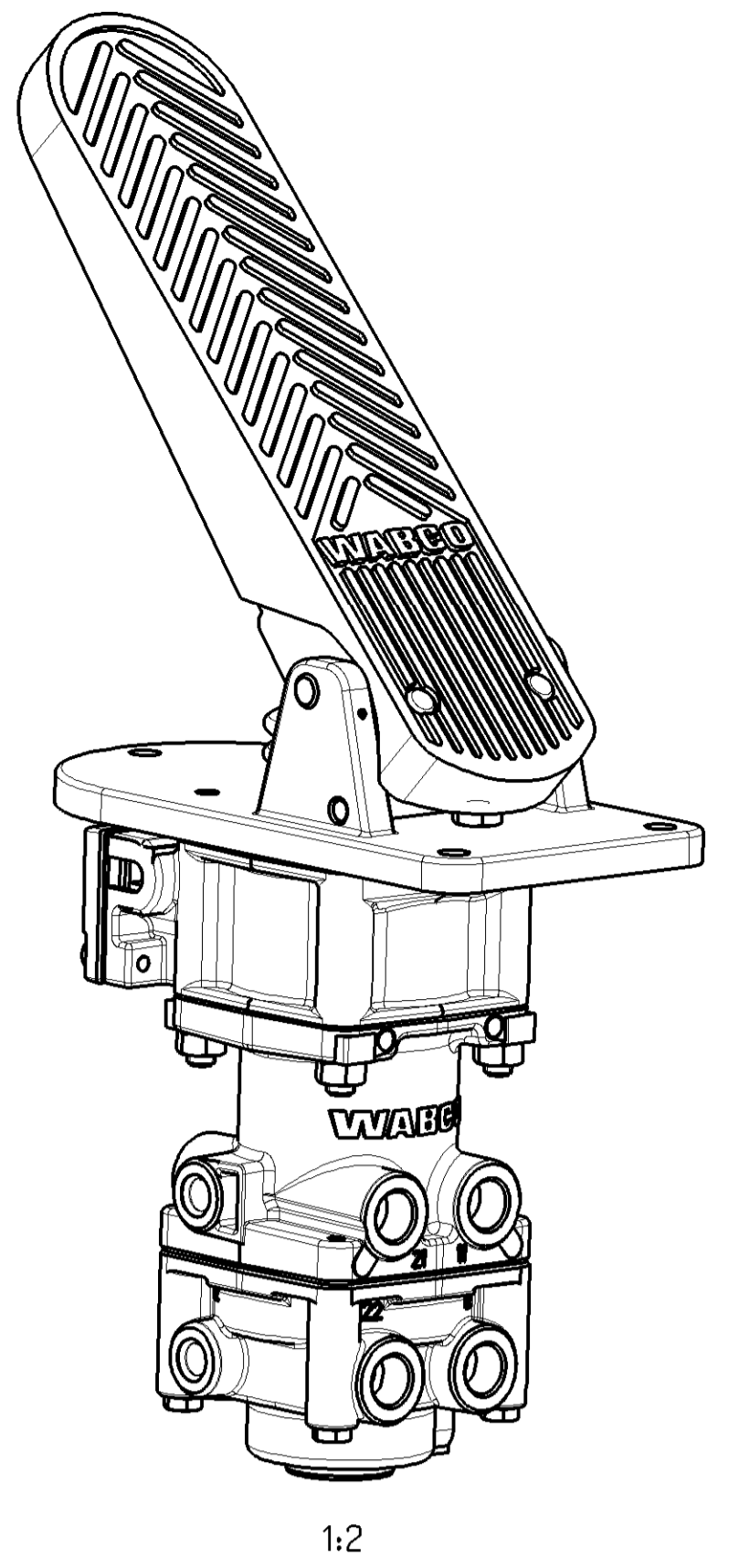
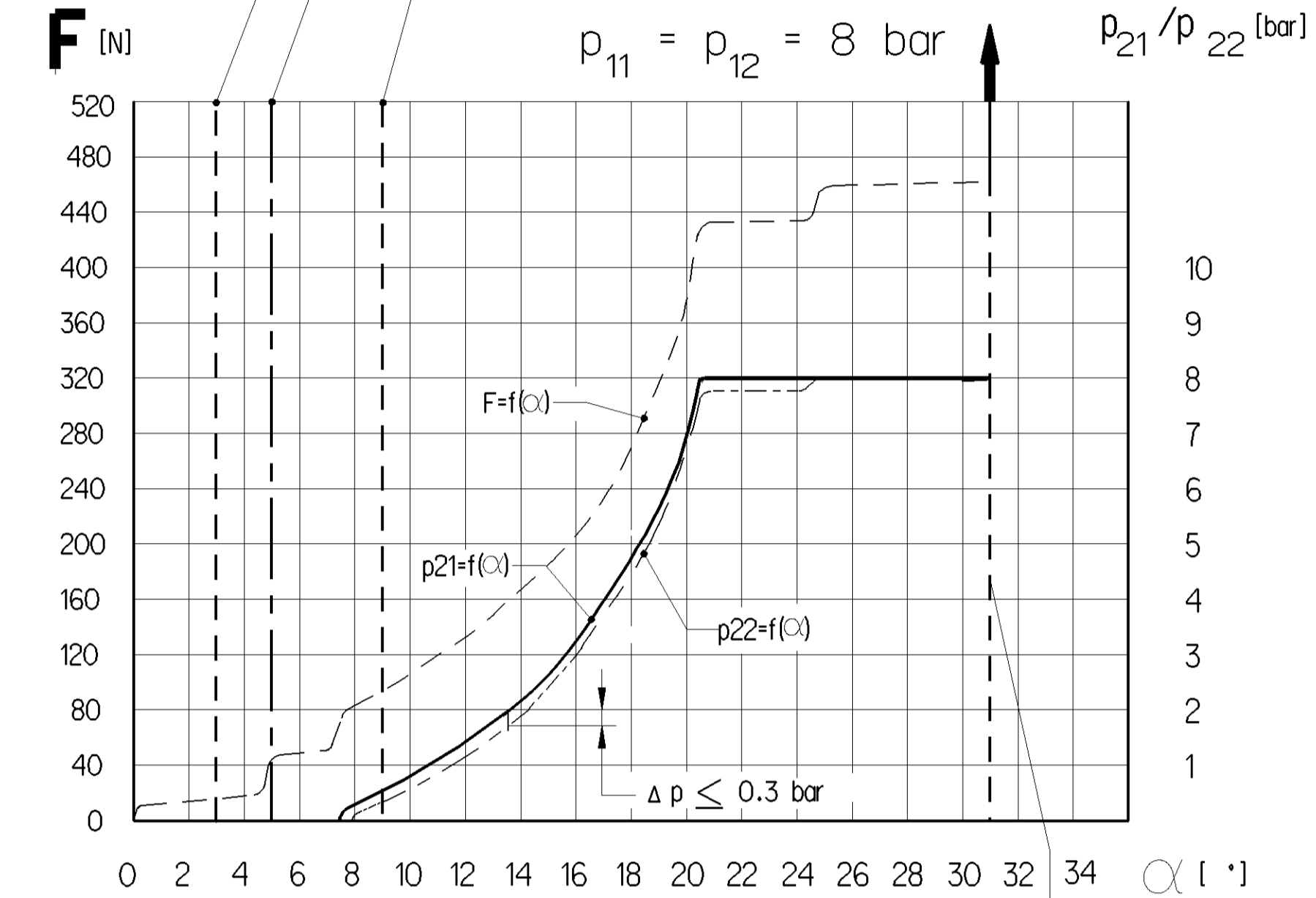

1/1/2 SUPPLY  
VORRAT ALIMENTATION  
ALIMENTAZIONE

2/2/22 OUTLET  
AUSGANG SORTIE  
USCITA

3 EXHAUST  
ENTLUEFTUNG  
ECHAPPEMENT  
SCARICO

THERMAL RANGE OF APPLICATION :  
THERM. ANWENDUNGSBEREICH : -40°C ... +80°C  
GAMME D'APPLICATION THERMIQUE:  
CAMPO CI APPLICAZIONE TERMICA:

MEDIUM: AIR  
MEDIUM: LUFT  
FLUIDE: AIR  
FLUIDO: ARIA

WORKING PRESSURE :  
BETRIEBSDRUCK : p<sub>0</sub> = MAX. 8.5 bar  
DIAMETRE NOMINAL :  
DIAMETRO NOMINALE:

(TEMPORARILY)  
(KURZZEITIG)  
IDE COURTE DUREE :  
BREVE TEMPO SOLO : p<sub>0</sub> = MAX. 10 bar

TORQUE FOR CONNECTIONS:  
ANZUGSMOMENT FUER EINSCHRAUBSTUTZEN:  
COUPLE DE SERRAGE DES RACCORDS:  
COPPIA DI SERRAGGIO DEI RACCORDI:

M12x1.5: M-MAX. 21 Nm  
M16x1.5: M-MAX. 34 Nm

INSTALLATION POSITION: EXHAUST SHOWN AT BASE (AXIS CENTRE OF THE DEVICE DEVIATES MAX. 45° FROM VERTICAL)

EINBALLAGE: ENTLUEFTUNG NACH UNTEN (MITTELACHSE DES GERÄTES MAX. 45° VON DER SENKRECHTEN ABWEICHEND)

POSITION D'INSTALLATION: ECHAPPEMENT VERS LA BAS (ECART DE L'AXE MEDIAN DE L'APPAREIL PAR RAPPORT A LA VERTICALE: 45° MAX.)

POSIZIONE DI MONTAGGIO: SCARICO VERSO IL BASSO (DEVIAZIONE ASSE APPARECCHIO RISPETTO ALLA VERTICALE: MAX. 45°)

SWITCH LOAD I, II, III : AT 24 V - 1 A (INDUCTIVE LOAD)  
SCHALTERBELASTUNG I, II, III : BEI 24 V - 1 A (INDUKTIVE LAST)  
CHARGE DU CONTACTEUR I, II, III : A 24 V - 1 A (CHARGE INDUCTIVE)  
CARICO DELL'INSERITORE I, II, III : A 24 V - 1 A (CARICO INDUTTIVO)

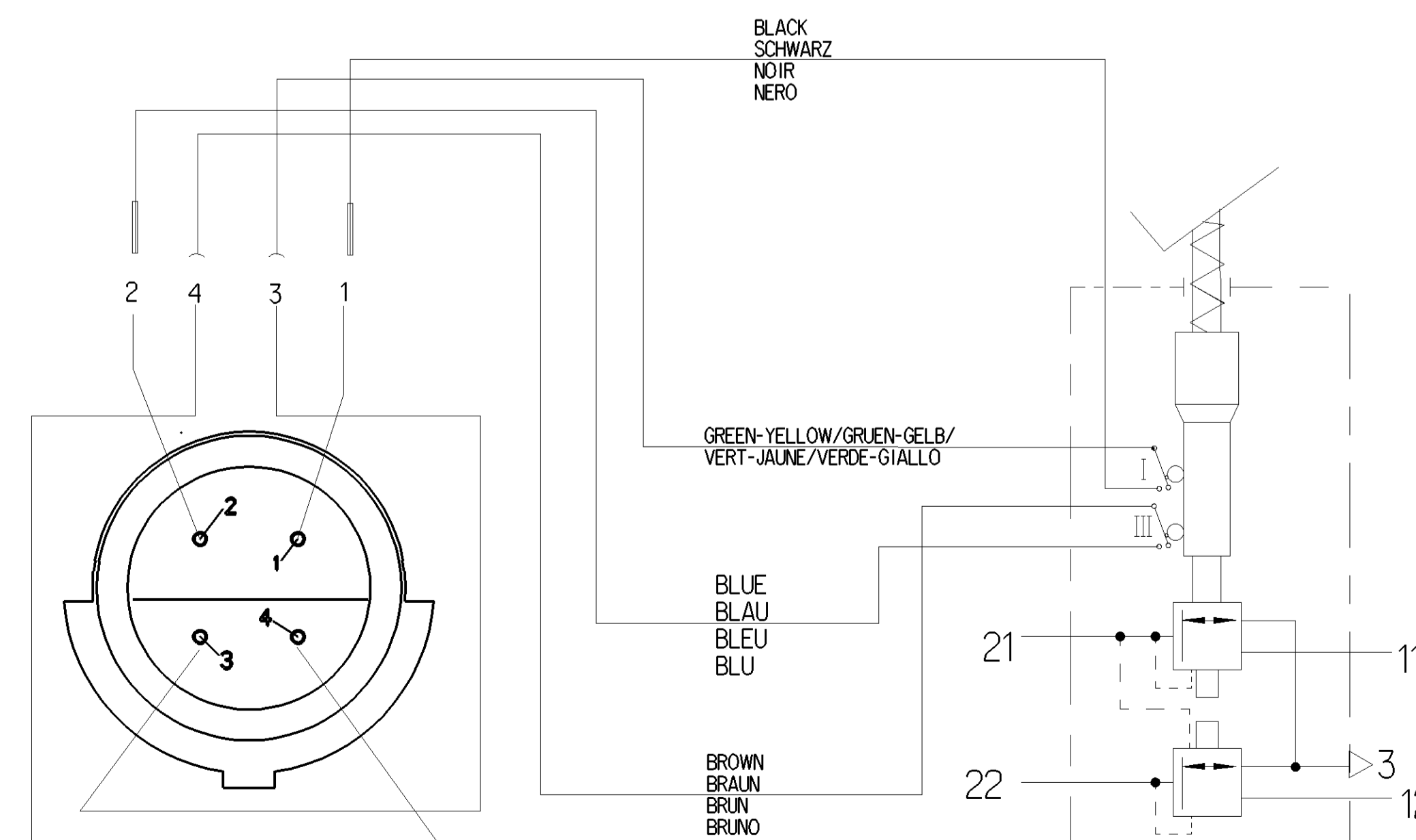

|   |                |   |         |              |             |   |        |
|---|----------------|---|---------|--------------|-------------|---|--------|
| General Specifications: 461-334-1, Size 104/05 LP   |                | Copyright WABCO®                        |         | <b>WABCO</b> |             |   |        |
| Further Technical Data: 461 318 036 0   | Doc. Code: 035 | Drawn: To                               | System: | 2016-06-16   | RAJASEKARAN | BRAKE VALVE<br>MOTORWAGEN-BREMSVENTIL<br>ROBINET DE FREINAGE<br>DISTRIBUTORE DI COMANDO | 26/45° |
| Class 0 : ± 0.10<br>1 : ± 0.15<br>2 : ± 0.20<br>3 : ± 0.30<br>4 : ± 0.40<br>5 : ± 0.50<br>6 : ± 0.60<br>7 : ± 0.80<br>8 : ± 1.00<br>9 : ± 1.50<br>10 : ± 2.00 |                | Range of Nominal Dimensions (± 0.05 mm) |         | ADAMSKI      |             | Date of 1st issue: 006 ML 1/1   |        |
| Tapped holes acc. ISO 4035, 4036, 4037  |                | Tapped holes acc. ISO 4035, 4036, 4037  |         | A 0          |             | Replacement for   |        |