

Non e permesso consegnare a terzi o riprodurre questo documento, ne utilizzare il contenuto o renderlo comunque noto a terzi senza autorizzazione esplicita. Ogni infrazione costituisce un evidente abuso e comportera il risarcimento dei danni subiti. E' fatta riserva di tutti i diritti derivanti da brevetti o modelli.

Copying of this document and giving it to others and the use or communication of the contents thereof, are forbidden without express authority. Contravention of this restriction will constitute an evident abuse and result in a liability to the payment of damages. All rights are reserved in the event of the grant of patent or registration of a utility model or design. This document is the subject of copyright.

Toute communication ou reproduction de ce document, toute exploitation ou communication de son contenu sont interdites, sauf autorisation expresse. Tout manquement a cette regle constitue un abus evident et expose son auteur au versement de dommages et interets. Tous droits de proprieete industrielle reserves, notamment en matiere de brevets et de modesles.

Weitergabe sowie Vervielfaeltigung dieser Unterlagen, Verwertung und Mitteilung ihres Inhalts nicht gestattet, soweit nicht ausdruecklich zugestanden. Zuwiderhandlungen stellen einen offensichtlichlichen Missbrauch dar und verpflichten zu Schadensersatz. Alle Rechte fuer den Fall der Patenterteilung oder Gebrauchsmuster-Eintragung vorbehalten.

1	2	3	4	5	6	7	8
A	B	C	D	E	F	G	N
M22x1,5 Nut Hex.27	M22x1,5 Ø15 Nut Hex.27	~21	Hex.19		~76	~54	Test Fitting 463 703 521 2
							ISO8434-1
							R

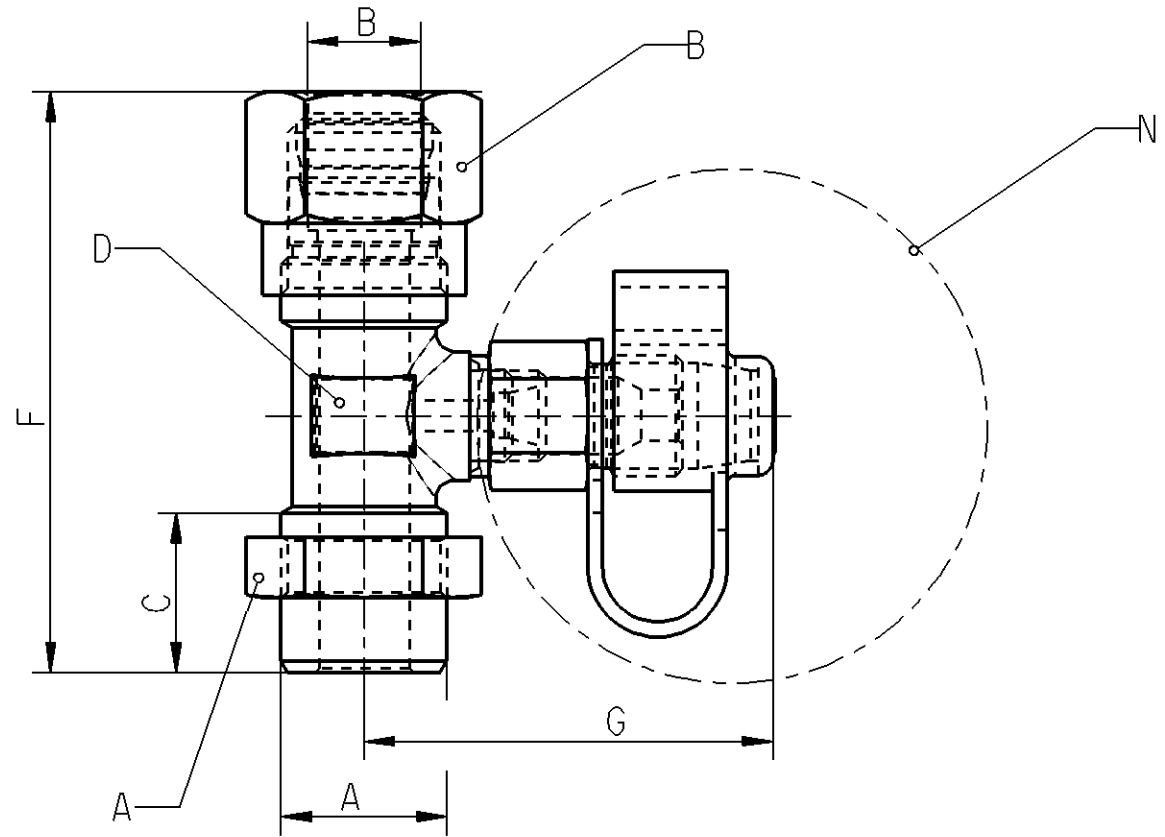

Material : Steel  
Surface Protection : gal Zn CrVI free

Material : CuZn / Cu / JED-045M1/ SpringSteel/ NBR/ Delrin

First production samples, samples from new or modified moulds or changes of every kind must be approved Engineering Department

Teile der ersten Produktion, Teile aus neuen oder geaenderten Formwerkzeugen oder Aenderungen jeglicher Art beduerfen der Genehmigung durch die Entwicklungsabteilung

Les premieres pieces de production, les pieces provenant de nouveaux moules ou de moules modifies, ou toutes autres modification, doivent etre approuvees par le departement des etudes

Campioni di inizio produzione, campioni ottenuti con stampi nuovi o modificati o con qualsiasi genere di modfica devono essere approvati dall'ufficio tecnico.

General Specification: JED-334-0		Copyright WABCO®		<b>WABCO</b>	
Further Technical Data:		Date	Signature		
Doc. Code:	Sheet: To	Drawn		Test Connector Pruefstecker Fiche de controle Spina di prova	
General Tolerances JED-261		2010-01-25	Guemues		
Range of Nominal Dimensions ( ± mm)		Checked		Date of first issue: 2010-01-27	
Class 1)	≤ 50 > 50 > 180 > 400 > 400	2010-01-27	Maertin		
Fine 0.5 1.0 1.5 2.0		Expert		Material No. 463 703 001 0	
Medium 1.0 2.0 3.0 4.0		Thiele			
Coarse 2.0 3.5 5.0 6.5		Mass	Scale	Date of first issue: 2010-01-27	
Tapped Holes acc.		0,227 KG	/	Doc.Code	Language
1) Tolerance Class Applied Crossmarked		Size	CAD System	005	ML
		A 3	Pro/E	1/1	
		ECN-No. 151637		Revision	Techn. Resp. 5790
		Replacement for			