

- 6.1 ELECTRICAL CONTROL
ELEKTRISCHER STEUERANSCHLUSS (MAGNET)
- 6.2 COMMANDE ELECTRIQUE
- 6.3 COMANDO ELETTRICO

- 6.4 ELEKTRISCHER STEUERANSCHLUSS (3/2-WEGEVENTIL)
- 6.5 COMMANDE ELECTRIQUE
- 6.6 COMANDO ELETTRICO

- 6.6 ELECTRICAL CONTROL
ELEKTRISCHER STEUERANSCHLUSS (DRUCKSENSOR)
- 6.7 COMMANDE ELECTRIQUE
- 6.8 COMANDO ELETTRICO

- 1 SUPPLY OF ENERGY
ENERGIEZUFLOSS
ALIMENTATION
ALIMENTAZIONE

- 2 DELIVERY OF ENERGY
ENERGIEABFLUSS
UTILISATION
MANDATA

- 3 EXHAUST
ENTLUEFTUNG
ECCAPPENT
SCARICO

- 4 CONTROL
STEUERANSCHLUSS
COMMANDE
COMANDO

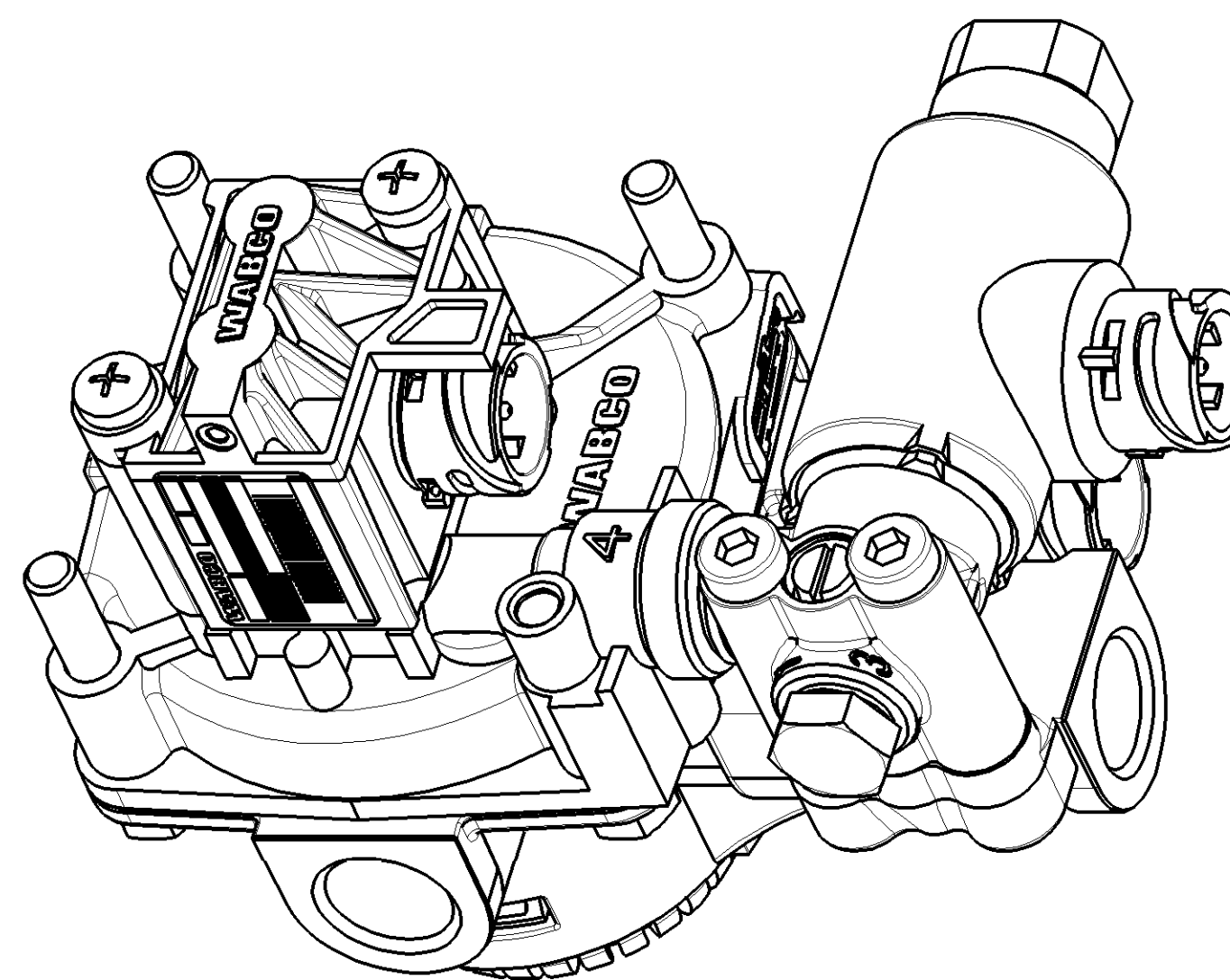

THE VALVE CORRESPONDS TO THE REGULATIONS FOR ELECTROMAGNETIC DEVICES ACCORDING TO VDE 0580
 DAS GERÄT ENTSPRICHT DEN BESTIMMUNGEN FÜR ELEKTROMAGNETISCHE GERÄTE NACH VDE 0580
 LA VALVE CORRESPOND AUX CONDITIONS POUR DES APPAREILS ELECTROMAGNETIQUES SUIVANT VDE 0580
 LA VALVOLA CORRISPONDE ALLE CONDIZIONI PER APPARECCHI ELECTROMAGNETICHI SECONDO VDE 0580

- MEDIUM
MEDIUM
FLUIDE
FLUIDO
- AIR
LUFT
AIR
ARIA

- VOLTAGE
SPANNUNG
VOLTAGE
VOLTAGGIO
- 24±6 V

- TYPE OF CURRENT
STROMART
NATURE DU COURANT
NATURA DELLA CORRENTE
- DIRECT CURRENT
GLEICHSTROM
COURANT CONTINU
CORRENTE CONTINUA

- SERVICE CONDITION
BETRIEBSART
CONDITION DU SERVICE
CONDIZIONE DI SERVIZIO
- INTERMITTENT DUTY
AUSSETZBETRIEB
SERVICE INTERMITTENT
FUNZIONAMENTO INTERMITTENTE
- ED 5%/5min

- RATED CURRENT
NENNSTROM
COURANT NOMINAL
CORRENTE NOMINALE
- 1.65 A

- DEGREE OF PROTECTION
SCHUTZART
DEGRE DE PROTECTION
GRADO DI PROTEZIONE
- IP 69k

- PROTECTION CLASS
SCHUTZKLASSE
CLASSE DE PROTECTION
CLASSE DI PROTEZIONE
- III

- WORKING PRESSURE
BETRIEBSDRUCK
PRESSION D'UTILISATION
PRESSIONE DI ESERCIZIO
- max. 10 bar

- THERMAL RANGE OF APPLICATION
THERMISCHER ANWENDBEREICH
GAMME D'APPLICATION THERMIQUE
CAMPO TERMICO D'APPLICAZIONE
- 40°C...+80°C

- SOCKET
GERÄTESTECKDOSE
PRISE DE COURANT
PRESA DI CORRENTE
- 449 372 000 0

- ADMISSIBLE INSTALLATION POSITION
ZULAESSIGE EINBAULAGE
POSITION D'INSTALLATION ADMISE
POSIZIONEDI MONTAGGIO AMMESSA
- ±15°

- FOR FURTHER TECHNICAL DATA SEE PRODUCT SPECIFICATION
WEITER TECHNISCHE DATEN SIEHE PRODUKT SPEZIFIKATION
POUR AUTRES DONNES TECHNIQUES VOIR PRODUCT SPECIFICATION
PER ULTERIORI DATI TECNICI VEDERE SPECIFICA DI PRODOTTO
- 480 207 001 0
(CODE 435)

- PLUG-IN CONNECTION
STECKVERBINDUNG (EL.)
CONNEXION A FICHE
ALLACCIAMENTO A SPINA
- * DIN 72 585 A1-3.1-Sn/K1
** DIN 72 585 A1-2.1-Sn/K1
*** DIN 72 585 A1-3.1-Sn/K2

| | | | | | |
|------------------------------------|--------|--|-----------|---|----------|
| General Specification: JED-334-0 | | Copyright WABCO® | | WABCO | |
| Further Technical Data: | | Date | Signature | EBS-RELAY VALVE EBS-RELAISVENTIL EBS-VALVE RELAIS EBS-VALVOLA RELE | |
| Doc. Code: | Sheet: | 2006-07-14 | Bolago | Doc.Code | Language |
| General Tolerances JED-261 | | 2006-07-15 | Kaufmann | 005 | en/98 |
| Range of Nominal Dimensions (± mm) | | Expert | | 1/1H | 1/1 |
| Class | 1) | ≤ 50 | > 50 | 1.89 | |
| | | ≤ 180 | > 180 | 1:1 | |
| | | ≤ 400 | > 400 | Size | TR1 |
| | | | | A 1 | 540 |
| 11657 | ZIG | 08-02-21 | Fine | 0.5 | 1.0 |
| 110292 | WV | 06-07-14 | Medium | 2.0 | 3.0 |
| 110230 | WE | 06-07-06 | Coarse | 3.5 | 5.0 |
| Tapped Holes acc. JED-152 | | State of Revision | | 1) Tolerance Class Applied Crossmarked | |
| State of Revision | | 1) Tolerance Class Applied Crossmarked | | 100mm | |