

SAFETY CHARACTERISTICS	0
SIGNIFICANT CHARACTERISTICS	0

FORWARD DRIVE-ROTATION DIRECTION

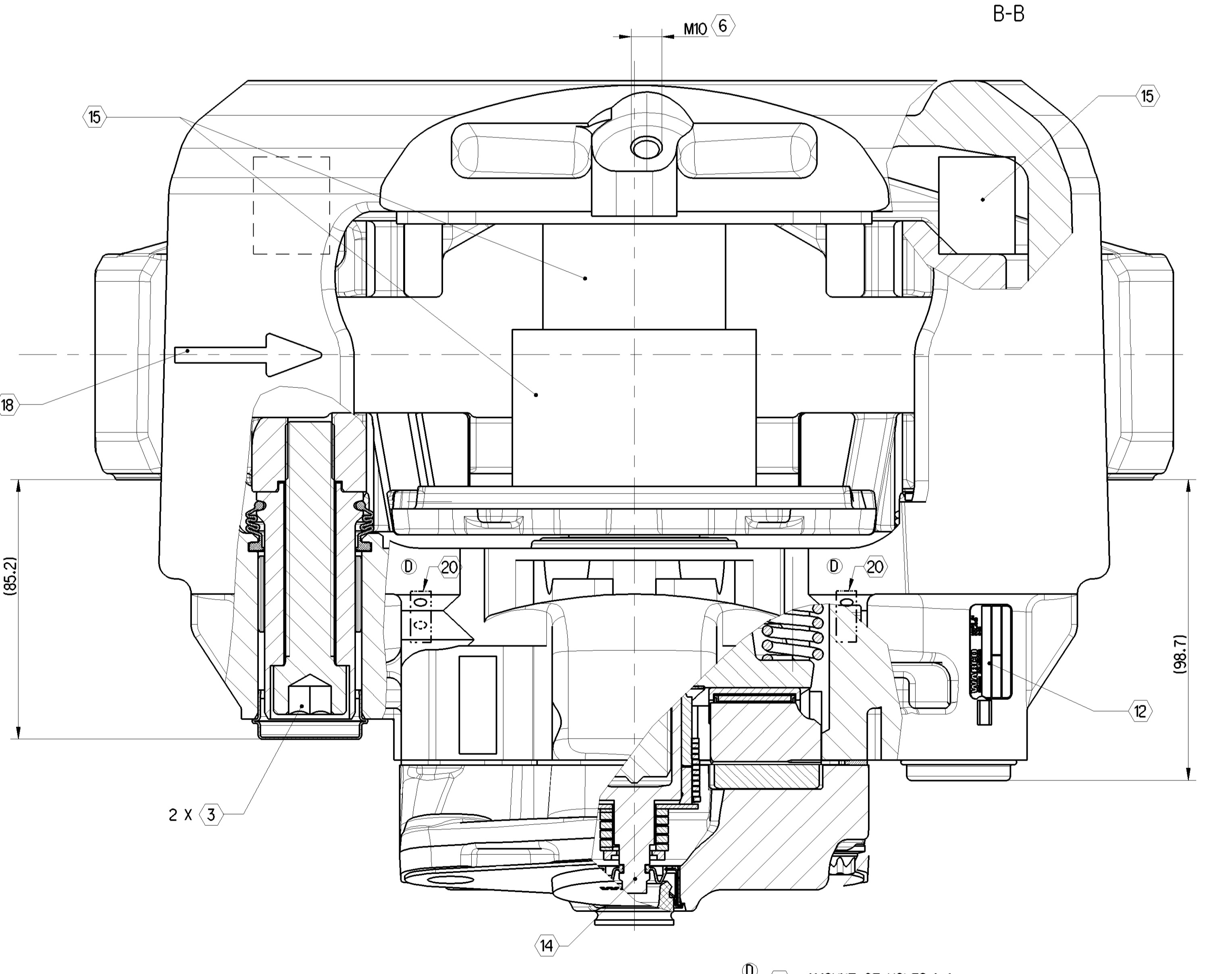
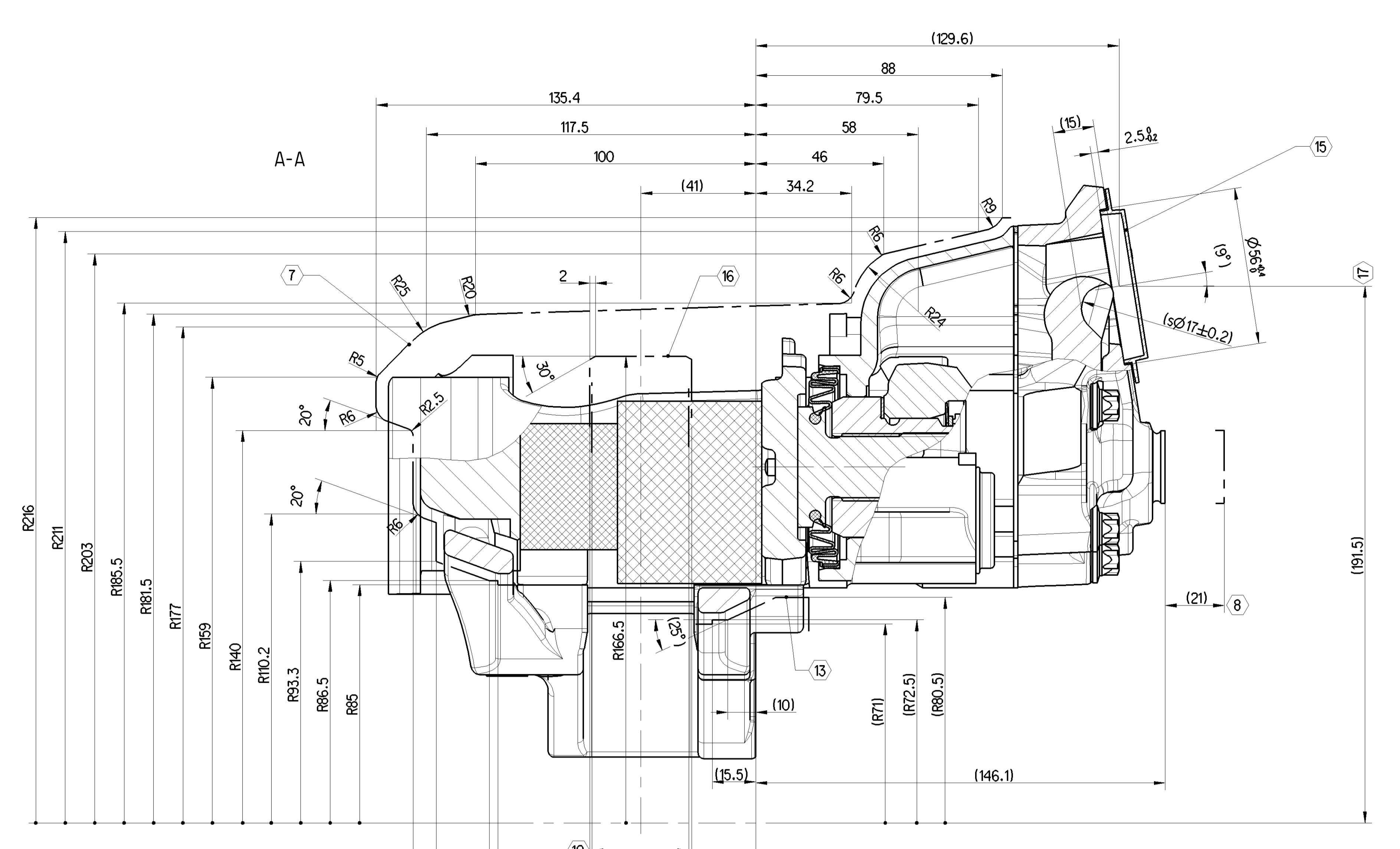
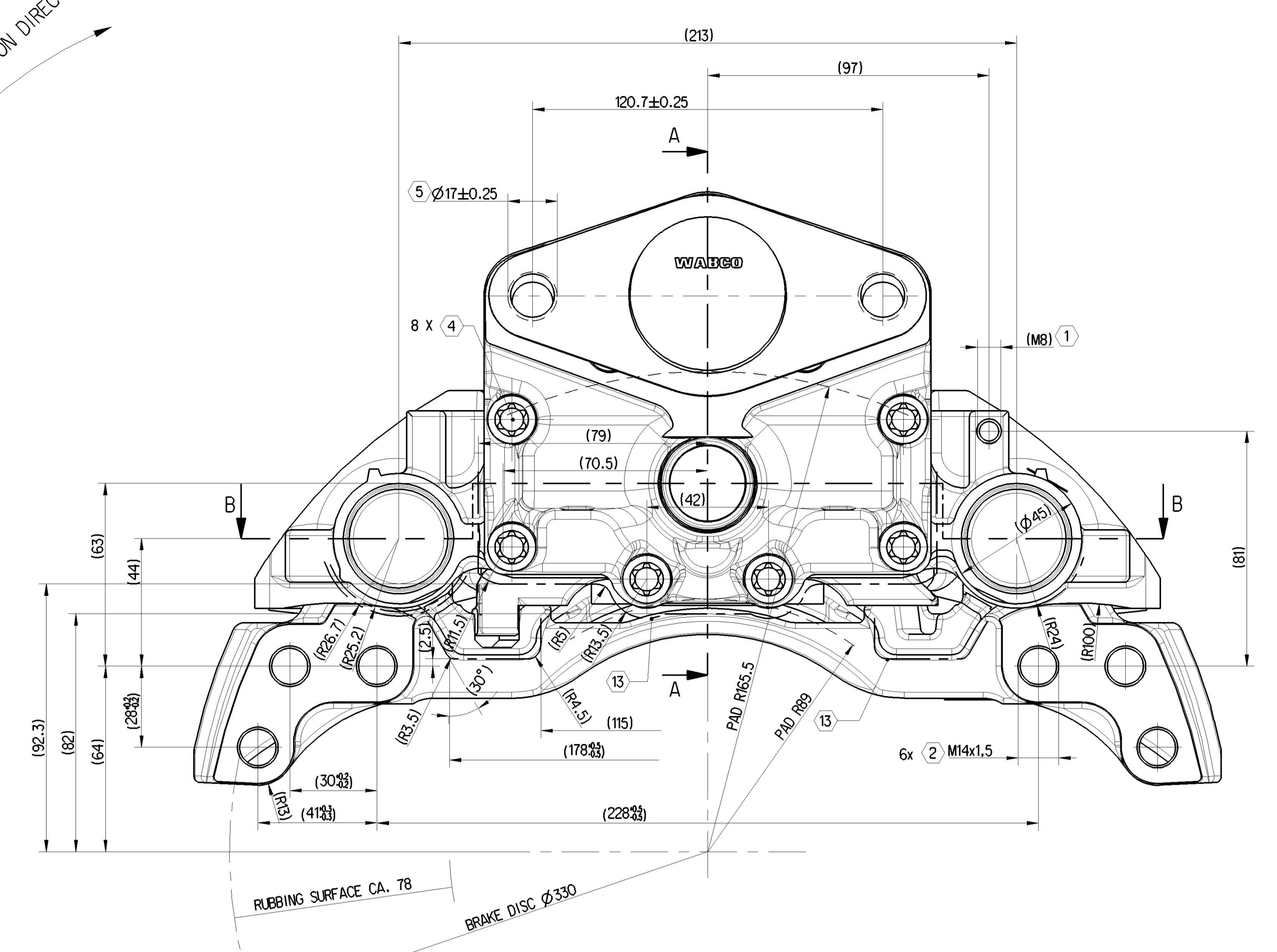

This document is the property of WABCO. It contains confidential information and is not to be distributed outside the company without prior approval. It is not to be used for manufacturing or other commercial purposes without the written consent of WABCO. WABCO assumes no responsibility for any errors or omissions in this document. WABCO reserves the right to change the design of the product without notice.

20 AMOUNT OF HOLES: 1-4
MINIMUM 1 FUNCTIONAL HOLE

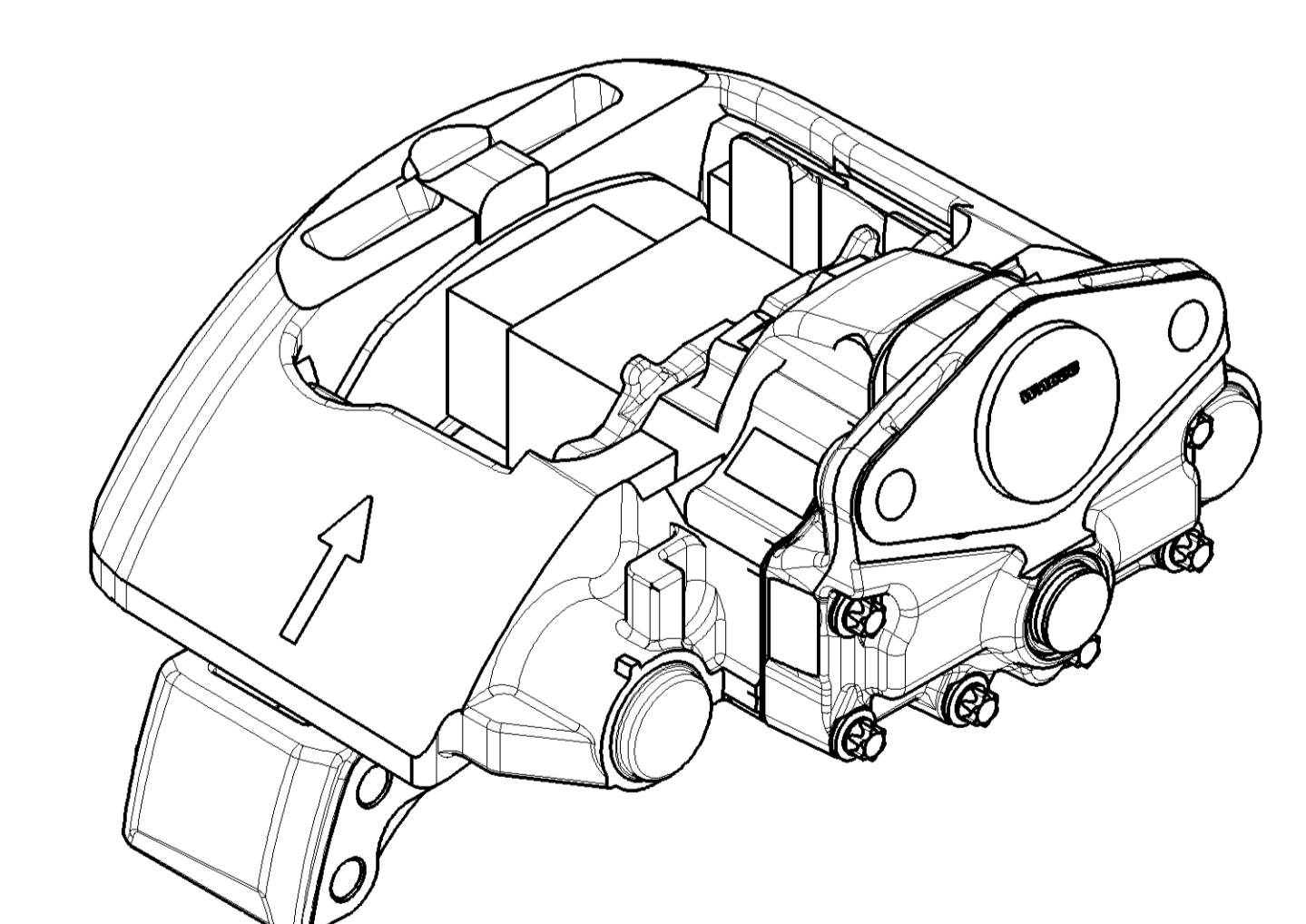

LABELING INFORMATION

1) CUSTOMER NUMBER (OPTIONAL)	2)
2) DATE OF REMANUFACTURING	3)
3) WABCO ID	4)
4) SERIAL NUMBER	1)

ID	TIGHTENING TORQUE	SIZE	REMARKS
1	22 ± 2 Nm	13	WEAR INDICATOR FASTENING ISO 4017-M8x14 ZINK-PLATED
2	180 ± 20 Nm	22 (DIN 9611) 21 (DIN 9676)	BRAKE MOUNTING HEXAGON SCREW, OILED M14 x 1.5 x ... - 10.9
3	340 ± 20 Nm ALTERNATE: 130 ± 10 Nm AND <90°	HEXAGON SOCKET 14	TIGHTENING ORDER (DIN 912-M16x1.5x80-12.9) 1. LONGER GUIDING 2. SHORTER GUIDING
4	68 ± 5 Nm	HEAD E12	COVER FIXING DIN 34800 - M10x1x40 - 12.9
5	210 - 30 Nm	24	OPERATION CYLINDER M16x1.5
6	20 ± 2 Nm	17	SCREW FOR LINING RETAINER
7	MAX. ROTARY OUTLINE		
8	MAX. DISPLACEMENT		
9	FITTING DIMENSION OF THE DISC		
10	BRAK DISC NEW 34-0.2, WEARABLE UP TO 28		
11	ASSEMBLY DIMENSION FOR BRAKE PADS		
12	PRODUCT IDENTIFICATION WABCO		
13	ENVELOPE CIRCLE CALIPER WITH COVER		
14	HEXAGON HEAD 8		
15	FOR STORAGE AND SHIPMENT		
16	MAXIMUM DISC CLEARANCE		
17	CENTER LINE CYLINDER		
18	FORWARD DRIVE - ROTATION DIRECTION		
19	BRAKE ACTUATOR SIZE RESTRICTION SEE PART SPECIFICATION 640 175 072 R		

ANTI-CORROSION PROTECTION - SALT SPRAY TEST MIN. 96 HOURS

PRODUCT SPECIFICATION 640 175 072 R

DIMENSIONS WITHOUT TOLERANCE ARE GAUGE DIMENSIONS

IDENTIFICATION TABLE

REMAN PN	REMANUFACTURED DEVICE OF	REFERENCE DOCUMENT	IMAGE
640 175 049 R	40 175 049	640 175 049 0 (DOC.053)	AS DRAWN
640 175 050 R	40 175 050	640 175 049 0 (DOC.053)	MIRROR

General Specification: 4E9-234-1 Further Technical Data: 640 175 072 R	Design: WABCO Date: 2019-06-14 Sheet: 1 of 2	WABCO DISC BRAKE CALIPER TYPE PAN 17	Date of 1st issue: 2009-01-18 Date of last issue: 2021-06-14 Language: EN Sheet: 1/1
Doc. Code: 053 General Tolerance: 4E9-261	Class to: 1 50 180 400 Fine: 0.5 1.0 1.5 2.0 Medium: 3.0 4.0 5.0 Coarse: 6.3 8.0 10.0 Tapped Holes acc. to DIN EN ISO 22674:2017 Material: 304 D Revision: 3 Year: 2021		