

1

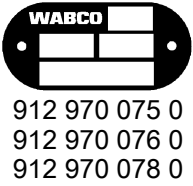

2

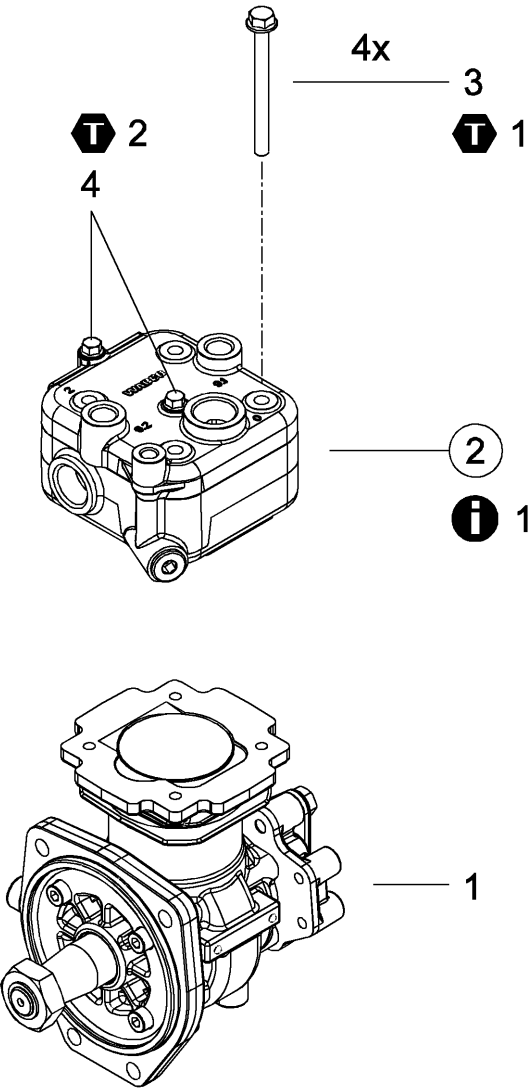
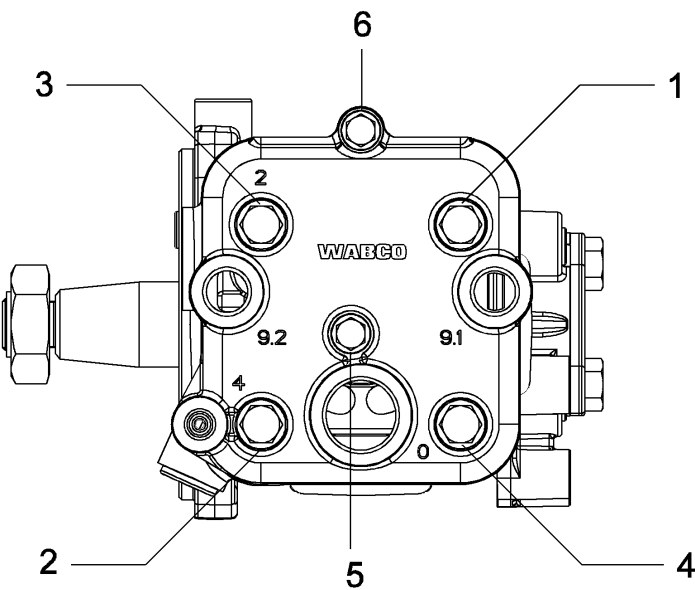

Symbols & Signal Words

- ⚠ DANGER** Description of an immediate situation which will result in irreversible injury or death if the warning is ignored.
- ⚠ WARNING** Description of a possible situation which may result in irreversible injury if the warning is ignored.
- ⚠ CAUTION** Description of a possible situation which may result in irreversible injury or death if the warning is ignored.
- Parts having item numbers with circles are included in the kit.

i Instruction / Information for a correct repair

 The kit can be used for devices according table.

T Tighten element with specified torque or angle of rotation.

NOTE Instruction / Information for a correct repair

General Repair Hints

- Only qualified personnel of a specialist workshop are authorized to perform repair work on a vehicle's security system.
- Absolutely follow specifications and instructions of vehicle manufacturer.
- Keep to company's relevant accident prevention regulations and national regulations.
- Use only spare parts released by WABCO or vehicle manufacturer.
- Always start repair work only when you have read and understood all information required for repair. Documents additionally needed: Test Instruction, Spare Parts List, General Repair and Test Hints (815 010 109 3) to be found on www.wabco-auto.com by entering product number of the device or the publication number in INFORM.
- Check each repaired equipment for functional efficiency and tightness on an adequate facility according to the test instruction.
- WABCO does not accept any liability or responsibility for the quality or functionality of a repaired device

Sequence of assembly

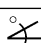
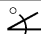
Picture	Symbol	Procedure	Item	Sequence:	Torque:	Rotation angle:	Comments
1+2	T 1	1	3	1, 2, 3, 4	20 ± 2 Nm		Ensure accurate torque at all screws before next step.
1+2		2	3	1, 2, 3, 4		90° +10° / -5°	Carry out the steps of this procedure one after the other
1+2	T 2	3	4	5, 6	6 ± 0.6 Nm		Ensure accurate torque at all screws before next step.
1+2		4	4	5, 6		90° +10° / -0°	Carry out the steps of this procedure one after the other
1+2	i 1		2				Inlet reed will be supplied as loose piece