

NON E' PERMESSO CONSEGNARE A TERZI O RIPRODURRE QUESTO DOCUMENTO NE UTILIZZARNE IL CONTENUTO O RENDERSI RESPONSABILI PER IL CONTENUTO. NE UTILIZZARNE IL CONTENUTO O RIPRODURRE QUESTO DOCUMENTO NE UTILIZZARNE IL CONTENUTO O RENDERSI RESPONSABILI PER IL CONTENUTO. NE UTILIZZARNE IL CONTENUTO O RIPRODURRE QUESTO DOCUMENTO NE UTILIZZARNE IL CONTENUTO O RENDERSI RESPONSABILI PER IL CONTENUTO.

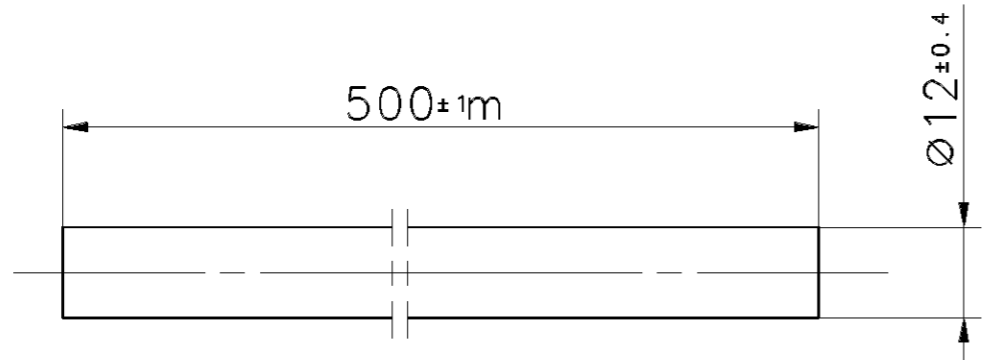

INSULATION
 ISOLATION
 ISOLEMENT
 ISOLAMENTO

PUR

THERMAL RANGE OF APPLICATION
 THERMISCHER ANWENDUNGSBEREICH -40 °C...+100 °C
 PLAGE THERMIQUE D'APPLICATION
 CAMPO DI APPLICAZIONE TERMICA

CORE-COLOUR (IEC 757) ADER-FARBE (IEC 757) CONDUCTEUR-COULEUR (IEC 757) ANIMA-COLORE (IEC 757)	CONDUCTOR CROSS SECTION: LEITERQUERSCHNITT : SECTION DE CONDUCTEUR : SEZIONE DEL CONDUTTORE :
RD	6mm ²
WH/RD	1.5mm ²
BN/BU	1.5mm ²
BN	6mm ²
YE/BU	1.5mm ²

TOUTE COMMUNICATION OU REPRODUCTION DE CE DOCUMENT, TOUTE EXPLOITATION OU COMMUNICATION DE SON CONTENU, SAUF AUTORISATION EXPRESSE, TOUT MANOUEMENT A CETTE REGLE CONSTITUE UN ABUS INDUSTRIEL. TOUT ABUS EST RESERVE. NOTAMMENT EN MATIERE DE BREVETS ET DE MODELES.

GENERAL SPECIFICATION: JED-334																	
FURTHER TECHNICAL DATA:																	
DOC. CODE:	SHEET: TO																
GENERAL TOLERANCES																	
CLASS 1)	RANGE OF NOMINAL DIMENSIONS (± mm)																
	<table border="1"> <tr> <td>≤50</td> <td>> 50 ≤180</td> <td>>180 ≤400</td> <td>>400</td> </tr> <tr> <td>0,5</td> <td>1,0</td> <td>1,5</td> <td>2,0</td> </tr> <tr> <td>1,0</td> <td>2,0</td> <td>3,0</td> <td>4,0</td> </tr> <tr> <td>2,0</td> <td>3,5</td> <td>5,0</td> <td>6,5</td> </tr> </table>	≤50	> 50 ≤180	>180 ≤400	>400	0,5	1,0	1,5	2,0	1,0	2,0	3,0	4,0	2,0	3,5	5,0	6,5
	≤50	> 50 ≤180	>180 ≤400	>400													
	0,5	1,0	1,5	2,0													
1,0	2,0	3,0	4,0														
2,0	3,5	5,0	6,5														
FINE	± 3°																
MEDIUM																	
COARSE																	
TAPPED HOLES ACC. ISO 4039 / JED-152																	
1) TOLERANCE CLASS APPLIED CROSSMARKED	DCN-NO. REV. DATE																

CADAM-DRAWING COPYRIGHT		WABCO	
DATE	SIGNATURE		
DRAWN: 02-04-15 HARNISCHM		CABLE KABEL CABLE CAVO	
CHECKED: 02-04-15 GRUENDKER			
STANDARDIZATION:		PRODUCT IDENTIFICATION NO.	
MASS	SCALE	894 607 291 4	DOC. CODE
135 KG	1:1		605
SIZE	I.R.I.		SHEET
A 3	142		1/1
SHAPE CODE		REPLACEMENT FOR	