

556-03-9087

outlet proprietary information and may not be copied, used or divulged without

is Babco Company, Akron, Ohio, and contains confidential

This drawing and the subject matter therein are the property of the Goodyear Tire & Rubber Company. All designs and all parts or complete copies

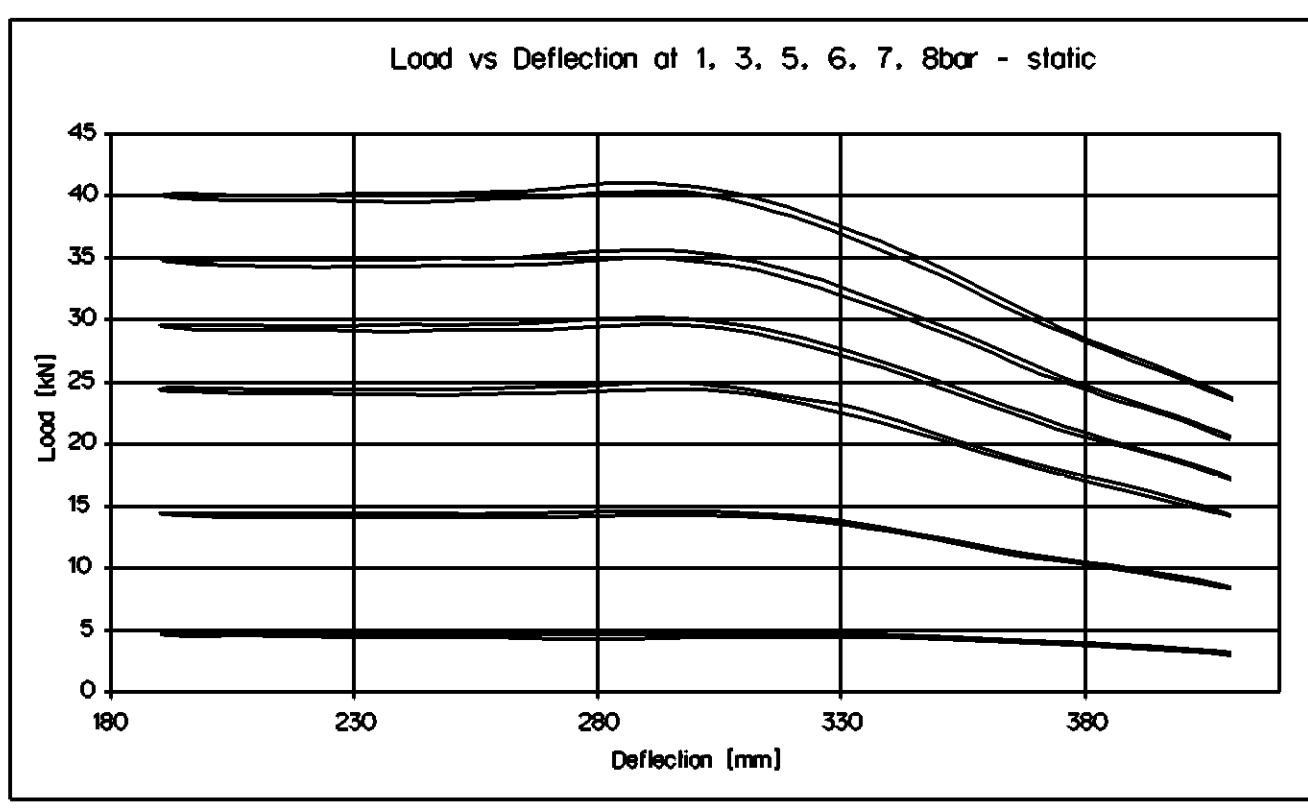
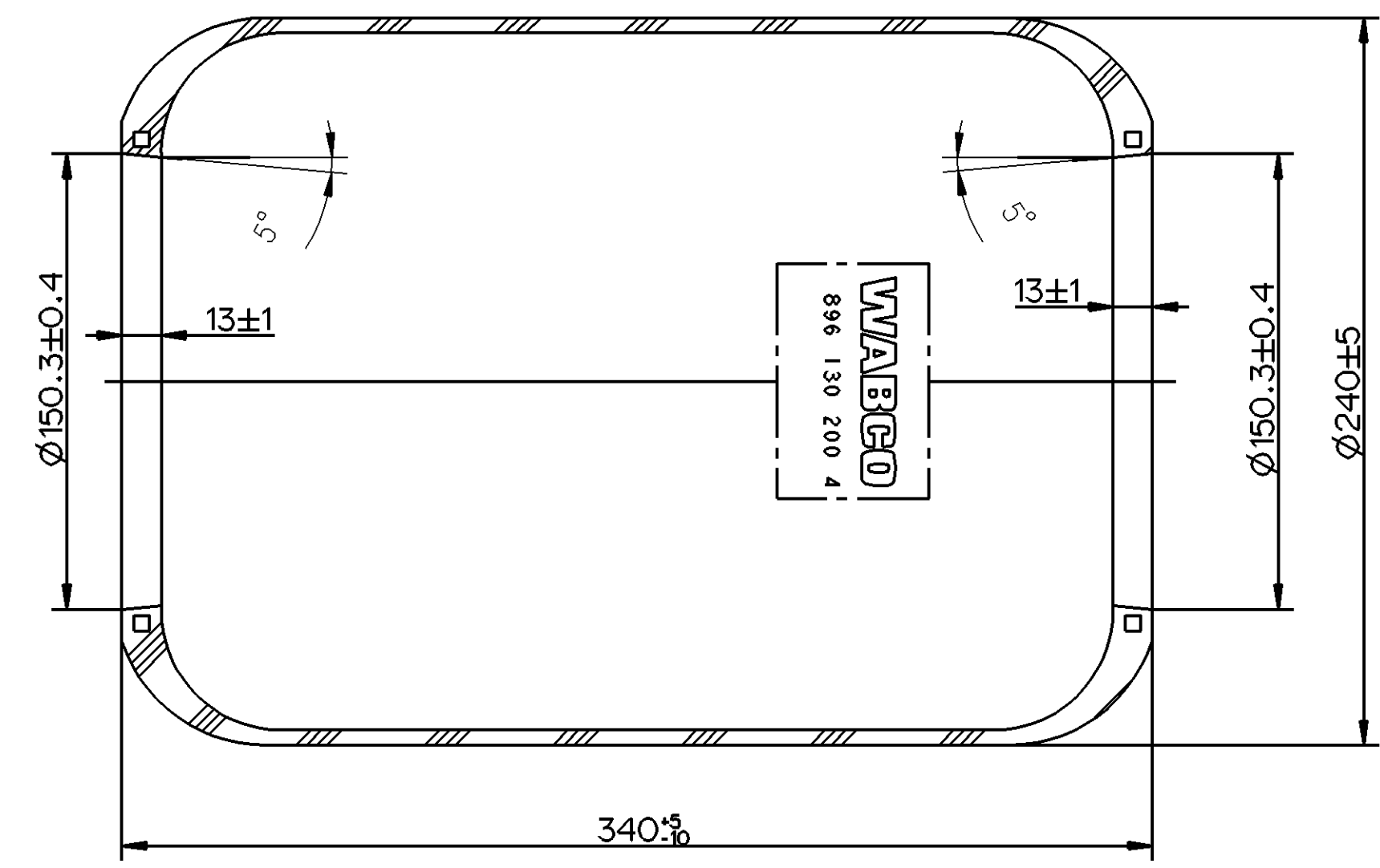
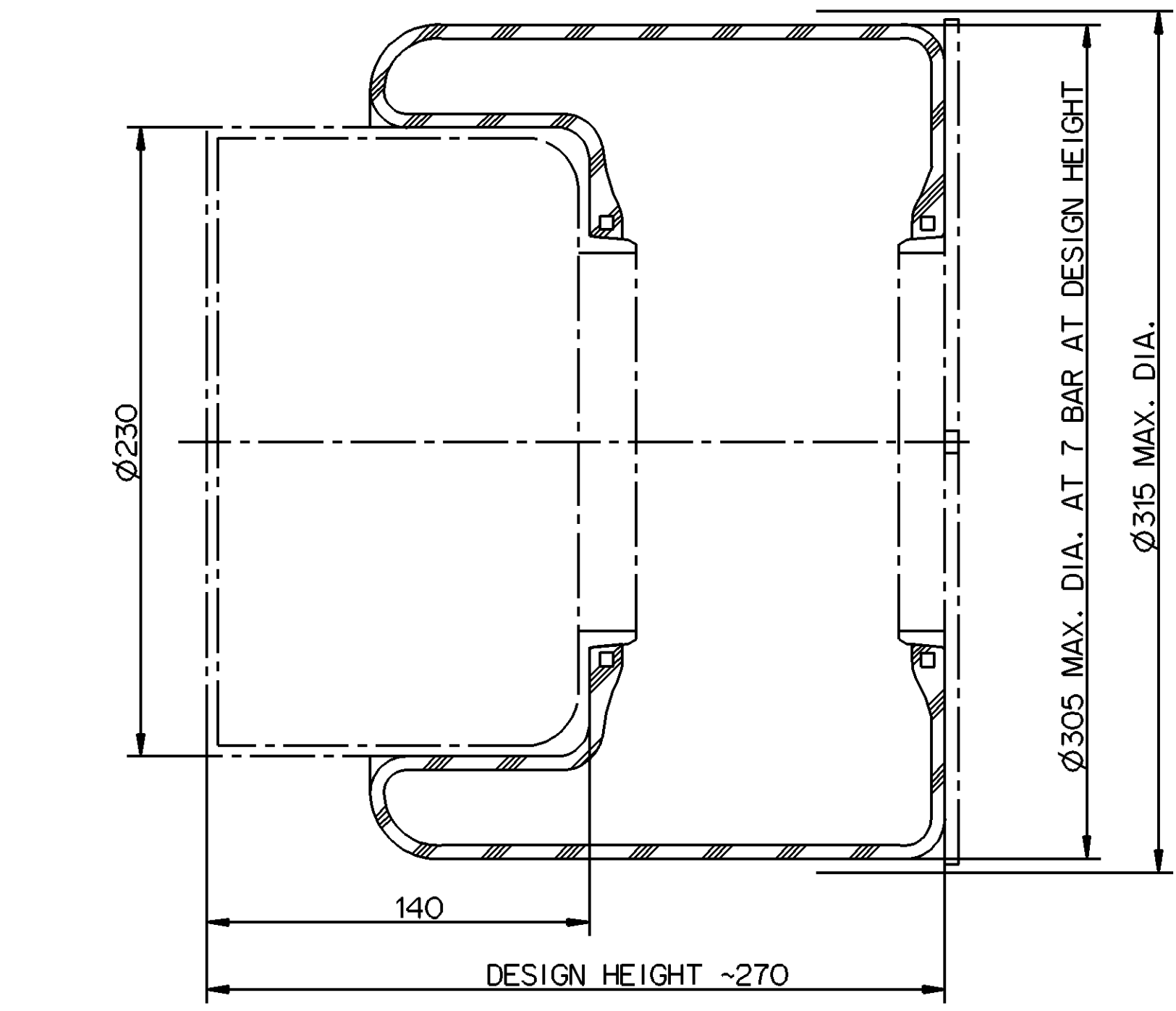

- NOTES:
1. MINIMUM PRESSURE AT MAXIMUM EXTENSION IS NOT TO BE LESS THAN 0.5bar.
 2. ASSEMBLY DESIGNED TO OPERATE BETWEEN -40° AND +70°.
 3. CUSTOMER TO PROVIDE MECHANICAL DEVICE TO LIMIT MAXIMUM EXTENSION TO MAX. EXTENDED HEIGHT.
 4. WARNING: DO NOT INFLATE UNLESS FULLY SECURED IN THE SUSPENSION OR OTHER ADEQUATE STRUCTURE. DO NOT INFLATE TO MORE THAN 7bar AT ANY HEIGHT. OTHERWISE BODILY INJURY COULD RESULT

Revision	Date	Name	Reason, note
01	20.06.09	D. Komic	New Wabco part number

I		FLEXIBLE MEMBER		NR-BR		896 130 200 4	
Poz. No.	Object and dimension	Page	Material	Drawing no.	standard	Note	
2006	Date	Name	Signature	 GOODYEAR ENGINEERED PRODUCTS EUROPE <small>Trade na preloženju: goodyear_tehniskih_izdavača_d.o.o.</small>			
Designed	18.05.	J. Rebernik					
Checked	18.05.	M. Kosir					
Approved	18.05.	M. Kosir					
Scale: 1:2(A2)		Weight(kg): 1,7	Belong to: AIR SPRINGS	Projection	Drawing number: 556-03-9087		
Title: WABCO 896 130 200 4 (GY 556-03-8015)				Revision: 01 20.06.2009			

Toute communication de reproduction de ce document, toute explication ou communication de son contenu sont interdites, sauf autorisation écrite de la direction des ventes et marketing de Goodyear Engineering Europe. Toute violation de ces conditions sera poursuivie devant les tribunaux compétents.

General Specifications: JED-334-0		Copyright WABCO®	
Further Technical Data:		Date	Signature
Doc. Code:	Sheet: To	2009-07-22	Josinski
General Tolerances JED-261		Checked	Hlodk
Range of Nominal Dimensions (± mm)		Expert	
Class 1)	< 50 > 50 > 180 > 400	B. Bosinski	
Fine	0,5 1,0 1,5 2,0	Material No. 896 130 200 4	
Medium	1,0 2,0 3,0 4,0	Date of first issue: 2009-07-22	Doc.Code Language Sheet
Coarse	2,0 3,5 5,0 6,5	005 EN 1/1	
Tapped Holes acc.:		Size CAD System	ECN No. Revision Techn. Resp. Replacement for
1) Tolerance Class Applied Crossmarked		A 1 Pro/E	6960