

--- = SHAPE OF ENGINE MOTOR KONTUR

TORQUE ANZUGSMOMENT COUPLE DE SERRAGE COPPIA DI SERRAGGIO 200 Nm

* WITH INSERT MIT GEWINDEINSATZ (HELI COIL) AVEC FILET RAPPORTE CON INSERTO

- 9.1 = COOLANT CONNECTION KUEHLMITTELANSCHLUSS CONNEXION DE FLUIDE DE REFRIGERISSEMENT COLLEGAMENTO LIQUIDO REFRIGERANTE
- 9.2 DIRECTIONS OF FLOW DURCHSTROMRICHTUNGEN SENS DE PASSAGE SENSO DI FLUSSO
- 8.1 = OIL SUPPLY DRUCKOELANSCHLUSS ORIFICE D'ARRIVEE D'HUILE ORIFIZIO D'ARRIVO OLIO
- 8.2 = OIL DRAIN OELRUECKLAUF RETOUR D'HUILE RITORNO OLIO
- 0 = INLET PORT SAUGANSCHLUSS ASPIRATION ASPIRAZIONE
- 2 = DISCHARGE PORT DRUCKANSCHLUSS REFUELEMENT COMPRESIONE

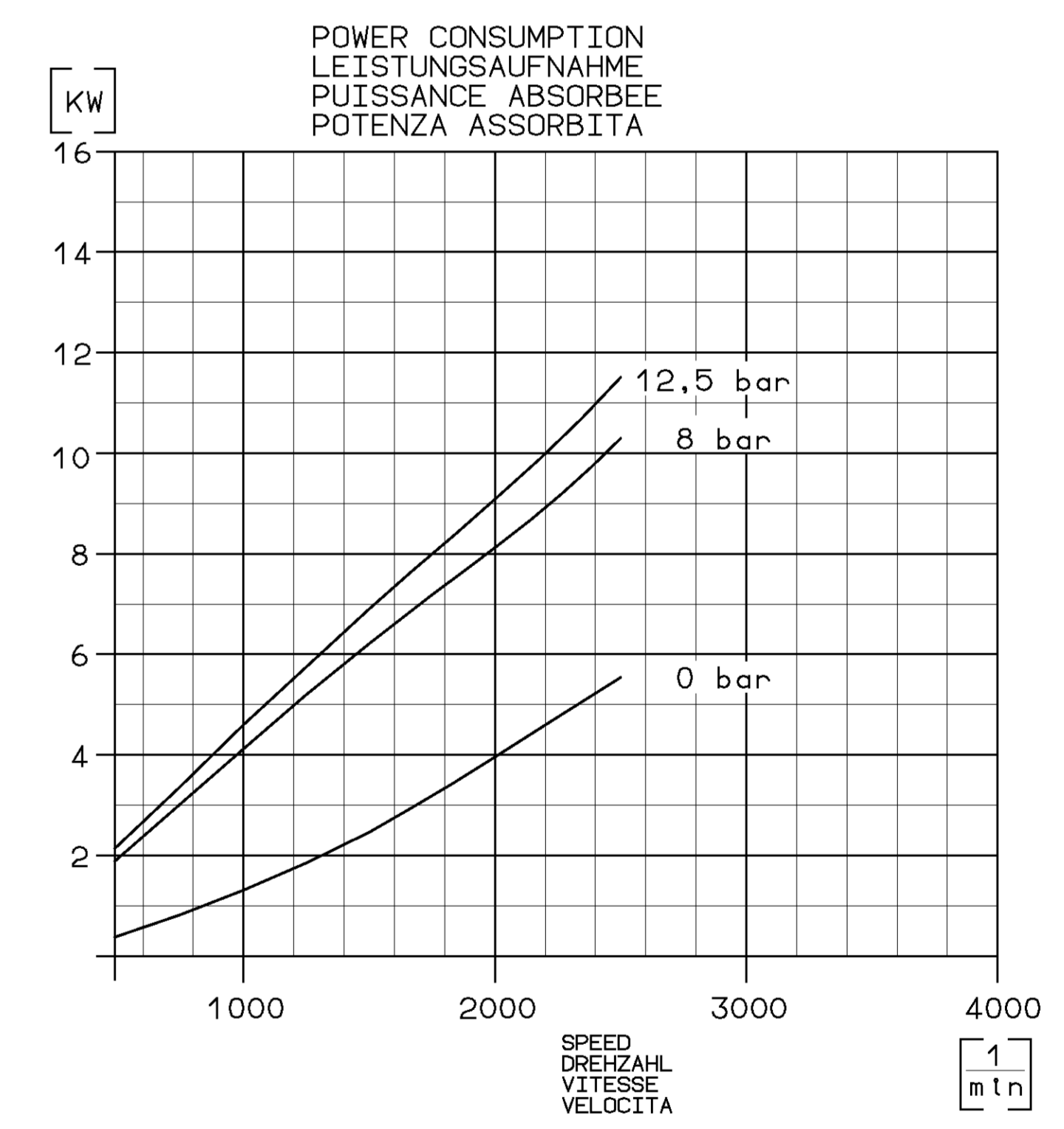
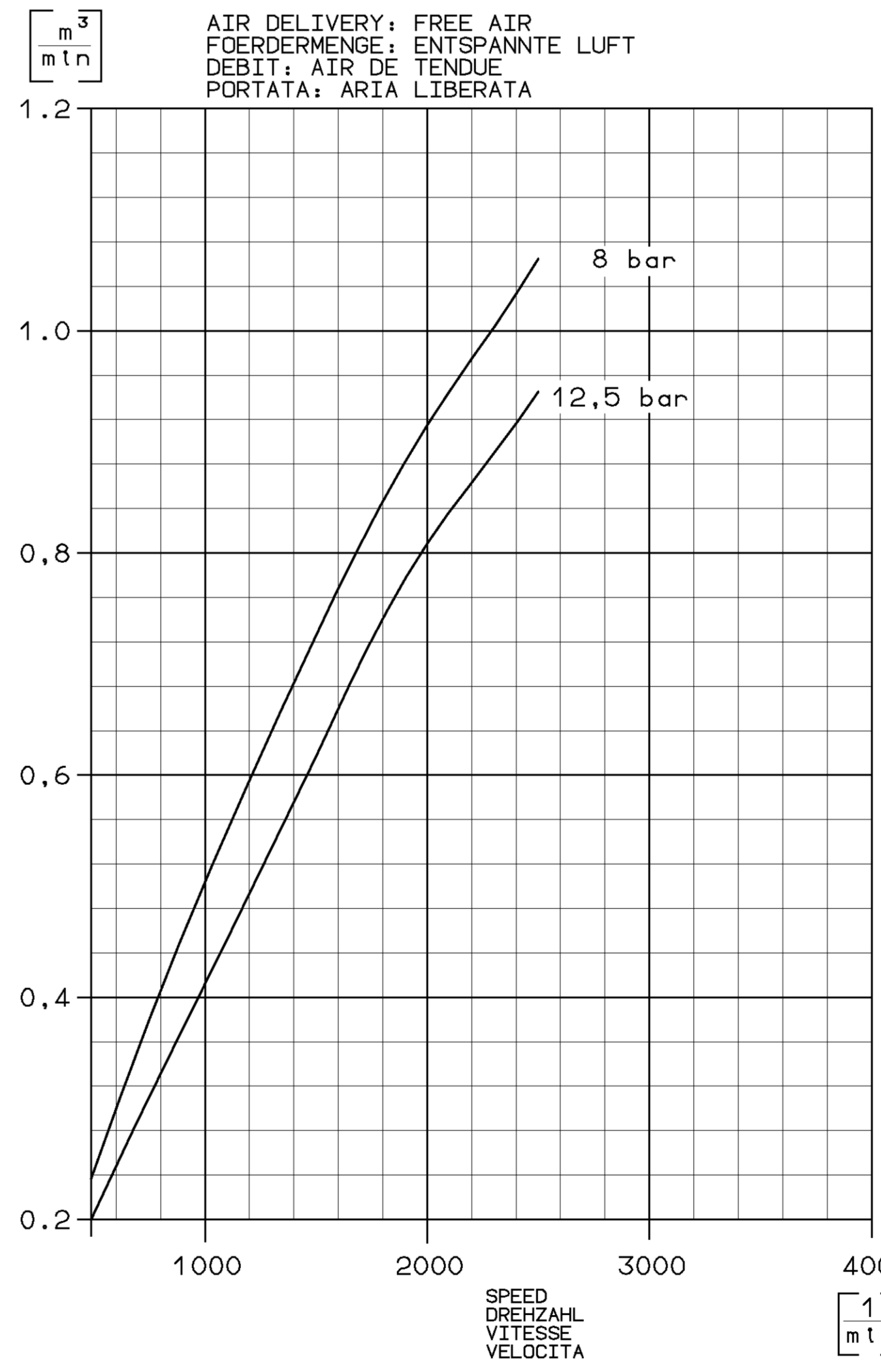
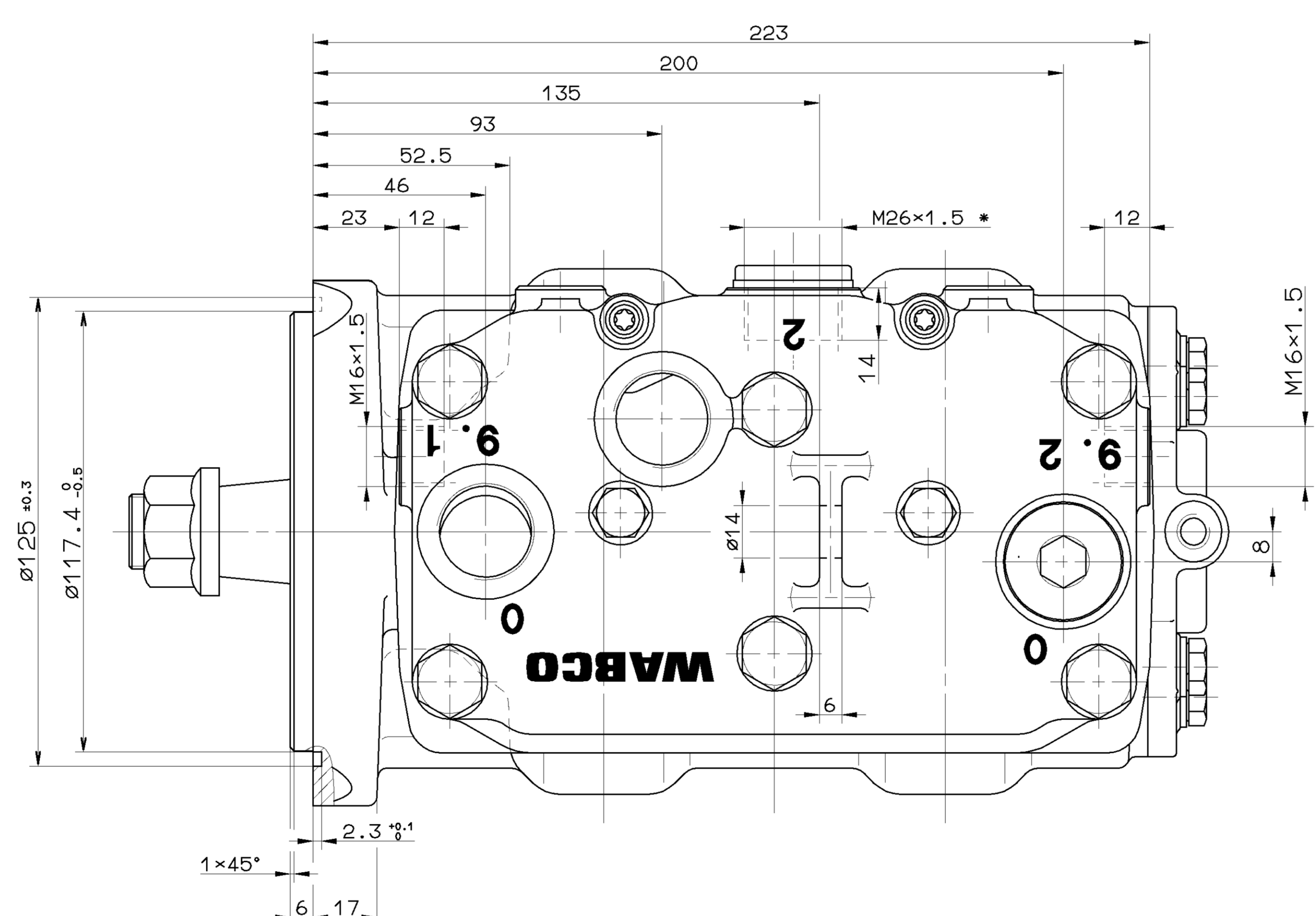

PORTS AND SHAFTEND PROTECTED ANSCHLUESSE UND WELLENENDE GESCHUETZT

TECHNICAL DATA TECHNISCHE DATEN CARACTERISTIQUES TECHNIQUES CARATTERISTICHE TECNICHE

BORE: BOHRUNG: ALESAGE: ALESAGGIO:	Ø85 mm	OVERSPEED (TEMPORARY MAX. 4 SEC.): LIEBERDREHZAH (KURZZEITIG MAX. 4 SEC.): SURVITESSE (DE COURTE DUREE MAXI. 4 SEC.): SOVRVELOCITA (BREVE TEMPO SOLO MAX. 4 SEC.):	$n_{us} = 1.3 \times n_{max}$
STROKE: HUB: COURSE: CORSA:	62 mm	MAX. WORKING PRESSURE: MAX. BETRIEBSDRUCK: PRESSION D'UTILISATION MAXI.: PRESSIONE DI ESERCIZIO MAXI.:	$p_{max} = 12.5 \text{ bar}$
SWEPT VOLUME: HYBRAUM: CYLINDREE: CYLINDRATA:	704 cm³	LUBRICATION: LUBRICATION SUPPLIED FROM ENGINE SCHMIERART: UMLAUFSCHMIERUNG MIT DRUCKOELANSCHLUSS (UD) GRAISSAGE: GRAISSAGE PAR CIRCULATION ALIMENTATION PAR LE MOTEUR LUBRIFICAZIONE: LUBRIFICAZIONE A CIRCOLAZIONE ALIMENTAZIONE DAL MOTORE	
MAX. WORKING SPEED: MAX. BETRIEBSDREHZAH: VITESSE D'UTILISATION MAXI.: VELOCITA DI ESERCIZIO MAXI.:	$n_{max} = 2400 \frac{1}{min}$	WITH WATER - COOLING REQUIRED QUANTITY COOLING WATER BEI WASSERKUEHLUNG ERFORDERLICHE KUEHLWASSERMENGE AVEC REFRIGERISSEMENT PAR EAU QUANTITE D'EAU NECESSAIRE CON RAFFREDDAMENTO AD ACQUA QUANTITA D'ACQUA NECESSARIA	6 L/min

MAX. PERMISSIBLE TILT DURING CONTINUOUS WORKING: MAX. ZULAESSIGE NEIGUNG IM DAUERBETRIEB; INCLINAISON MAX. ADMISE EN SERVICE CONTINU; MASSIMA INCLINAZIONE AMMESSA IN CASO DI SERVIZIO CONTINUO:

END PLAY OF CRANKSHAFT: AXIALSPIEL DER KURBELWELLE: JEU AXIAL DU VILEBREQUIN; GIOCO ASSIALE DELL'ALBERO A GOMITO:

MAX. PERMISSIBLE PRESSURE PORT TEMPERATURE IN SERVICE MAX. ZULAESSIGE DRUCKSTUTZENTEMPERATUR WAEREND DES FAHRBETRIEBES 220° C TEMPERATURE DE REFUELEMENT MAX. ADMISSIBLE EN SERVICE TEMPERATURA DI COMPRESIONE MAX. AMMISSIBLE IN SERVIZIO

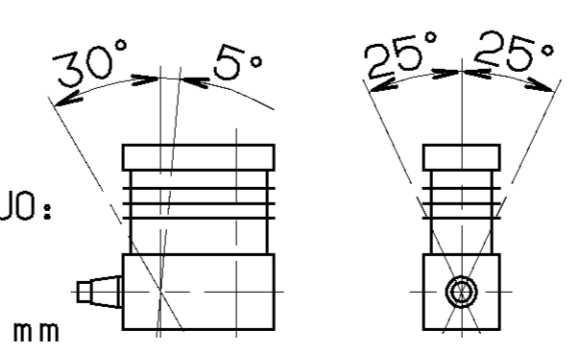

GENERAL SPECIFICATION: 95-234	DATE: 94-04-29	DESIGNER: BRUNS	PRODUCT IDENTIFICATION NO.: 911 505 150 7
SHEET: 10	DATE: 94-04-29	DESIGNER: KRAMER	DOC. CODE: 605
CLASS: 1	DATE: 94-04-29	DESIGNER: PANTZER	SHEET: 1
RANGE OF NOMINAL DIMENSIONS (mm): 500, 510, 520, 530, 540, 550	DATE: 95-12-16	DESIGNER: 17	SCALE: 1:1
DATE: 95-09-05	DATE: 95-03-20	DATE: 95-03-20	SCALE: 1:1