

CUSTOMER NO.: 906 130 68 15 0080
AND "ZDS" NO.: 001 STAMPED
KUNDEN-NR.: 906 130 68 15 0080
UND "ZGS" NR.: 001 GESTEMPELT

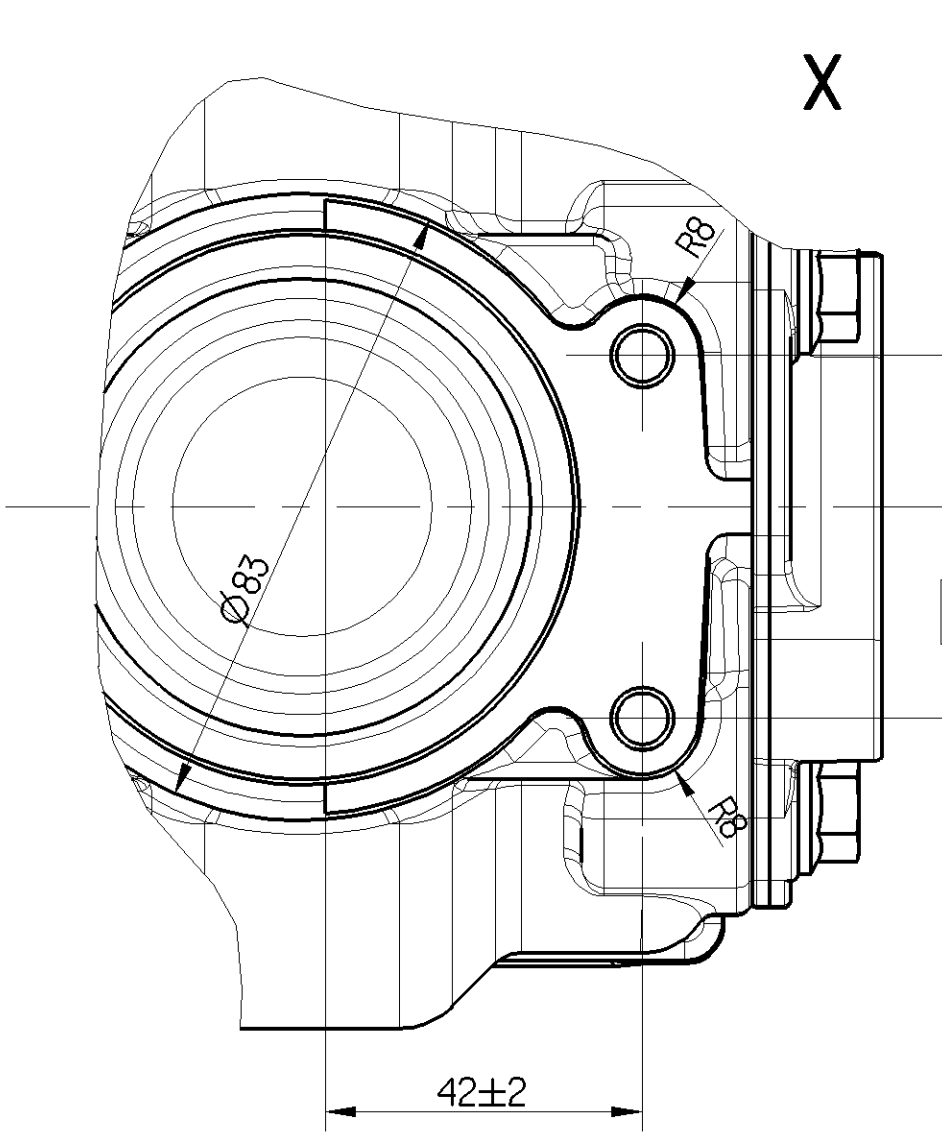
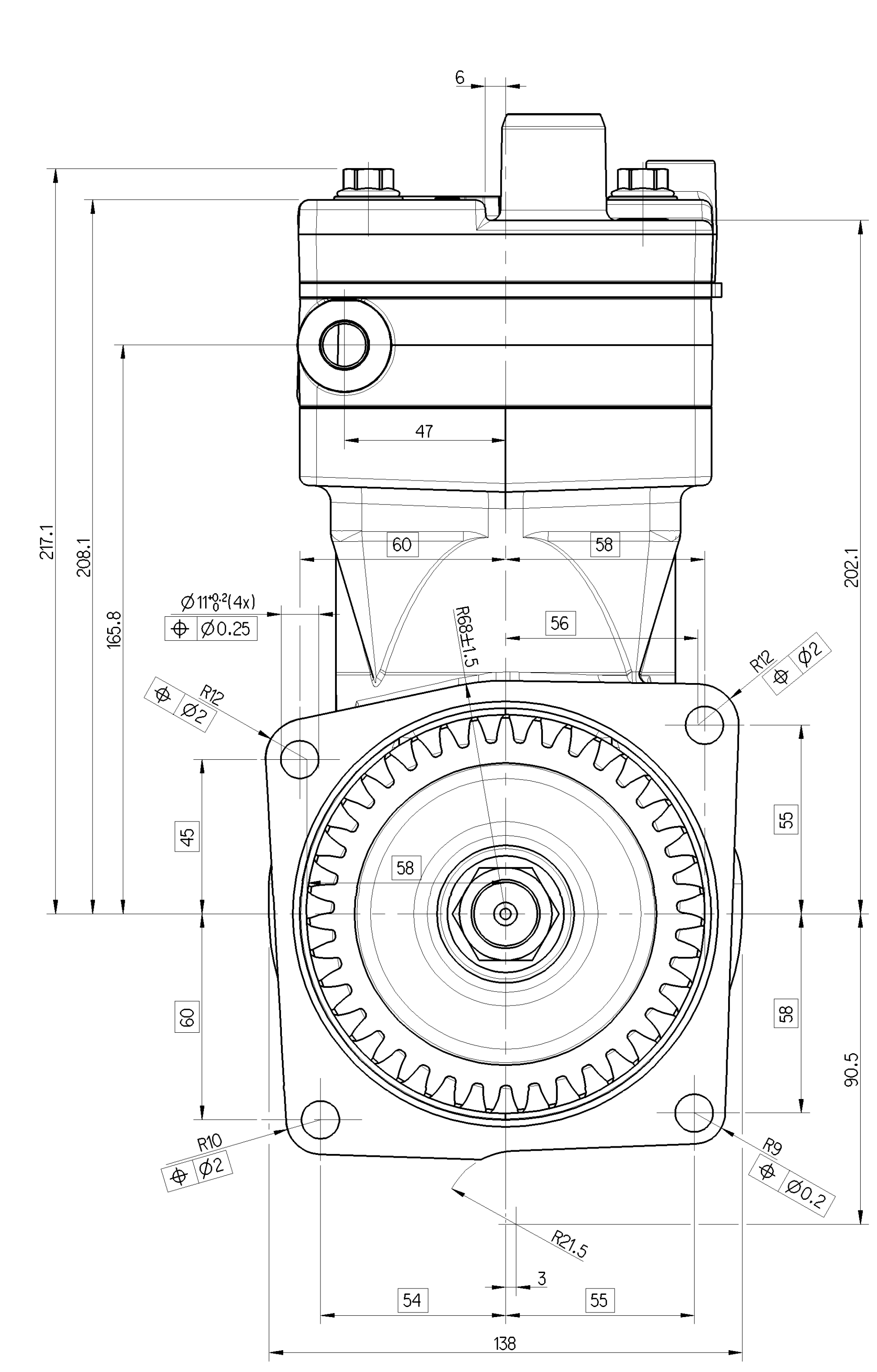
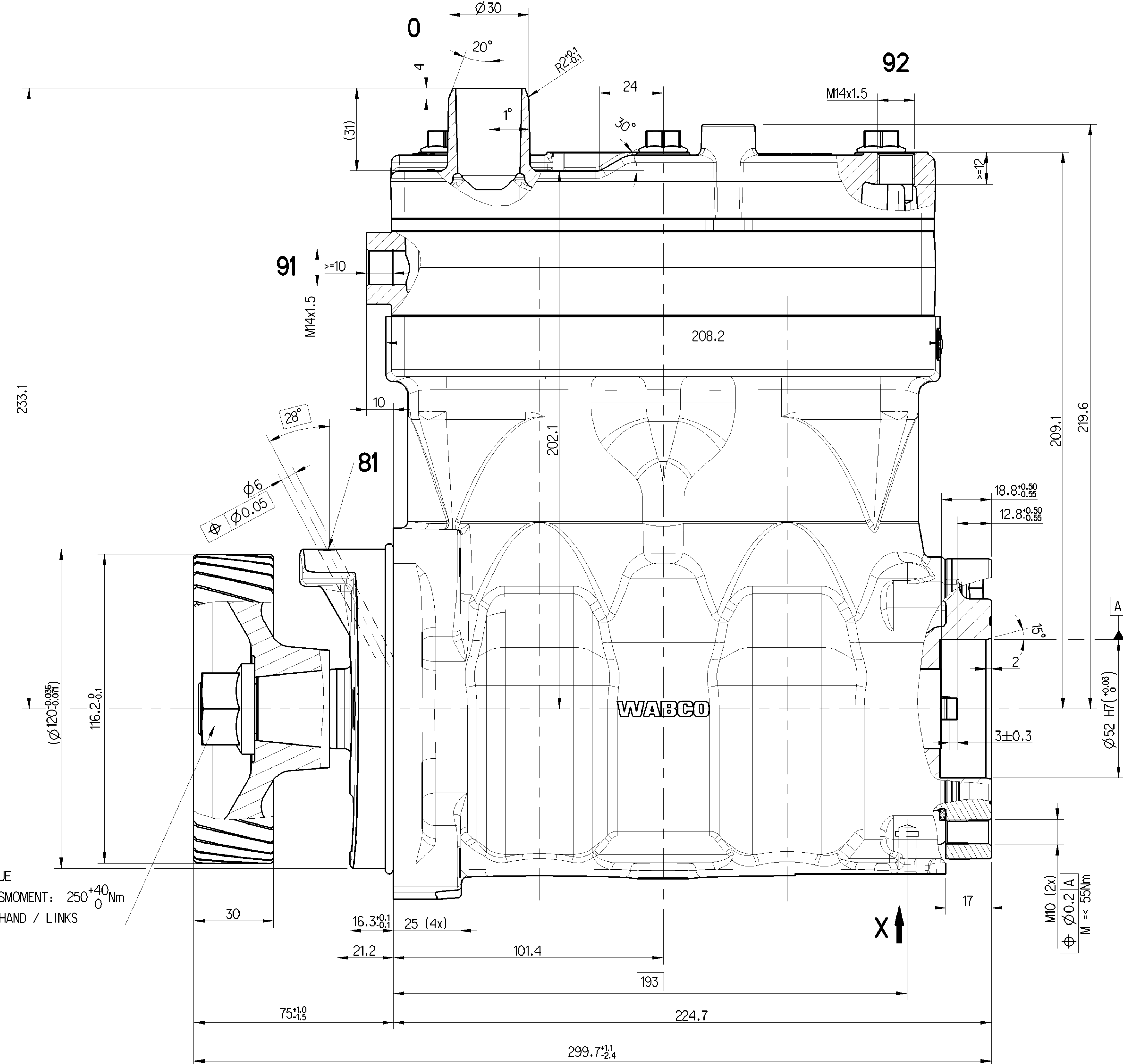
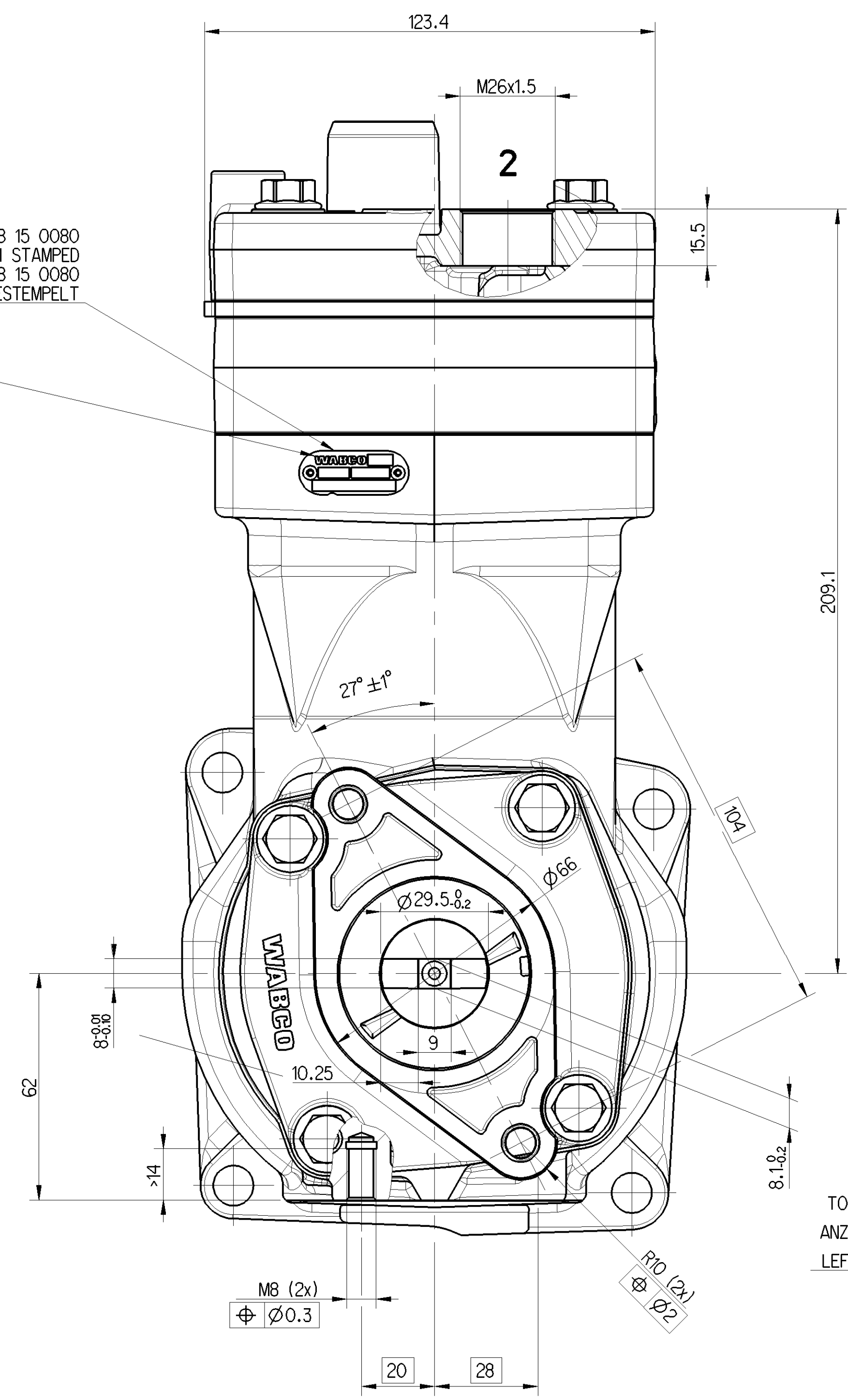
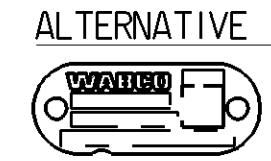

WORKING MEDIUM
BETRIEBSMEDIUM : AIR
LUFT
COOLANT
KUEHLMEDIUM : WATER WITH ANTIFREEZE
WASSER MIT FROSTSCHUTZ
BORE
BOHRUNG : Ø 85 mm
STROKE
HUB : 56 mm
SWEEP VOLUME
HUBRAUM : 636 cm³
MAX. WORKING SPEED
MAX. BETRIEBSDREHZAHL : n_{max} = 3000 min⁻¹
OVERSPEED (TEMPORARILY < 4 Sek.)
UEBERDREHZAHL (KURZZEITIG < 4 Sek.) : n_{ue} = 1.3 x n_{max}
MAX. WORKING PRESSURE
MAX. BETRIEBSDRUCK : p_e = 12.5 bar
MAX. PRSSURE
HOECHSTDRUCK : p_e = 16 bar *

* MEASURING POINT : DISCHARGE PORT
MESSPUNKT : DRUCKANSCHLUSS

END PLAY OF CRANKSHAFT
AXIALSPIEL DER KURBELWELLE : 0.08...0.38 mm
LUBRICATION : LUBRICATION SUPPLIED FROM ENGINE
SCHMIERART : UMLAUFSCHMIERUNG MIT DRUCKKOEHLANSCHLUSS
FREE FROM ASBESTOS
ASBESTFREI

(...) AUXILIARY DIMENSION
HILFSSMASS

PORTS PROTECTED
ANSCHLUESSE GESCHUETZT

MAX. PERMISSIBLE TILT DURING CONTINUOUS WORKING
MAX. ZULAESSIGE NEIGUNG IM DAUERBETRIEB

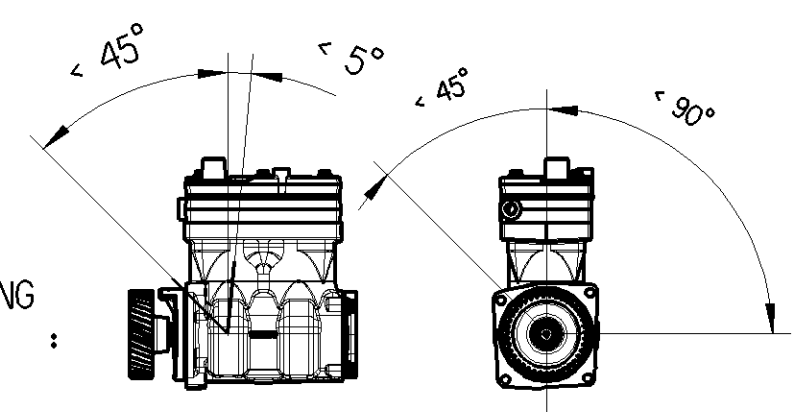

CRANKCASE : SURFACE PROTECTION JED-069M1 (OPTIONAL)
KURBELGEHAUSE : OBERFLAECHENSCHUTZ JED-069M1 (WAHLWEISE)

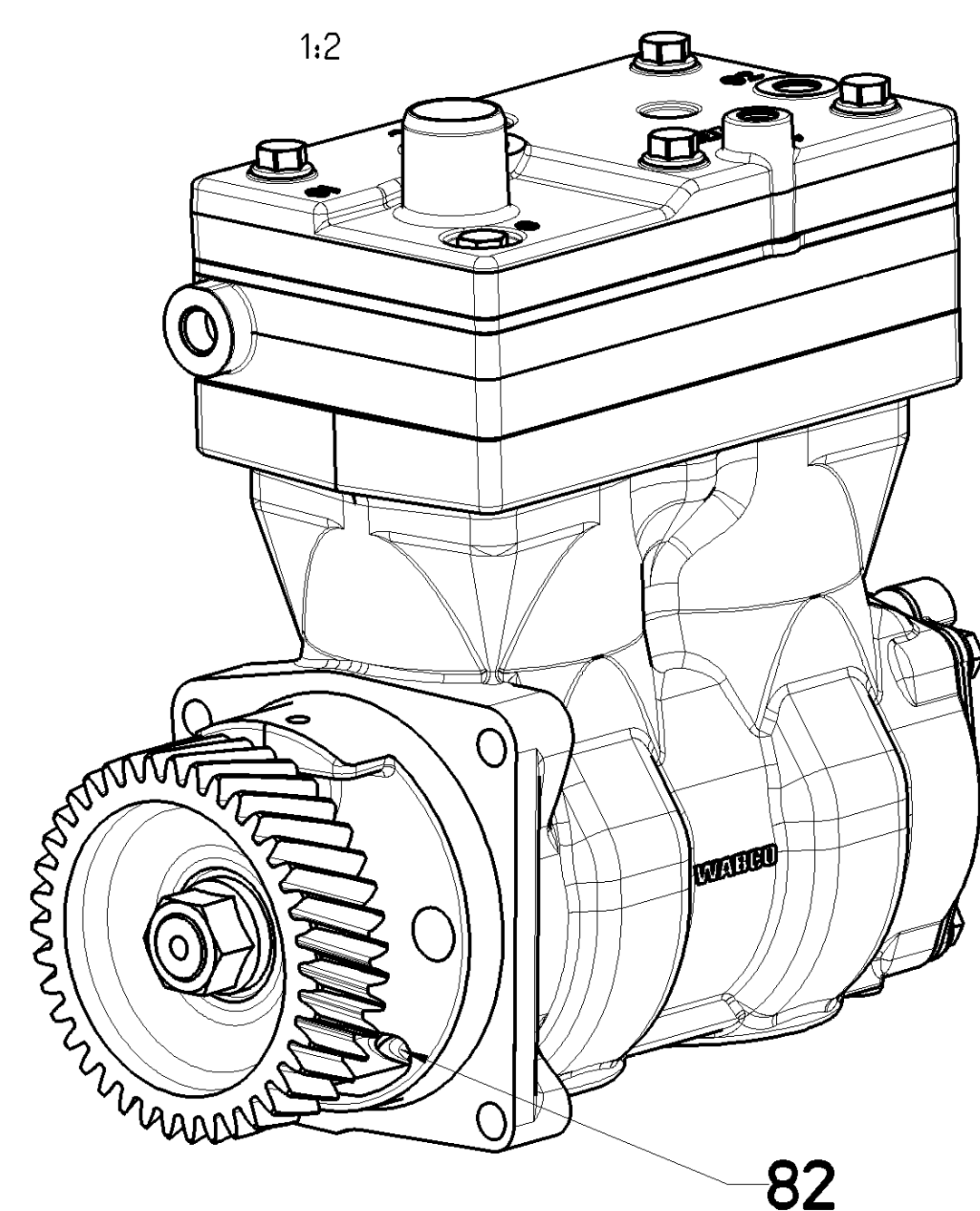
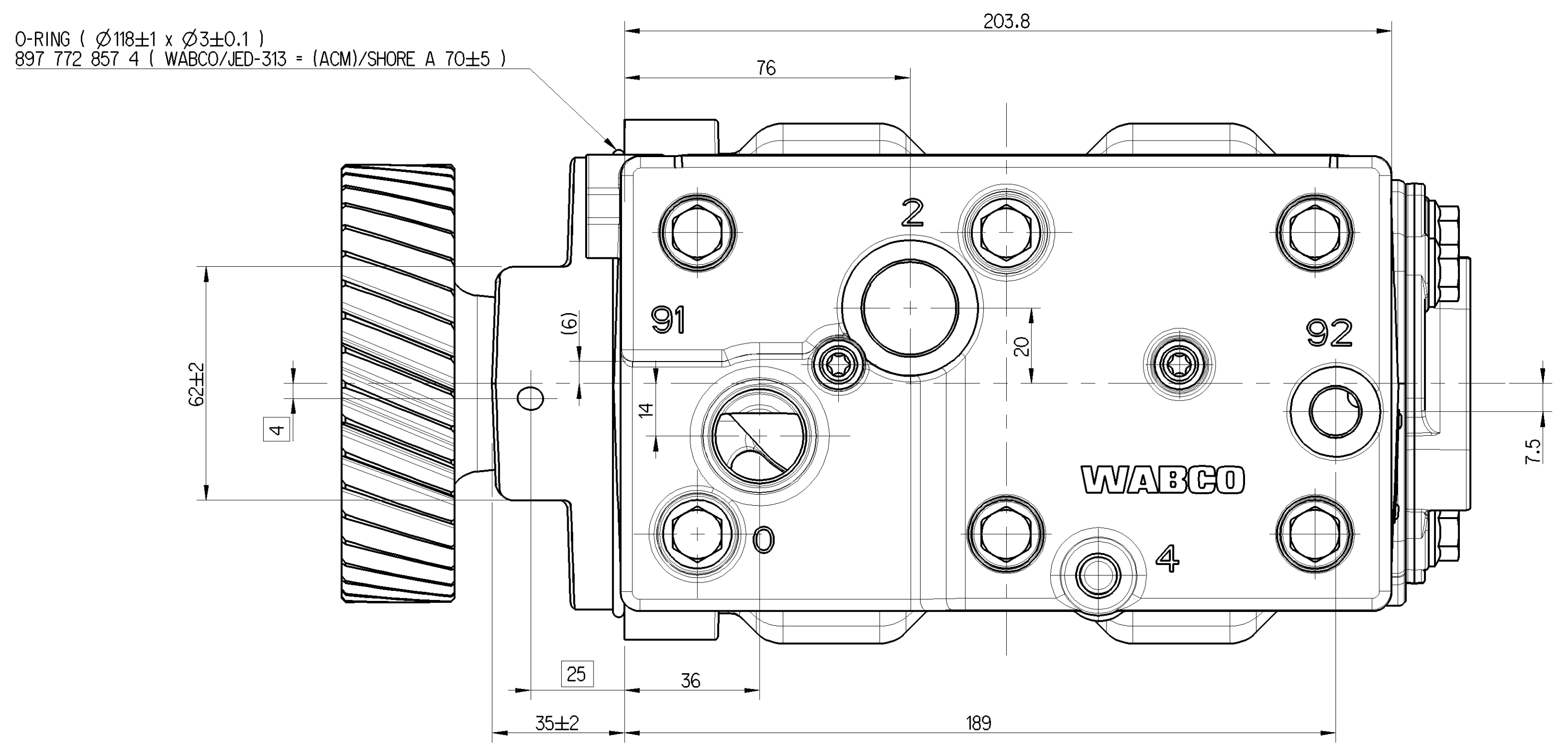

- 0 = INLET PORT
SAUGANSCHLUSS
- 2 = DISCHARGE PORT
DRUCKANSCHLUSS M : < 100 Nm
- 81 = OIL SUPPLY
DRUCKKOEHLANSCHLUSS
- 82 = OIL DRAIN
OELRUECKLAUF
- 91 = COOLANT CONNECTION
KUEHLMITTELANSCHLUSS M : < 35 Nm
- 92 = DIRECTIONS OF FLOW
DURCHSTROMERICHTUNGEN

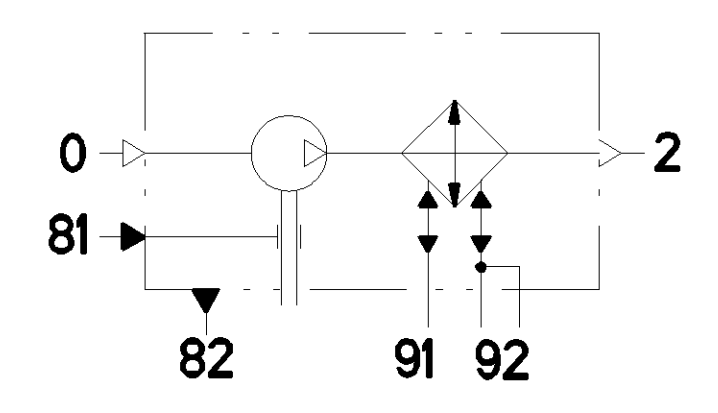
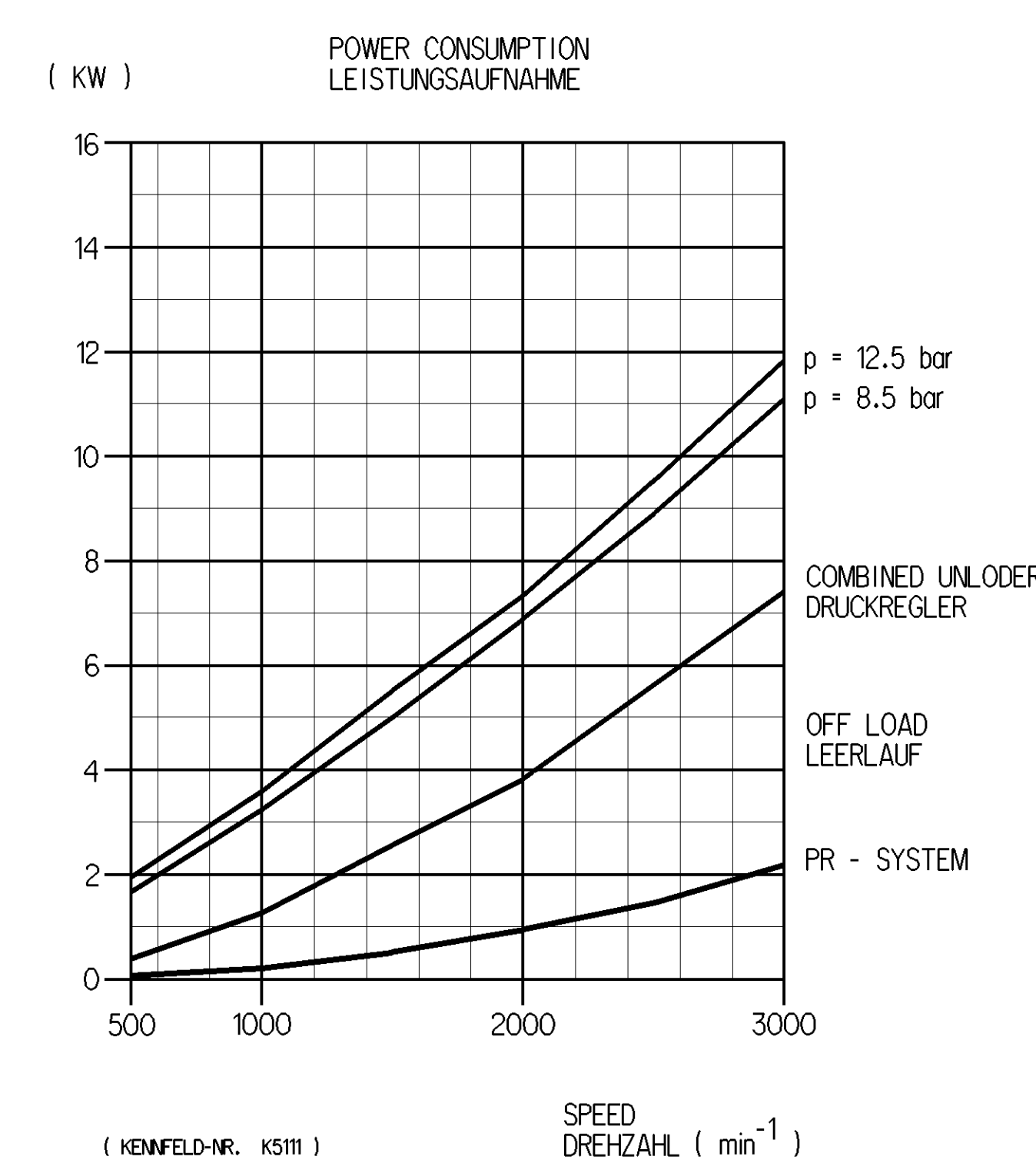
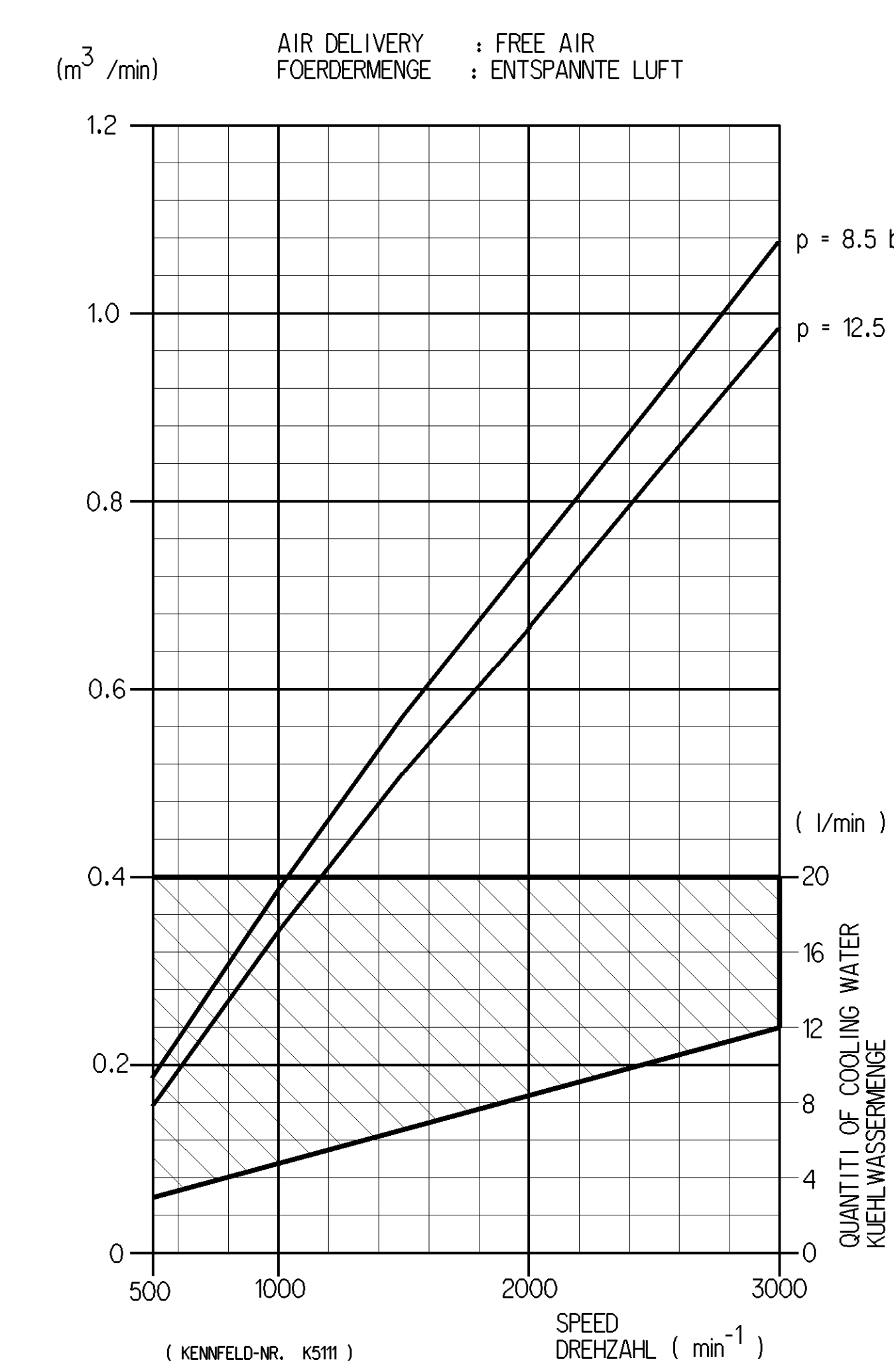

General Specifications: JED-554-1, Size ISO 14400 LP		Copyright WABCO®		WABCO	
Further Technical Data:		Date: 2016-11-28		Revision: 005	
Doc. Code: 912 510 005 R		Drawn: Olivero		Checked: Layman	
General Tolerance: JED-261		Date: 2016-11-28		Location: ...	
Range of Nominal Dimensions L (± mm)		Scale: 1:1		Medium No.: 006 ML 1/1	
Class	to ± 50	± 180	± 400	± 800	± 1600
Medium	0.5	1.0	1.5	2.0	3.0
Coarse	1.0	2.0	3.0	4.0	6.5
Size	2.0	3.5	5.0	6.5	10.0
Tapped Holes acc. JED-102		Material: ...		Preparation for: ...	
Tolerance class: H7/g8		Scale: 1:1		Date: 2016-11-28	