

WORKING MEDIUM : AIR
 BETRIEBSMEDIUM : LUFT
 COOLANT : WATER WITH ANTIFREEZE
 KUEHLMEDIUM : WASSER MIT FROSTSCHUTZ

BORE : $\varnothing 85 \text{ mm}$
 BOHRUNG : $\varnothing 85 \text{ mm}$
 STROKE : 56 mm
 HUB : 56 mm
 SWEEP VOLUME : 636 cm^3
 HILFRAUM : 636 cm^3
 MAX. WORKING SPEED : $n_{\text{max}} = 1250 \text{ min}^{-1}$
 MAX. BETRIEBSDREHZAHL : $n_{\text{max}} = 1250 \text{ min}^{-1}$
 OVERSPEED (TEMPORARILY < 4 Sec.) : $n_{\text{UB}} = 1.3 \times n_{\text{max}}$
 UEBERDREHZAHL (KURZZEITIG < 4 Sek.) : $n_{\text{UB}} = 1.3 \times n_{\text{max}}$
 MAX. WORKING PRESSURE : $p_e = 10 \text{ bar}$
 MAX. BETRIEBSDRUCK : $p_e = 10 \text{ bar}$
 MAX. PRSSURE HOECHSTDRUCK : $p_e = 12.5 \text{ bar}^*$
 * MEASURING POINT : DISCHARGE PORT
 MESSPUNKT : DRUCKANSCHLUSS

END PLAY OF CRANKSHAFT : 0.02...0.05 mm
 AXIALSPIEL DER KURBELWELLE : 0.02...0.05 mm
 LUBRICATION : LUBRICATION SUPPLIED FROM ENGINE
 SCHMIERART : UMLAUFSCHEMUNG MIT DRUCKOELANSCHLUSS

(...) AUXILIARY DIMENSION
 HILFSSMASS

PORTS PROTECTED
 ANSCHLUESSE GESCHUTZT

MAX. PERMISSIBLE TILT DURING CONTINUOUS WORKING
 MAX. ZULAESSIGE NEIGUNG IM DAUERBETRIEB :

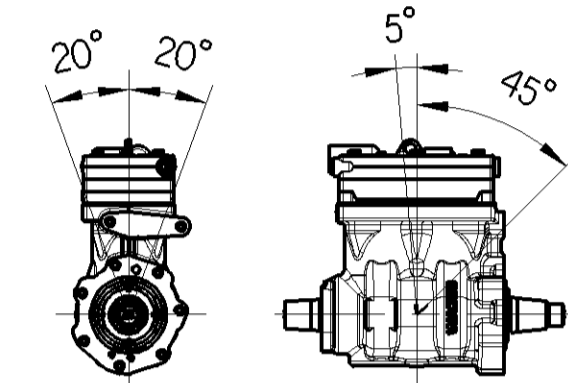

- 0 = INLET PORT
 SAUGANSCHLUSS M : < 100 Nm
- 2 = DISCHARGE PORT
 DRUCKANSCHLUSS M : < 100 Nm
- 8.1 = OIL SUPPLY
 DRUCKOELANSCHLUSS
- 8.2 = OIL DRAIN
 OELRUECKLAUF
- 9.1 = COOLANT CONNECTION
 KUEHLMITTELANSCHLUSS
- 9.2 = DISCHARGE PORT
 DRUCKANSCHLUSS
- 9.1/9.2 DIRECTIONS OF FLOW
 DURCHSTROMRICHTUNGEN M < 35 Nm

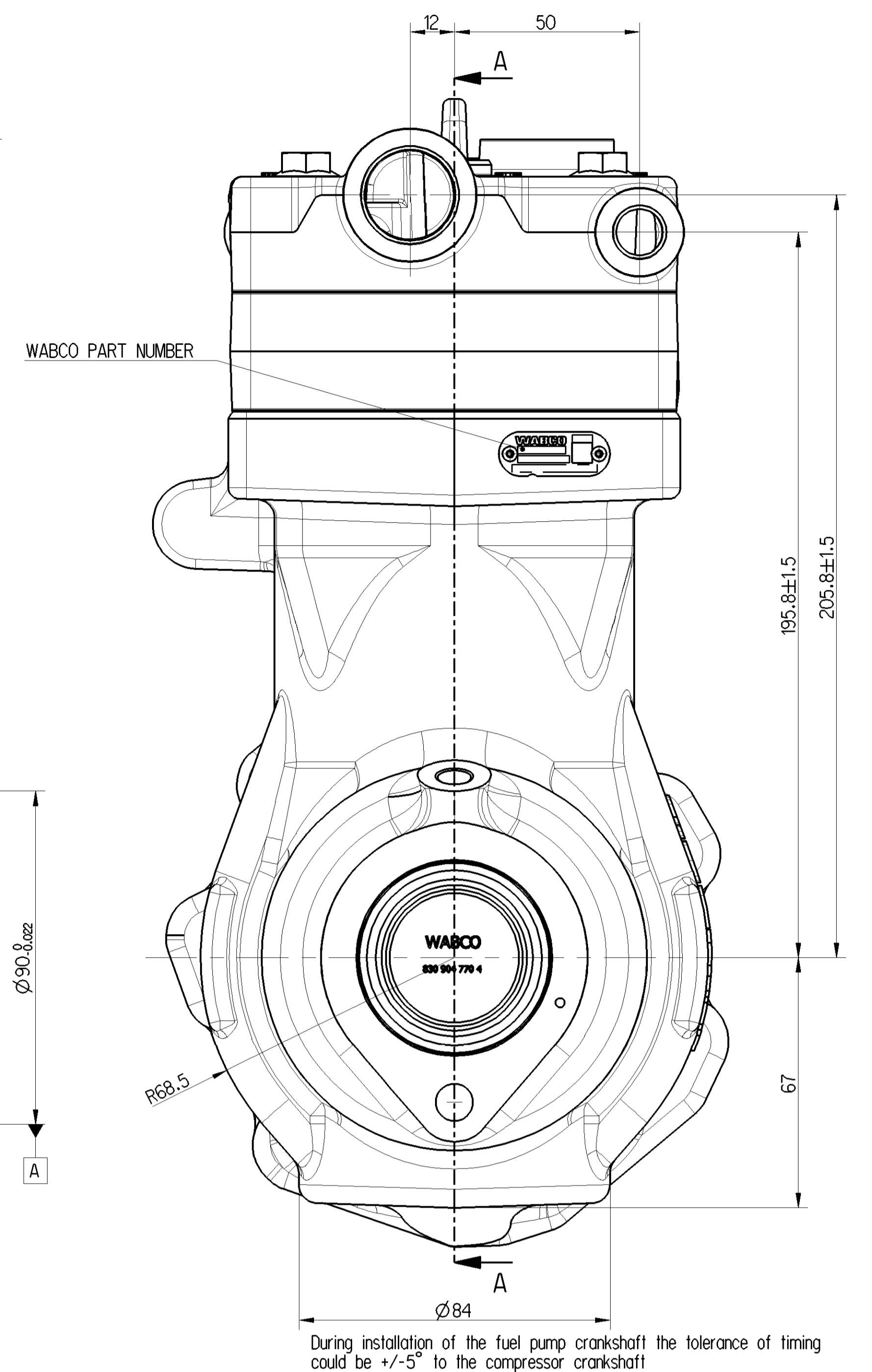
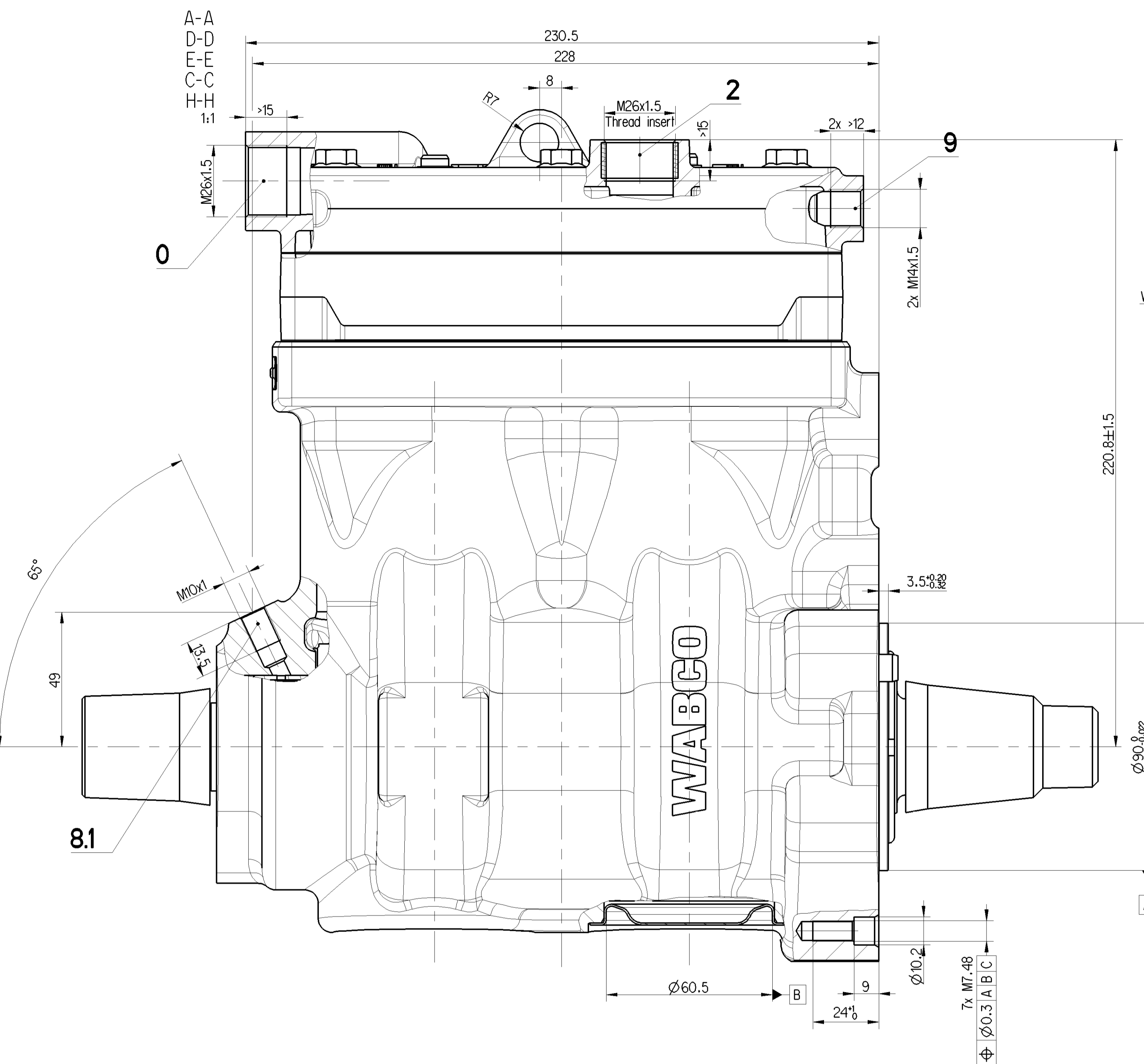
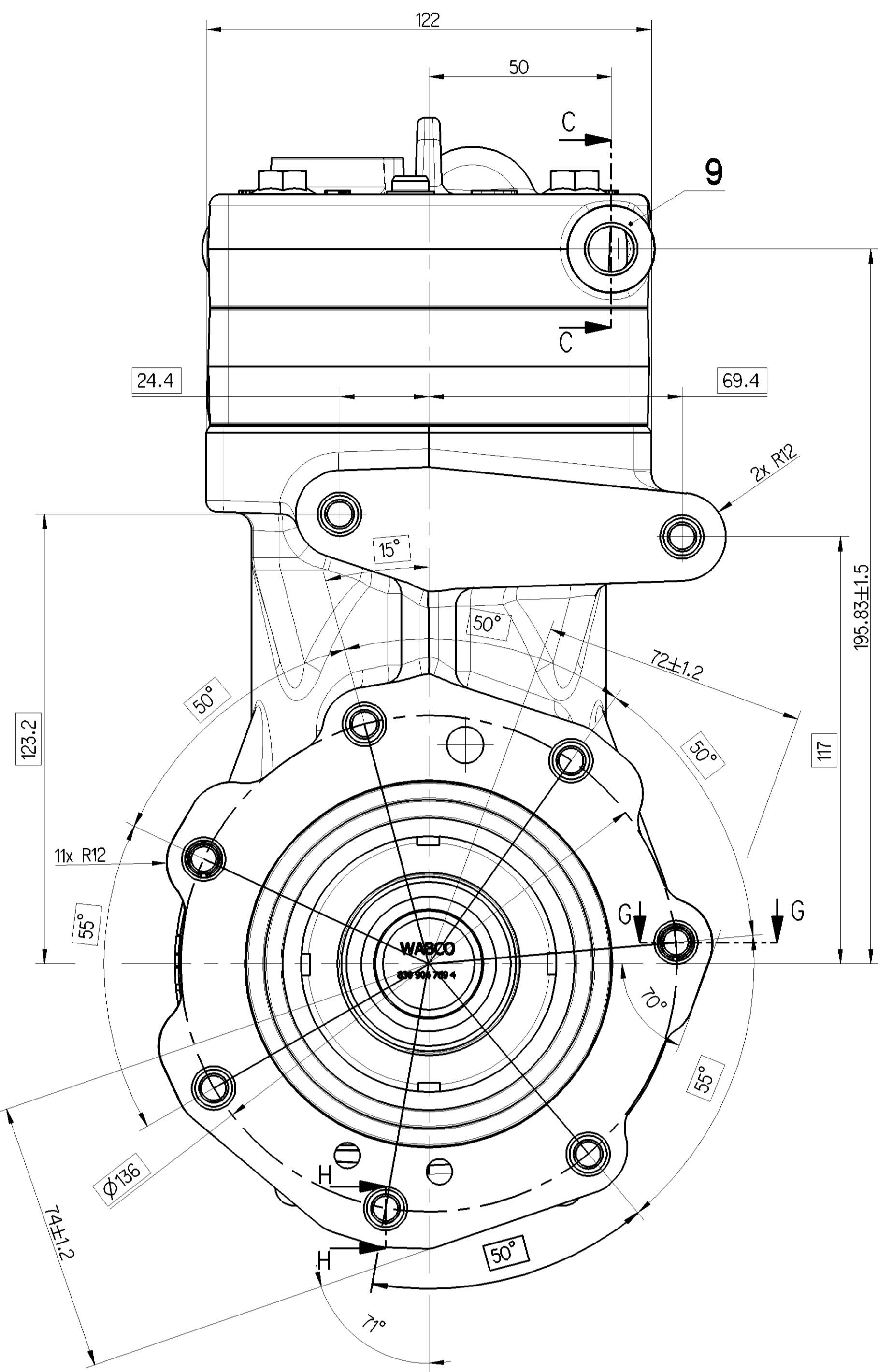
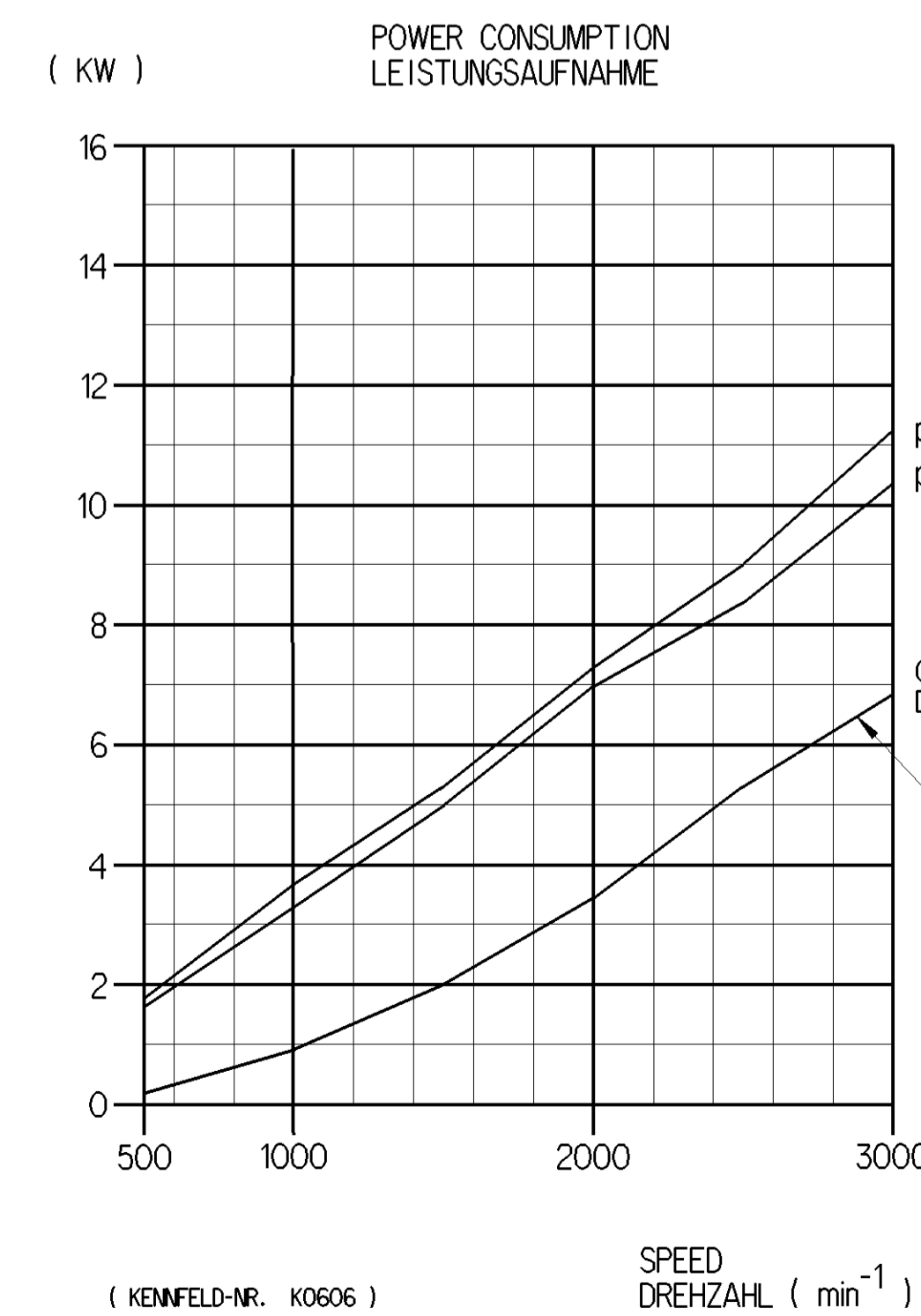
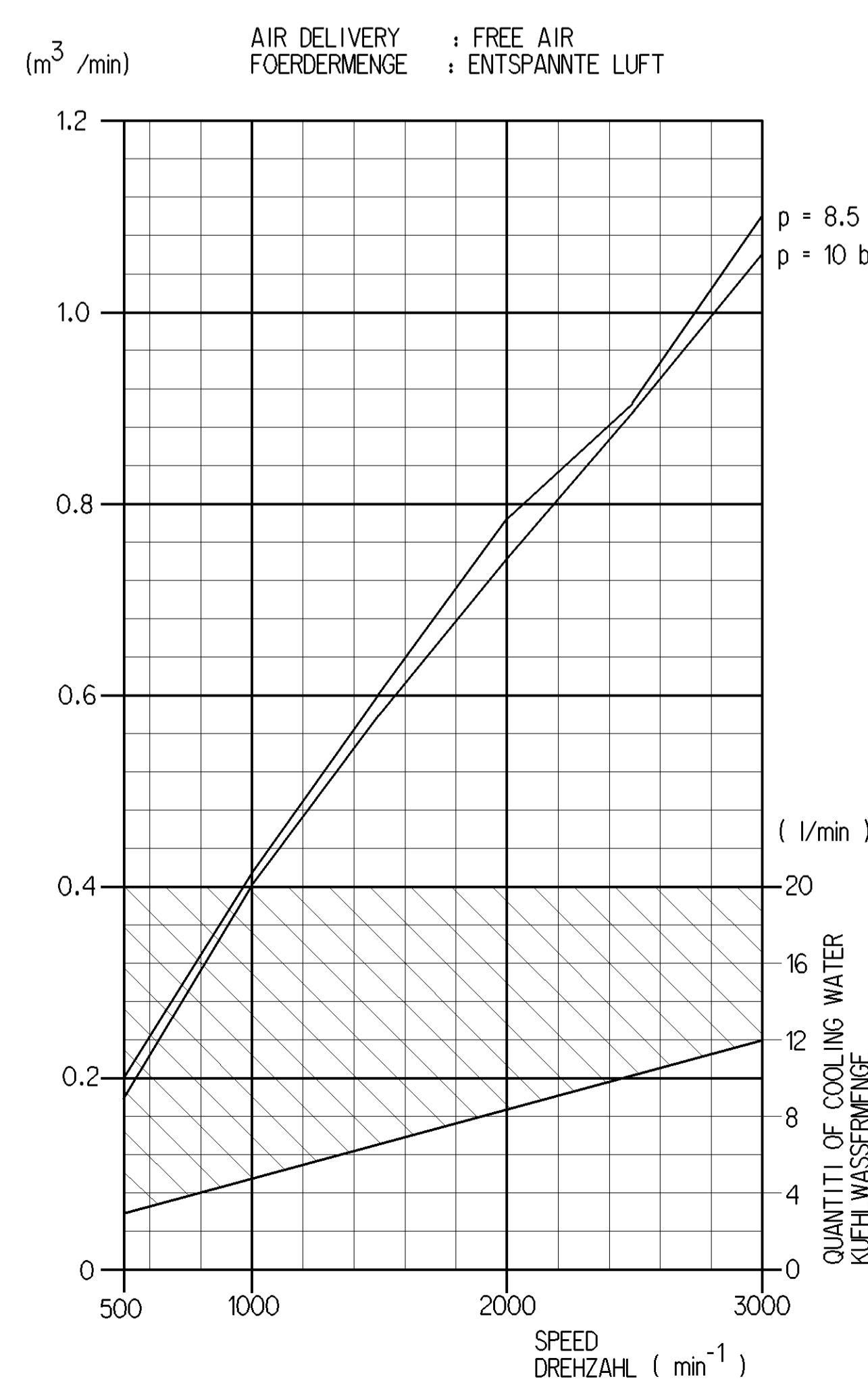
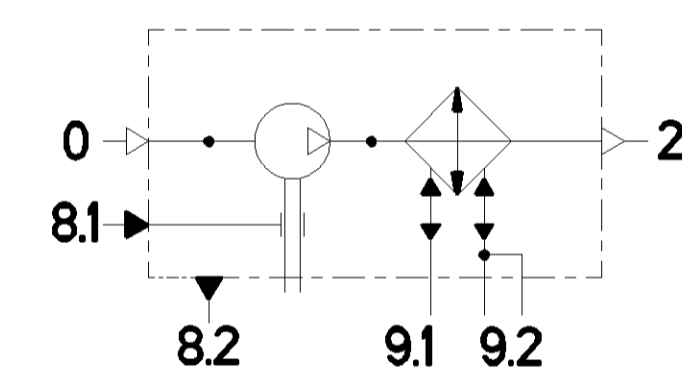

During installation of the fuel pump crankshaft the tolerance of timing could be +/- 5° to the compressor crankshaft

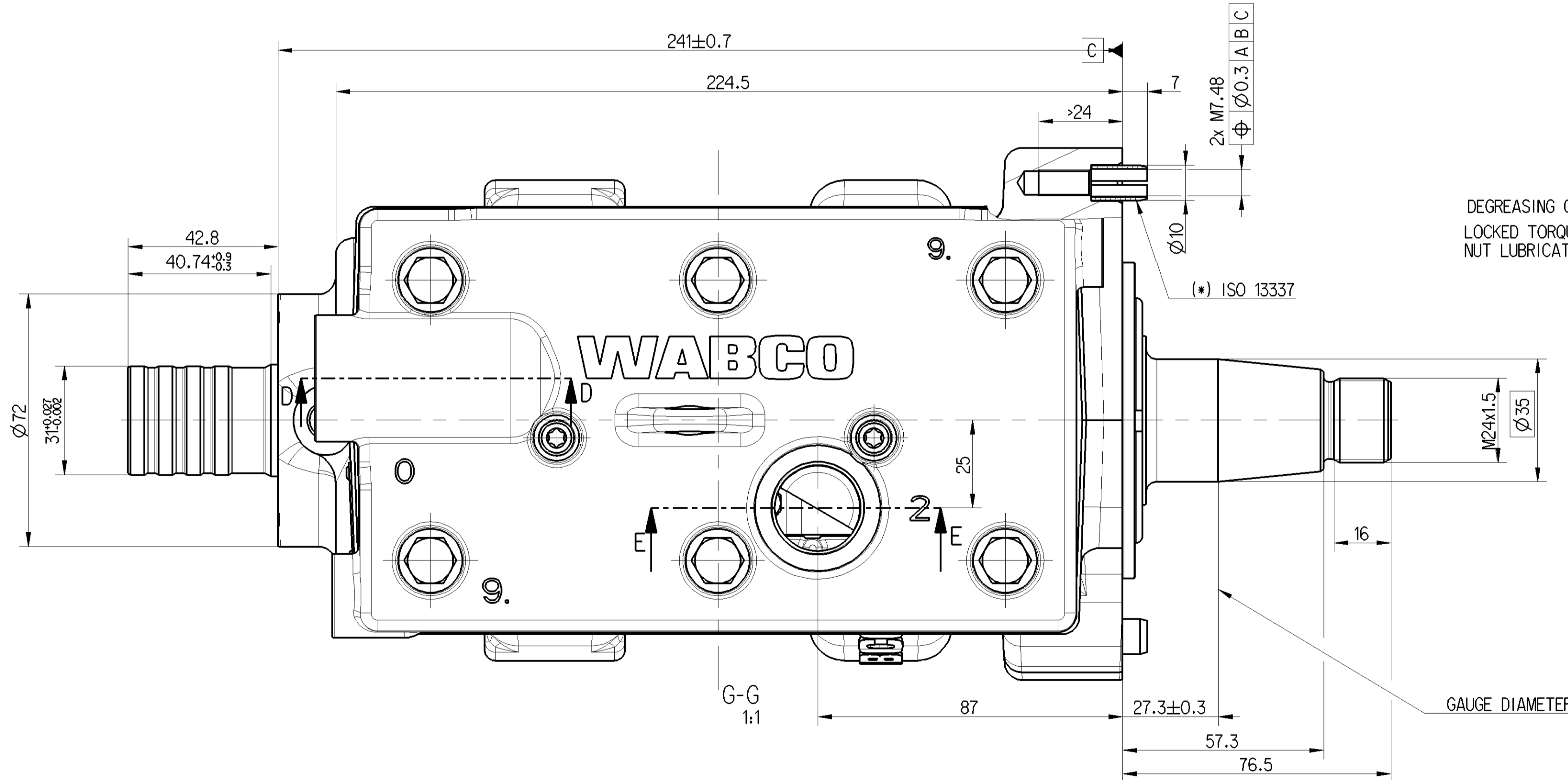
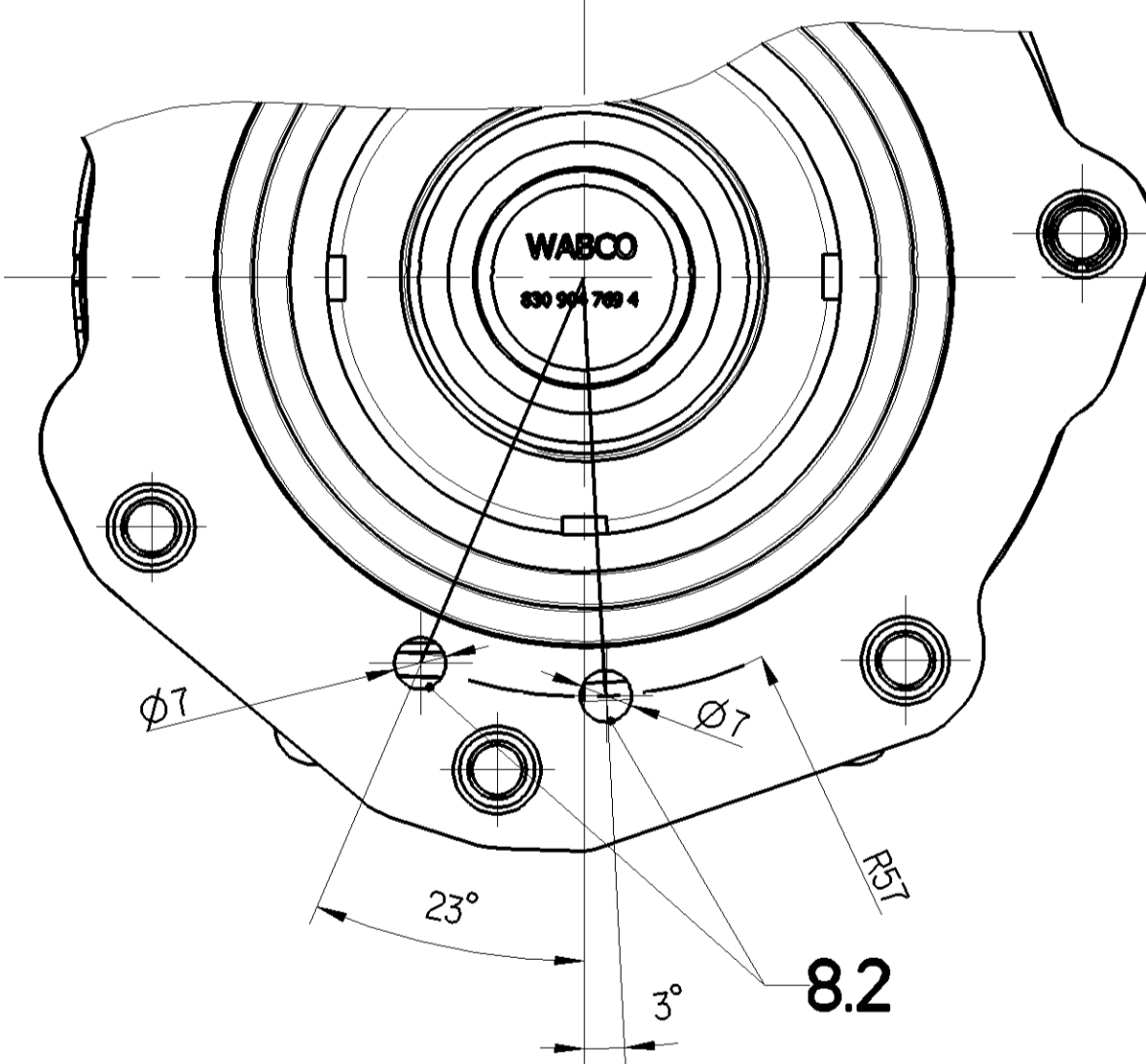

DEGREASING CONE
 LOCKED TORQUE OF THE NUT: 400 Nm
 NUT LUBRICATE WITH OIL

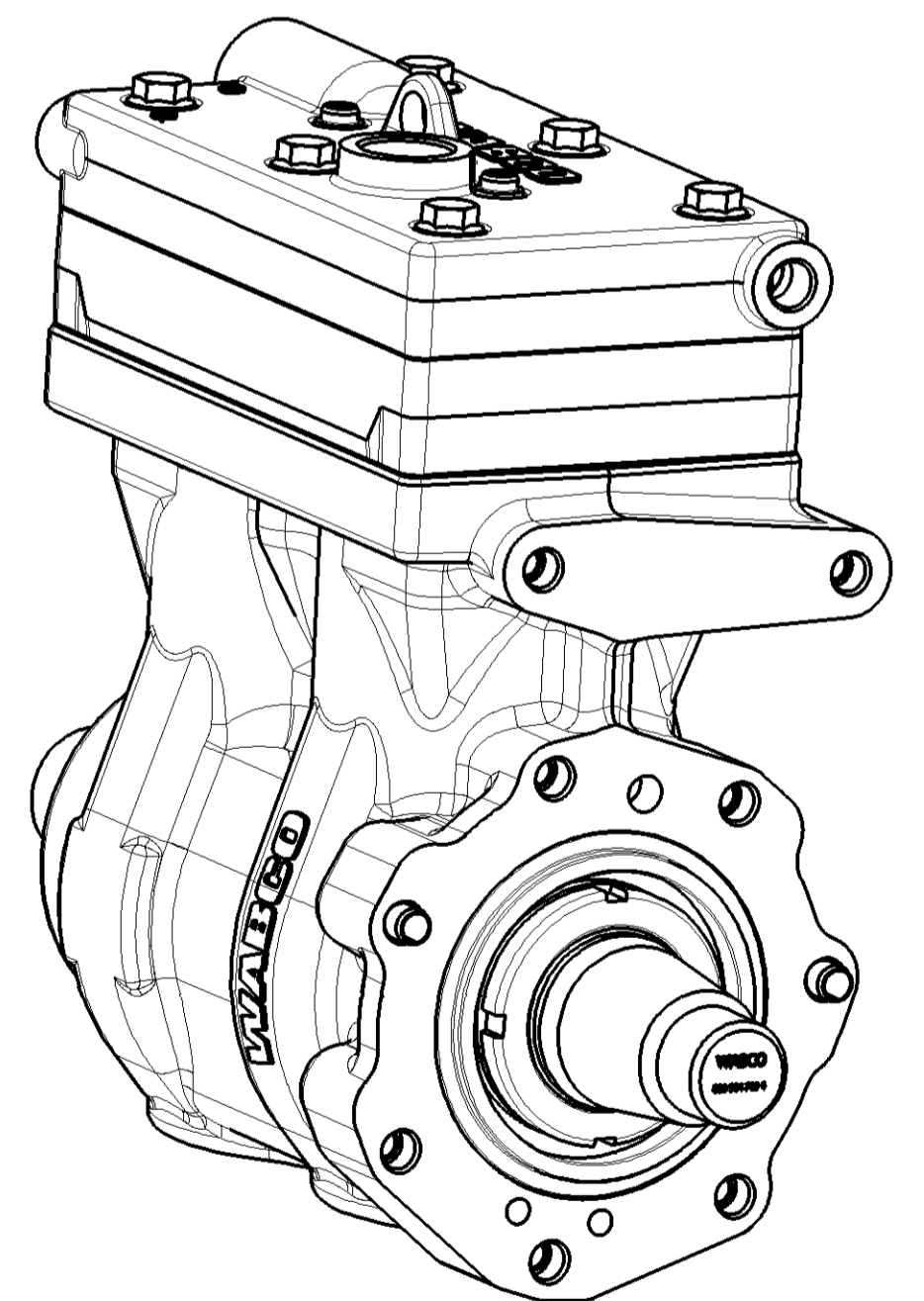

General Specifications: 4D-534-1, Size ISO 14400 LP		Copyright WABCO®		WABCO	
Further Technical Data:		Date: 2016-03-22		COMPRESSOR	
General Tolerance: 4D-261		Sheet: 1		System: Station	
Range of Nominal Dimensions (± mm)		Date: 2016-03-22		Version: 1	
Class	± 50	± 180	± 400	LAYMAN	
Fine	0.5	1.0	1.5	2.0	2016-03-22
Medium	1.0	2.0	3.0	4.0	005 EN 1/1
Course	2.0	3.5	5.0	6.5	2009
Tapped Holes acc.:		A 0 CREO		Revision: 1	
Tolerance class: As per Drawn		E3D No.: 912 560 008 R		Date of 1st issue: 2016-03-22	