

PART CODE	MATERIAL	SURFACE PROTECTION
I	STEEL	POWDER PAINTING, GREY COLOUR
II	STEEL	ZINC / ZINC-IRON PLATED / ZINC-NICKEL
III	STEEL	PHOSPHATING AND OILING
IV	ALUMINIUM ALLOY	PASSIVATING, CHROME III
V	RUBBER / PLASTIC	NO TREATMENT
VI	STEEL	POWDER PAINTING, BLACK COLOUR
VII	STEEL	INORGANIC COATING Zn/Al

TECHNICAL DATA		VALUE
1	ADMISSIBLE DEFLECTION OF PISTON IN EVERY DIRECTION	max. 3°
2	OPEN BREATHER HOLE	---
3	SW - WIDTH ACROSS FLATS	24
4	TORQUE	210 ^{ap} Nm
5	TORQUE	70±10 Nm
6	IN THIS ZONE : BARCODE LABEL	---
MEDIUM		AIR
THERMAL RANGE OF APPLICATION		-40°C...+80°C
PORT 11	SERVICE BRAKING SYSTEM, WORKING PRESSURE	max. 10.2 bar (TEMPORARILY max. 13 bar)
PORT 12	SPRING BRAKE CYLINDER, WORKING PRESSURE	max. 8.5 bar (TEMPORARILY max. 11 bar)
AIR VOLUME OF SERVICE BRAKE PART AT 2/3 OF ITS STROKE		ca. 0.8 dm ³
AIR VOLUME OF SPRING BRAKE PART		ca. 1.53 dm ³
MAIN VIEWS REFER TO DIMENSIONS ONLY		---
POSITION OF COMPONENTS SEE REPRESENTATIONS OF VARIANTS		---
() AUXILIARY DIMENSION		---

FORCE: N

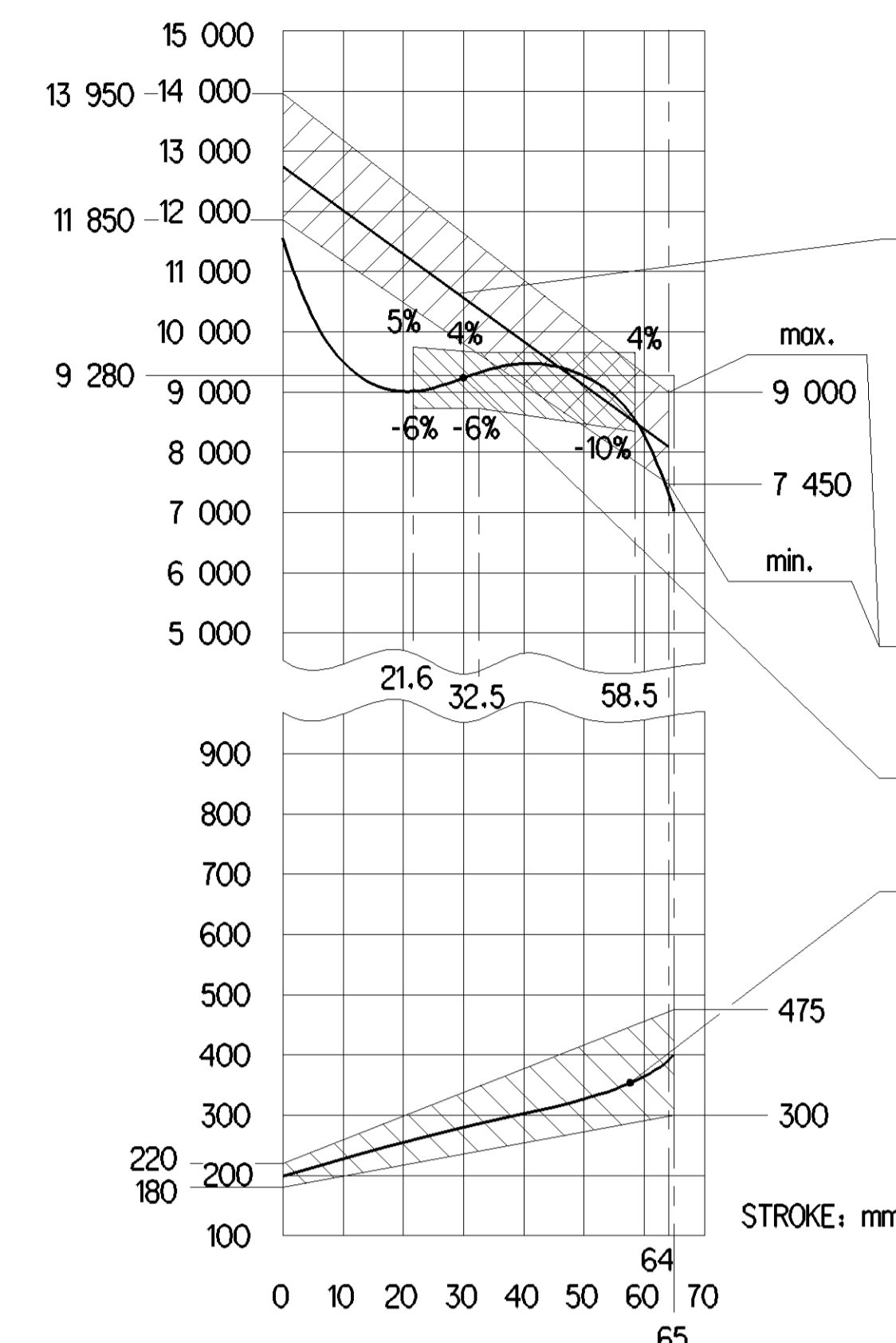

OUTPUT FORCE OF SPRING BRAKE PART, RELEASE PRESSURE: ≤ 6.7 bar

OUTPUT FORCE OF SERVICE BRAKE PART AT 6.5 bar

FORCE OF RETURN SPRING OF SERVICE BRAKE PART

POSITION OF PARTS

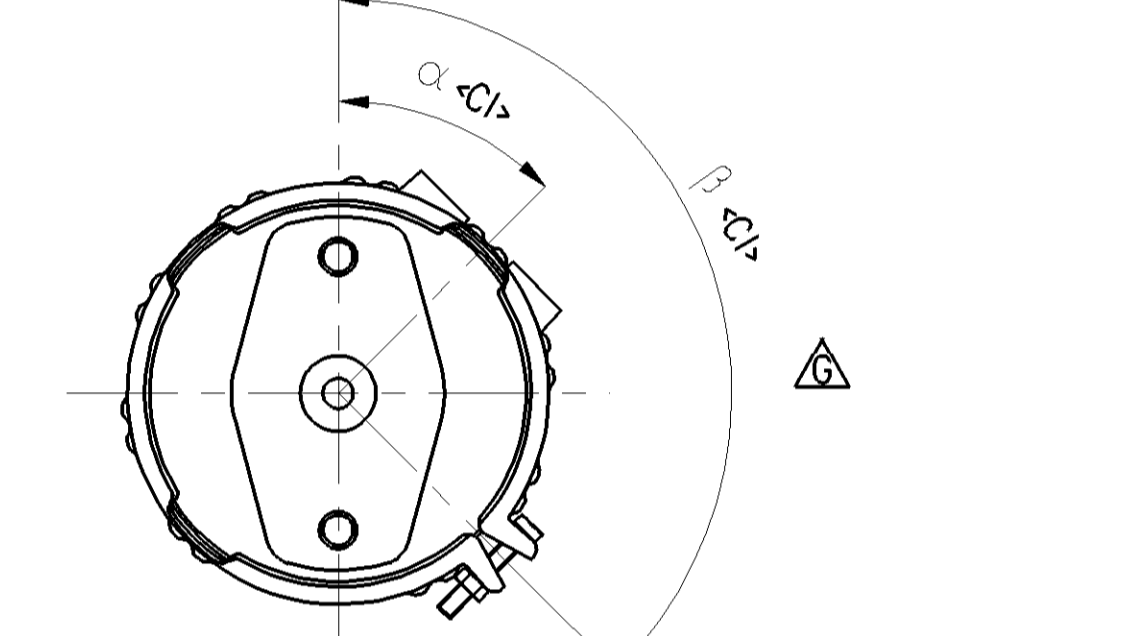

VARIANT

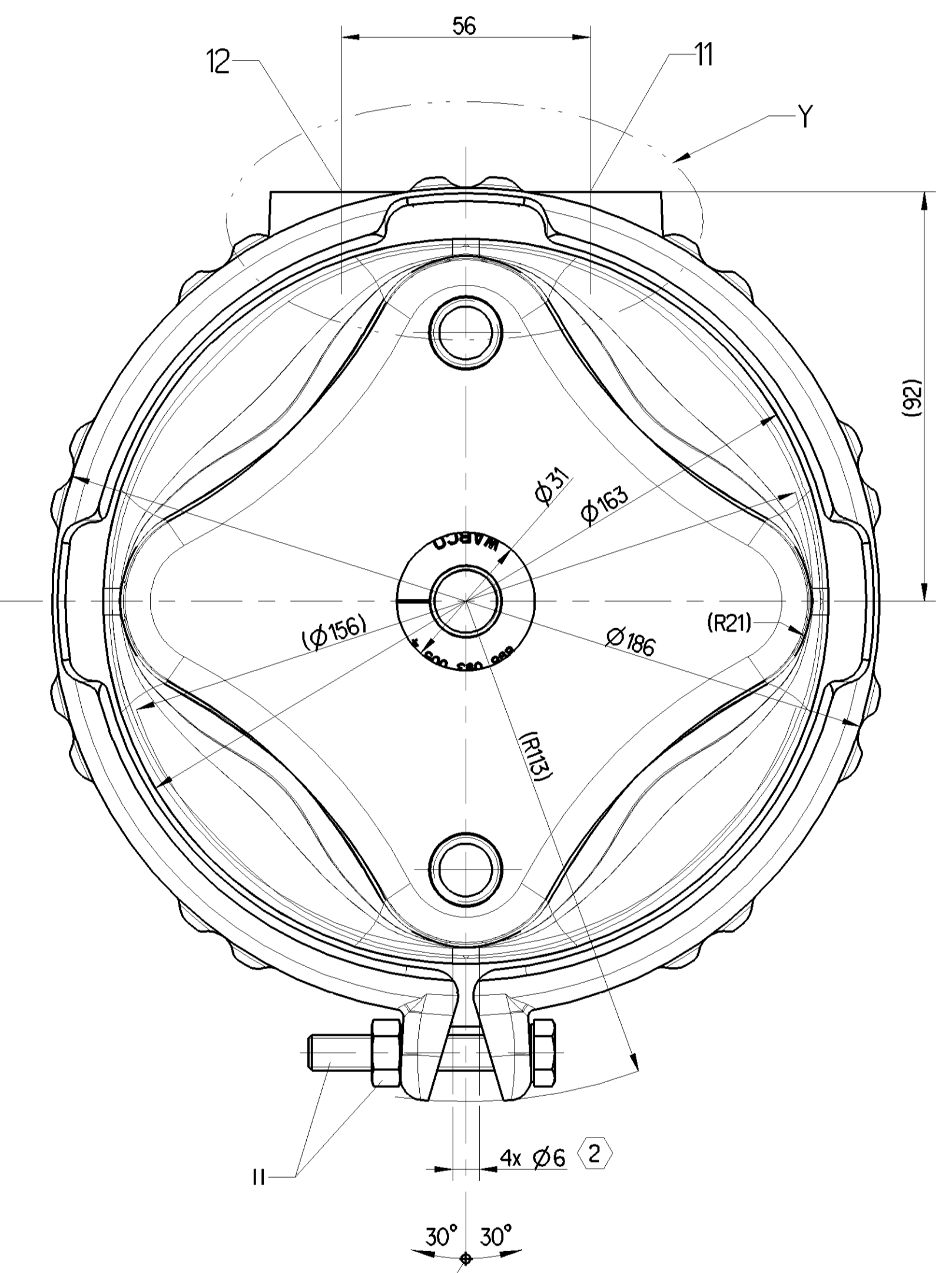
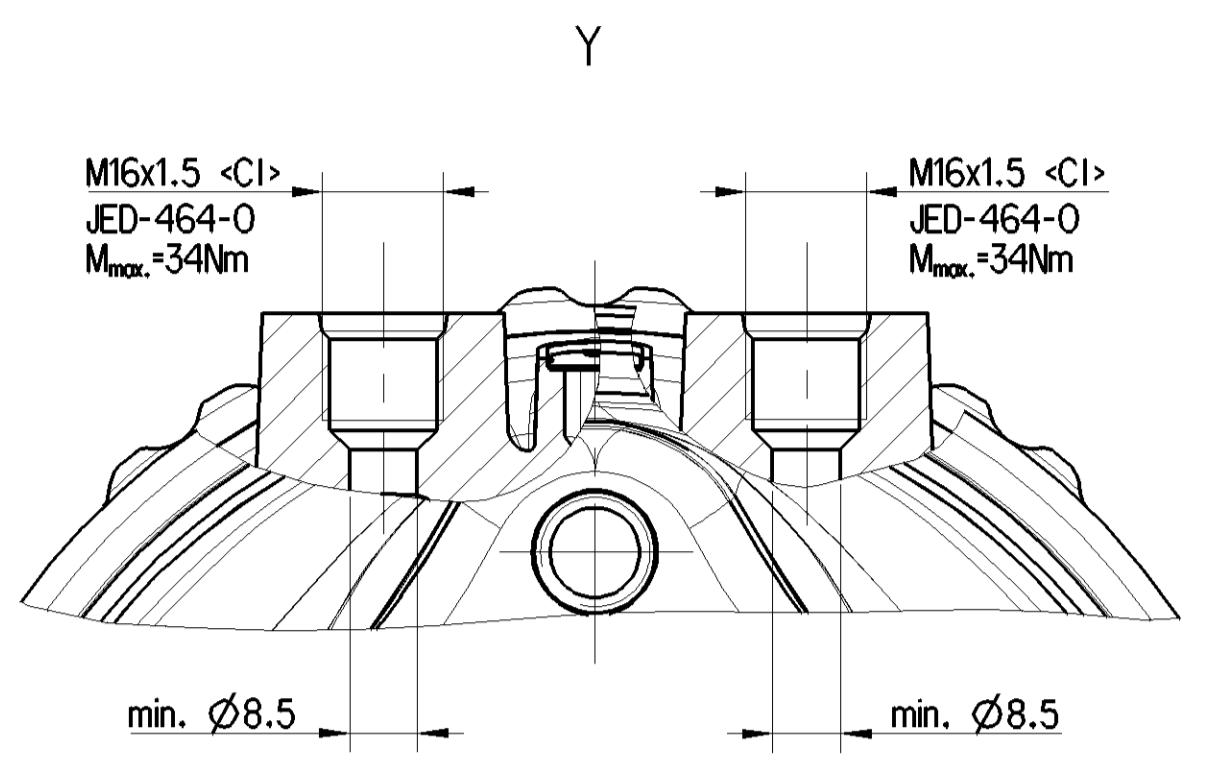
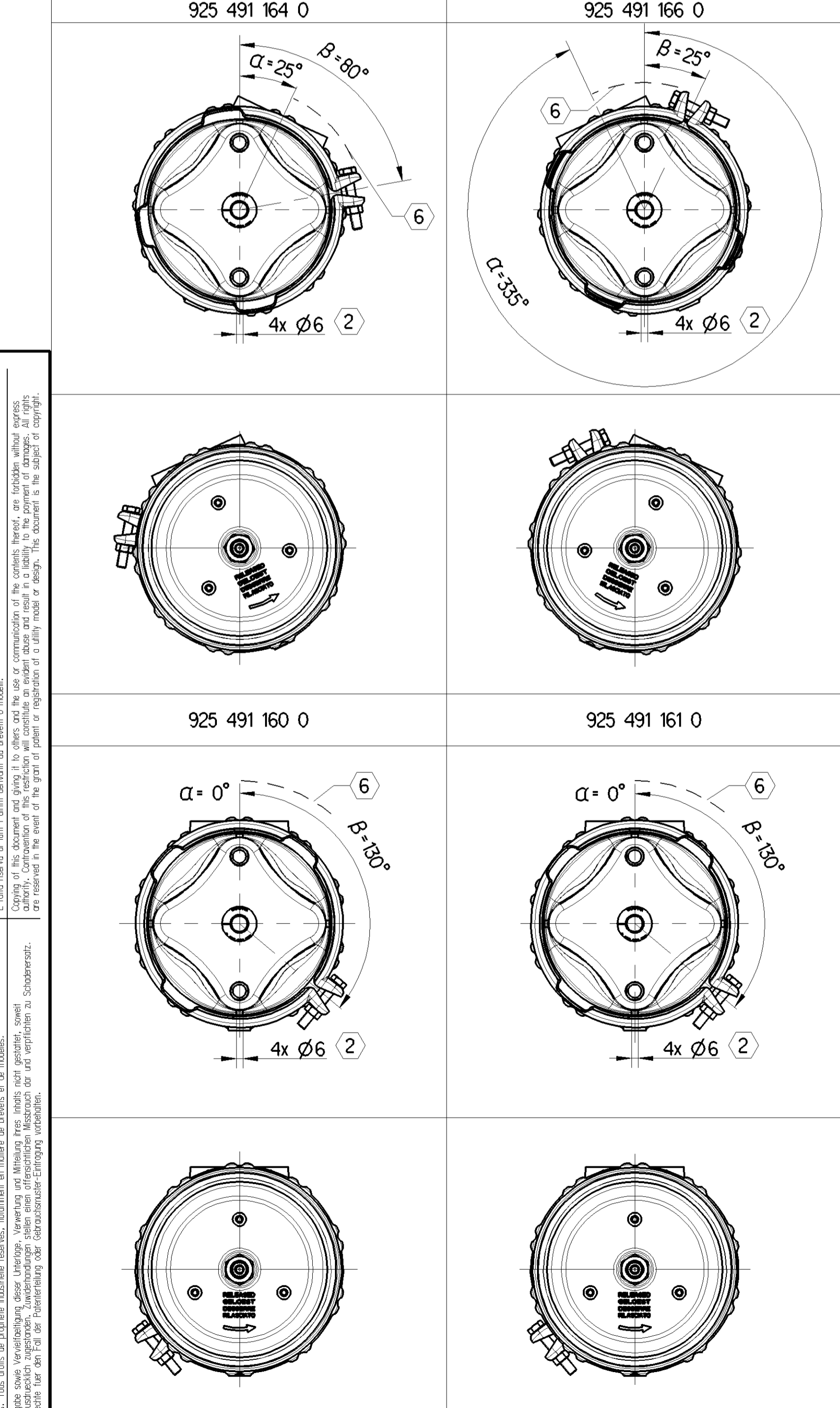

TO BE INSTALLED WITH LOWER BREATHER HOLE OPEN

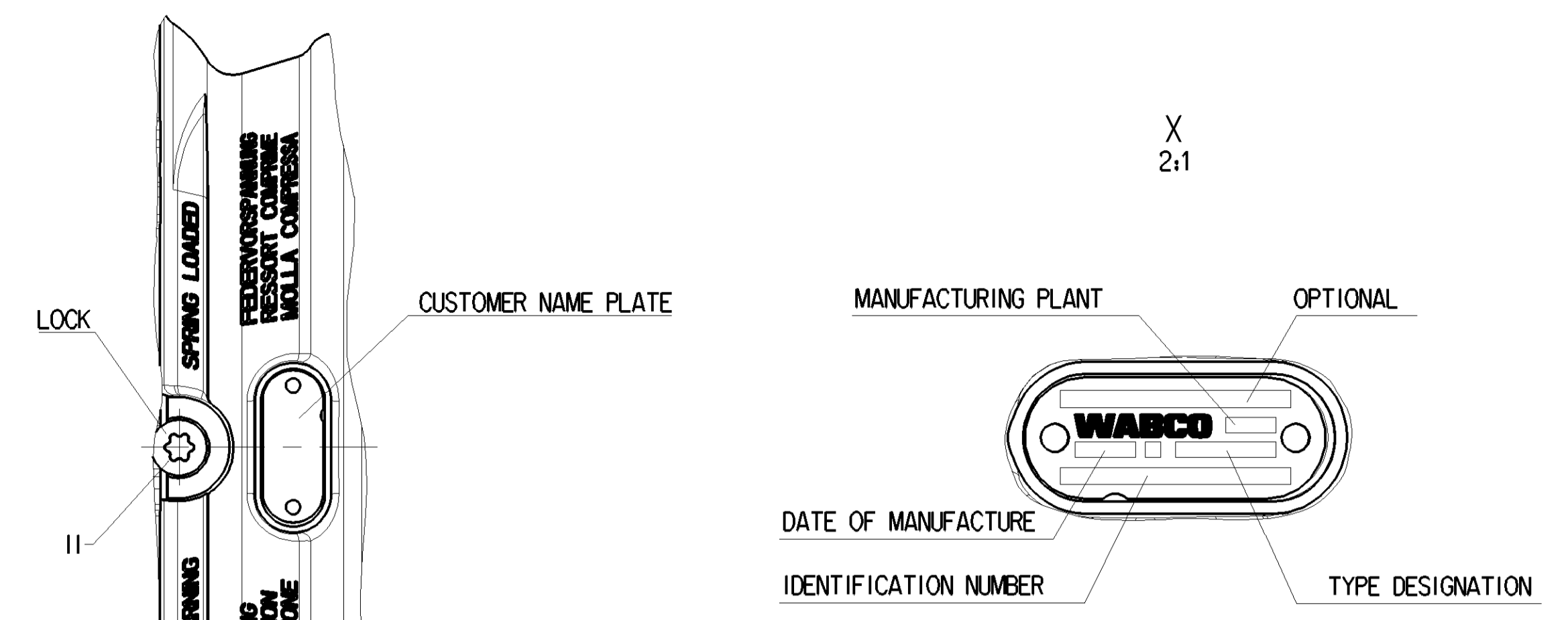

DRIVING POSITION, TIGHTENING WITH: M=25 Nm
RELEASE POSITION, RELEASING WITH: Mmax.=80Nm

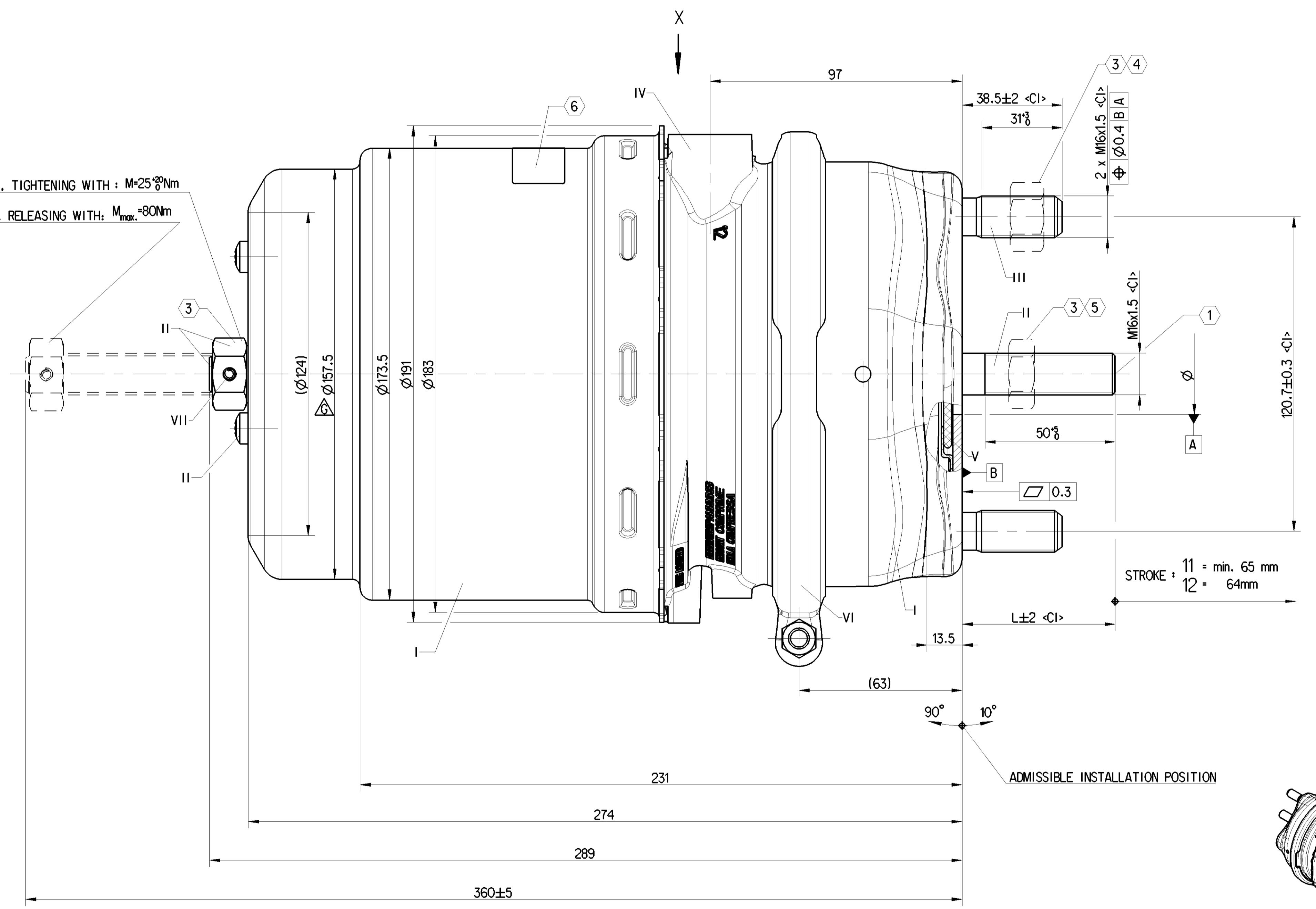

ADMISSIBLE INSTALLATION POSITION

925 491 166 0	-	235	DRIVING POSITION	9.78
925 491 164 0	-	235	DRIVING POSITION	9.78
925 491 163 0	-	108	RELEASE POSITION	9.56
925 491 162 0	-	220	DRIVING POSITION	9.76
925 491 161 0	-	58	DRIVING POSITION	9.51
925 491 160 0	-	58	DRIVING POSITION	9.51
925 491 518 0	-	108	RELEASE POSITION	9.56

WABCO		TRISTOP® - CYLINDER		24/24 HFL3	
Doc. Code: 026	Sheet: 1	Date: 2022-09-12	Version: 1.1	Doc. Code: 053	EN 1/1
Customer's No. L		Delivery Position <C1>	Mass (kg)	925 491 169 0	
A 0		CREO	52041	9 x G	5390