

← SAFETY CHARACTERISTICS	0
↔ SIGNIFICANT CHARACTERISTICS	0

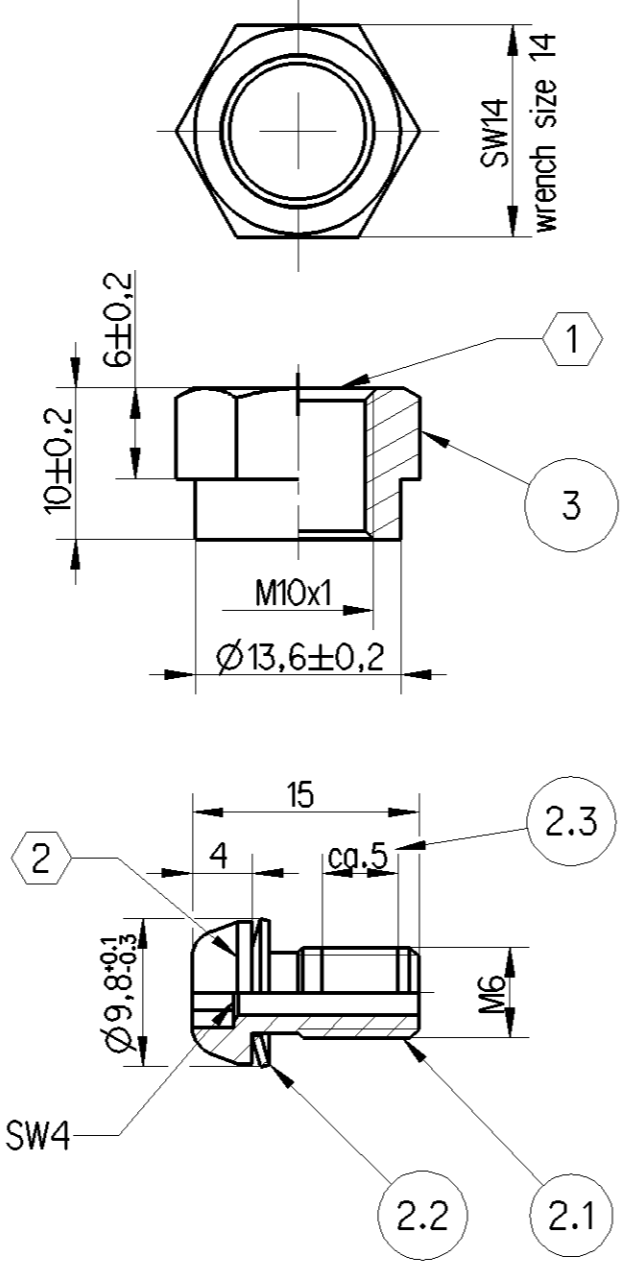

3	HEXAGON NUT	BRASS	NICKEL PLATED
2.3	THREAD LOCK COATING		MIKROENCAPSULATED
2.2	SAFETY WASHER	STEEL	ZINK FLAKE BASECOAT
2.1	SCREW		
1.4	O-RING	VMQ	--
1.3	VALVE STEM	BRASS	NICKEL PLATED
1.2	VALVE CORE 20	BRASS / PTFE / VMQ / STAINLESS SPRING STEEL	--
1.1	VALVE CAP	BRASS / EPDM	NICKEL PLATED
POS.	DESIGNATION	MATERIAL	SURFACE PROTECTION

NOTE		
FOR VALVE HOLE		Ø9,7 ^{+0,3} mm
FOR RIM THICKNESS		5.5 - 14.0 mm
SUITABLE FOR RIM MATERIAL		STEEL AND ALU
PRESSURE RANGE		<14bar
TEMPERATURE RANGE		-40... +100°C
TIGHTNESS IN RESPECT TO	ETRT0 TV3/TV4 (24h AT -40°C 48h AT 100°C)	<0.2 cm ³ /min
1	HEXAGON NUT	INSTALLATION TORQUE 9 - 14 Nm
2	FIXING SCREW	INSTALLATION TORQUE 4 ±0,5 Nm
SCREW SHALL BE APPLIED UNIQUELY		
3 TO PREVENT FROM POLLUTION, DUST, CORROSION OR AIR LEAKAGE SEALING THE VALVE CAP NEEDS TO BE INSTALLED.		
SET LOOSE PACKED IN A BAG, NUT AND SCREW UNMOUNTED		

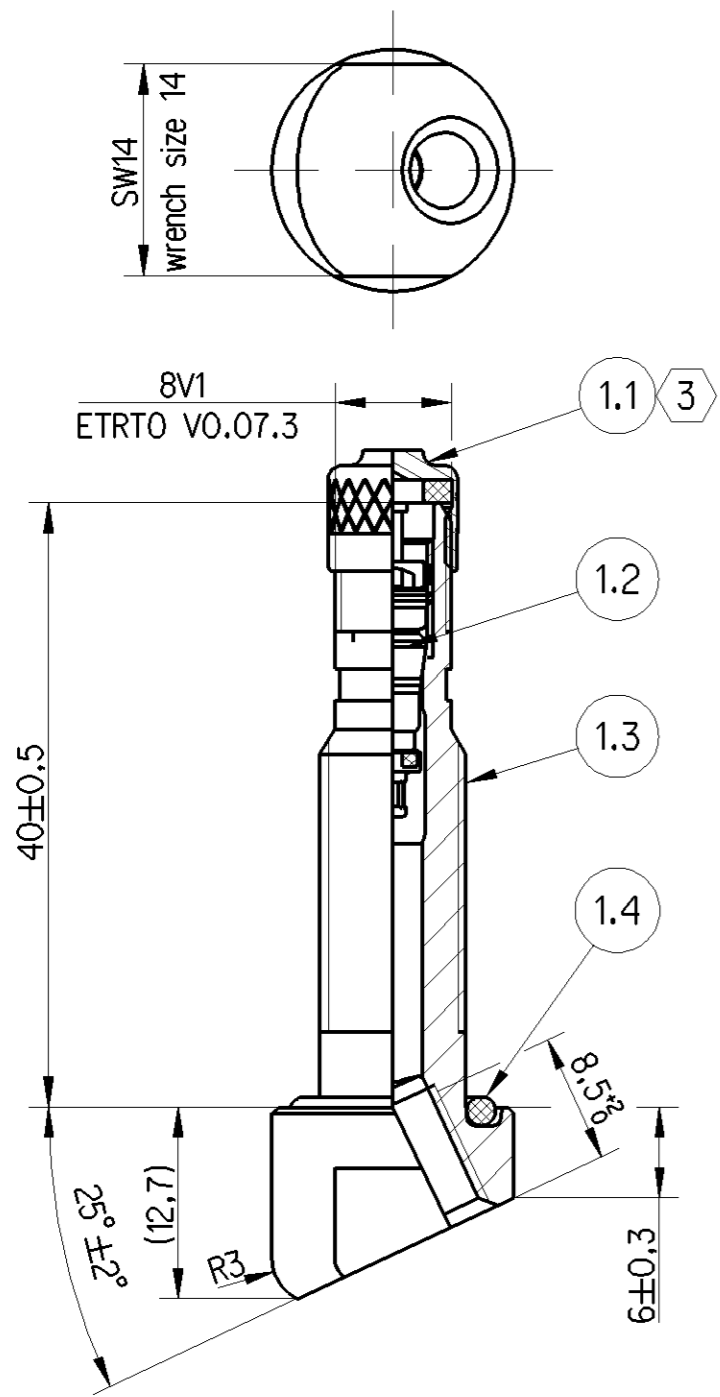
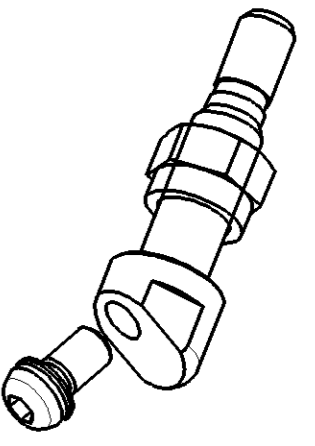

General Specification: JED-334-1, Size ISO 14405 LP		Copyright WABCO®		WABCO VALVE SET TMPS	
Further Technical Data:		Date	Signature		
Doc. Code	Sheet	To		2016-10-07 Markuszewski	
General Tolerances JED-261			Checked		2016-10-10 Gruendker
Range of Nominal Dimensions (± mm)			Expert		
Class 1)	≤ 50	> 50 ≤ 180	> 180 ≤ 400	> 400	±3°
Fine	0.5	1.0	1.5	2.0	
Medium	X 1.0	2.0	3.0	4.0	
Coarse	2.0	3.5	5.0	6.5	
Tapped Holes acc.		1) Tolerance Class Applied Crossmarked			
Mass	Scale	Material No.		Date of first issue: 2016-10-10	
0.044 kg	2:1 (1:1)	960 732 133 0		Doc.Code	Language
Size	CAD System	A 2		005	EN
ECN-No.		Revision	Techn. Resp.	Replacement for	
		6034			

Non e' permesso copiare, o terzi, o riprodurre questo documento, ne utilizzare il contenuto o renderlo comunque noto o terzi senza autorizzazione esplicita. Ogni infrazione costituisce un evidente abuso e comportera il risarcimento dei danni subiti. E' fatta riserva di tutti i diritti derivanti da brevetti o modelli.

Tout document ou reproduction de ce document, toute exploitation ou communication de son contenu sont interdites, sauf autorisation expresse. Tout manquement a cette regle constitue un abus evident et expose son auteur au versement de dommages et interets. Tous droits de proprie'te industrielle reserves, notamment en matiere de brevets et de modesles.

Copying of this document and giving it to others and the use or communication of the contents thereof, are forbidden without express authority. Contravention of this restriction will constitute an evident abuse and result in a liability to the payment of damages. All rights are reserved in the event of the grant of patent or registration of a utility model or design. This document is the subject of copyright.

Wskazane sowie wszelkie inne informacje, w tym w szczególności, nie należy kopiować, rozpowszechniać, w szczególności, w celu komercyjnym, bez uprzedniego pisemnego zezwolenia producenta. Wszelkie prawa zastrzeżone. Wszelkie prawa autorskie i prawa własności intelektualnej producenta są chronione. Wszelkie prawa do wynalazków i modeli są zastrzeżone.

A
B
C
D
E
F
G