

PART No. M250050 GA

ENGINEERING CHANGES			
ECN No.	DATE	REV	SIGN
4724	28.09.84	New	
5218	19.11.86	1	
5248	30.12.86	2	
7808	06.05.99	3	
M12x1.5 deep 10 was M12 x1.5 deep 9. Drawing redrawn.			
10867	23.08.07	4	CSN
GDC body changed to PDC body. Ø15.5 was Ø15. DIM 13 deleted. weight updated. PSSC Rev. No. and date updated. Note, S1. No.9, 10, 11 and 12 added. Surface protection and Special characteristics symbol added. Dimension indication changed to nominal and bilateral tolerance from upper and lower limits. Drawing redrawn.			
11374	09.02.09	5	RBS
In Name plate, Company name changed from Sundaram Clayton Ltd to WABCO- TVS (INDIA) Ltd. Drawing redrawn.			
12083	16.03.11	6	RBS
Drawing template WABCO was WABCO-TVS (INDIA) Ltd. Drawing pictorially modified inline with parts. Drawing redrawn.			
12215	24.11.11	7	PY
A/F 13 with Torque 11±4 Nm added. Drawing redrawn.			

DO NOT SCALE IF IN DOUBT ASK

ASSY PART No. AND
BATCH No. ARE SHOWN HERE

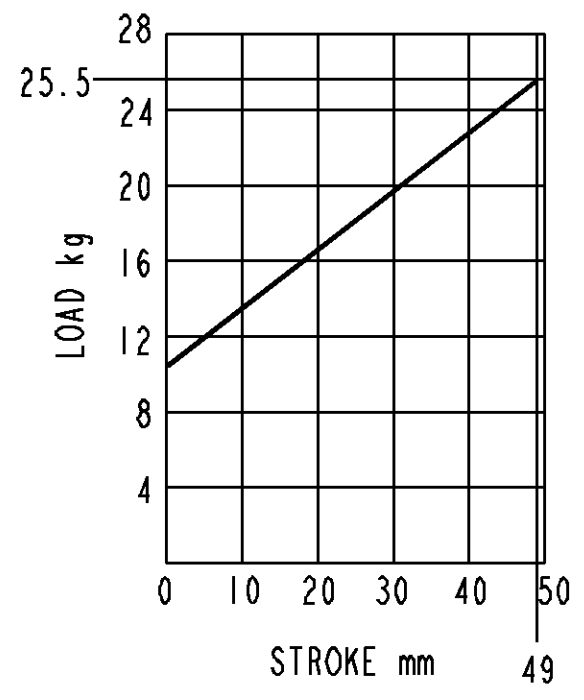
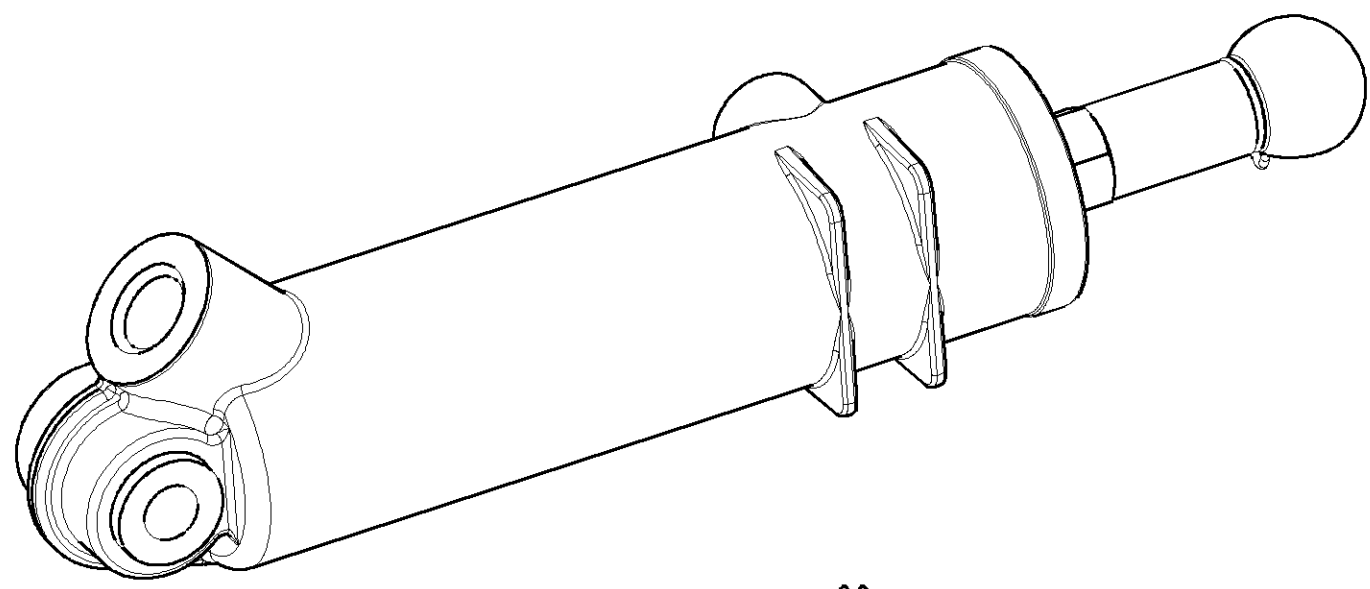
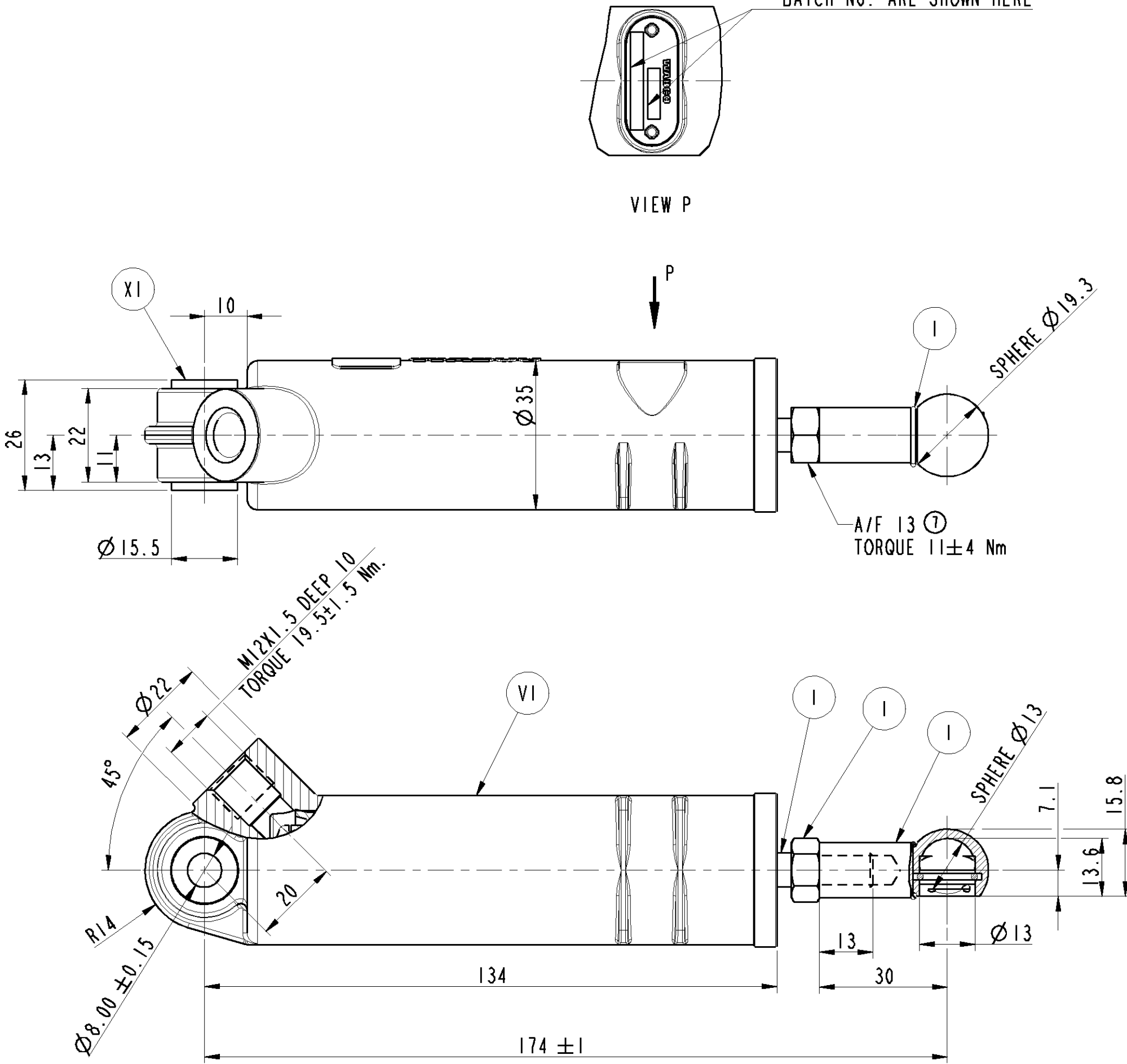

PISTON RETURN
SPRING CHARACTERISTICS

XVII	STEEL	NO TREATMENT
XVI	CAST IRON	PLATED
XV	STEEL	ZINC IRON PLATED
XIV	CAST IRON	NO TREATMENT
XIII	ZINC ALLOY	ANODISED
XII	PLASTIC	NO TREATMENT
XI	RUBBER	NO TREATMENT
X	STAINLESS STEEL	NO TREATMENT
IX	BRASS	NO TREATMENT
VIII	ZINC ALLOY	CHROMATED
VII	ALUMINIUM ALLOY	ANODISED
VI	ALUMINIUM ALLOY	CHROMATED
V	CAST IRON	PAINTED
IV	STEEL	POWDER COATED
III	STEEL	PAINTED
II	STEEL	PHOSPHATED
I	STEEL	ZINC PLATED
PART CODE	MATERIAL	SURFACE PROTECTION

- CRITICAL
- MAJOR
- NO SYMBOL - MINOR

1	PRODUCT SPECIFICATION No.	PSSC IIC REV No. 3 DATED 23.08.07
2	CYLINDER BORE DIA	28 mm
3	STROKE	50.5±1.5 mm
4	CYLINDER OPENING PRESSURE (TO BE TESTED AS SEPARATE AIR CYLINDER)	≤ 3 bar
5	FULL STROKE PRESSURE	≈ 5 bar
6	NORMAL WORKING PRESSURE	8 bar
7	MAXIMUM WORKING PRESSURE	10 bar
8	EQUIVALENT FLOW DIAMETER INLET TO DELIVERY	1.5 mm
9	ENVIRONMENTAL TEST	AS PER PSSC II C
10	DUST TEST	AS PER PSSC II C
11	SALT SPRAY TEST	96 HOURS AS PER ISO 9227
12	VIBRATION TEST	AS PER PSSC II C
13	OPERATING TEMP. RANGE	-40°C TO +80°C
14	NOMINAL WEIGHT	0.3 kg
15	OPEN PORT IS FITTED WITH CLOSURE PLUG FOR STORAGE AND TRANSIT PURPOSES	

WABCO

AMBATTUR, CHENNAI - 600058, INDIA

PART No.
M250050

AIR CYLINDER

GA

SIGN	DATE	MATERIAL	CONFIDENTIAL DRAWING	UNLESS OTHERWISE SPECIFIED ALL DIMENSION IN mm REMOVE BURRS AND SHARP EDGES FROM FINISHED PARTS ALL DIMENSIONS ARE AFTER SURFACE PROTECTION / TREATMENT MALE THREAD TO IS 14962 (PART3) 6H : 2001 FEMALE THREAD TO IS 14962 (PART3) 6H : 2001	GENERAL TOLERANCES			SCALE 1:1	AIR CYLINDER		PART No. M250050
DRN	MSKR	22.11.11	ALTERNATE MATERIAL	REFER TABLE	RANGE OF NOMINAL DIMENSIONS (± mm)			FORCE, POWER, PRESSURE etc., (± %)			
CHD	PY	22.11.11	SURFACE PROTECTION	REFER TABLE	RANGE OF NOMINAL DIMENSIONS (± mm)			FORCE, POWER, PRESSURE etc., (± %)	AIR CYLINDER		PART No. M250050
APD	SN	22.11.11	RAW PART No.	REFER TABLE	RANGE OF NOMINAL DIMENSIONS (± mm)			FORCE, POWER, PRESSURE etc., (± %)			