

PART No. M306510 GA

DO NOT SCALE IF IN DOUBT ASK

ENGINEERING CHANGES				
ECN No.	DATE	REV	SIGN	
10778	25.06.07	NEW	AKS	
11374	09.02.09	1	RBS	In name plate, company name changed from Sundaram Clayton Ltd to WABCO-TVS (INDIA) Ltd. Drawing redrawn.
12083	16.03.11	2	RBS	Drawing Template WABCO was WABCO-TVS (INDIA) Ltd. Drawing pictorially modified inline with parts. Drawing redrawn.
12370	25.09.12	3	TSH	Drawing pictorially modified inline with casting. Drawing redrawn.

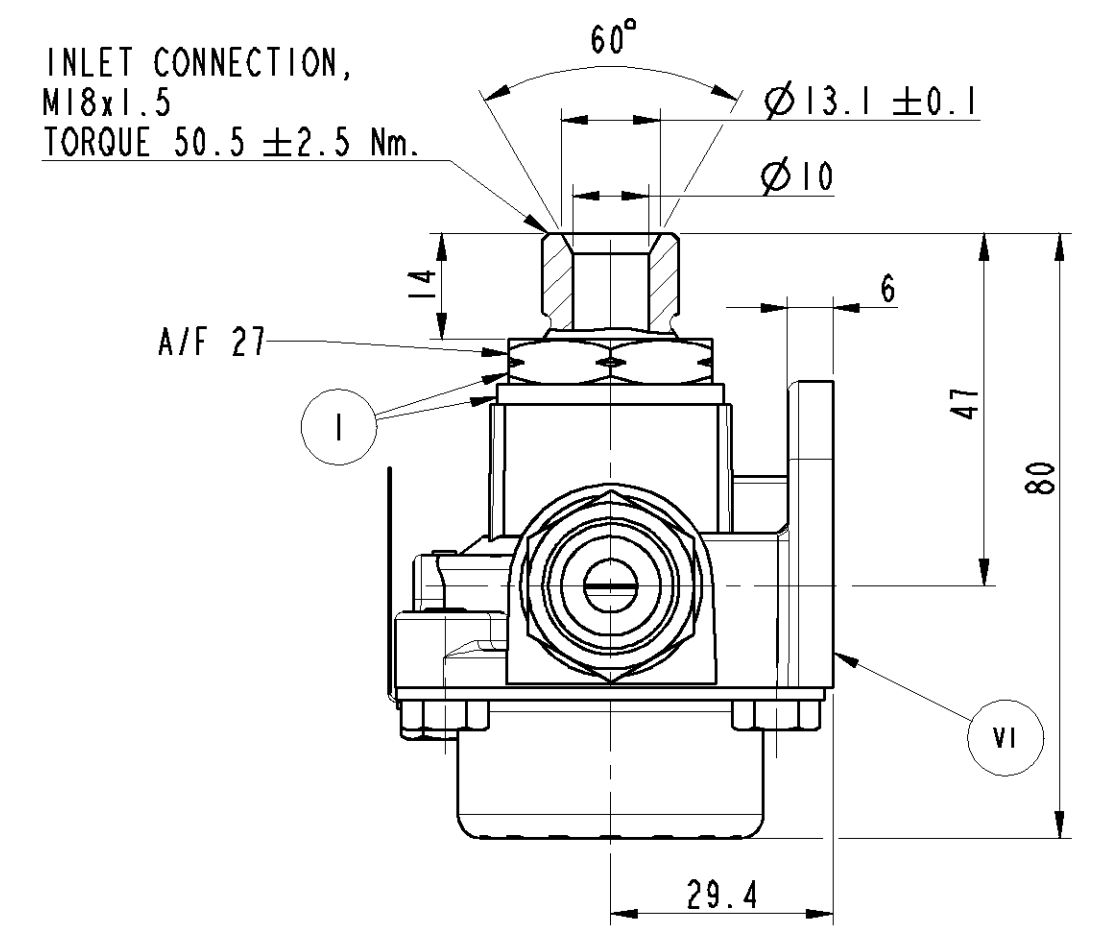
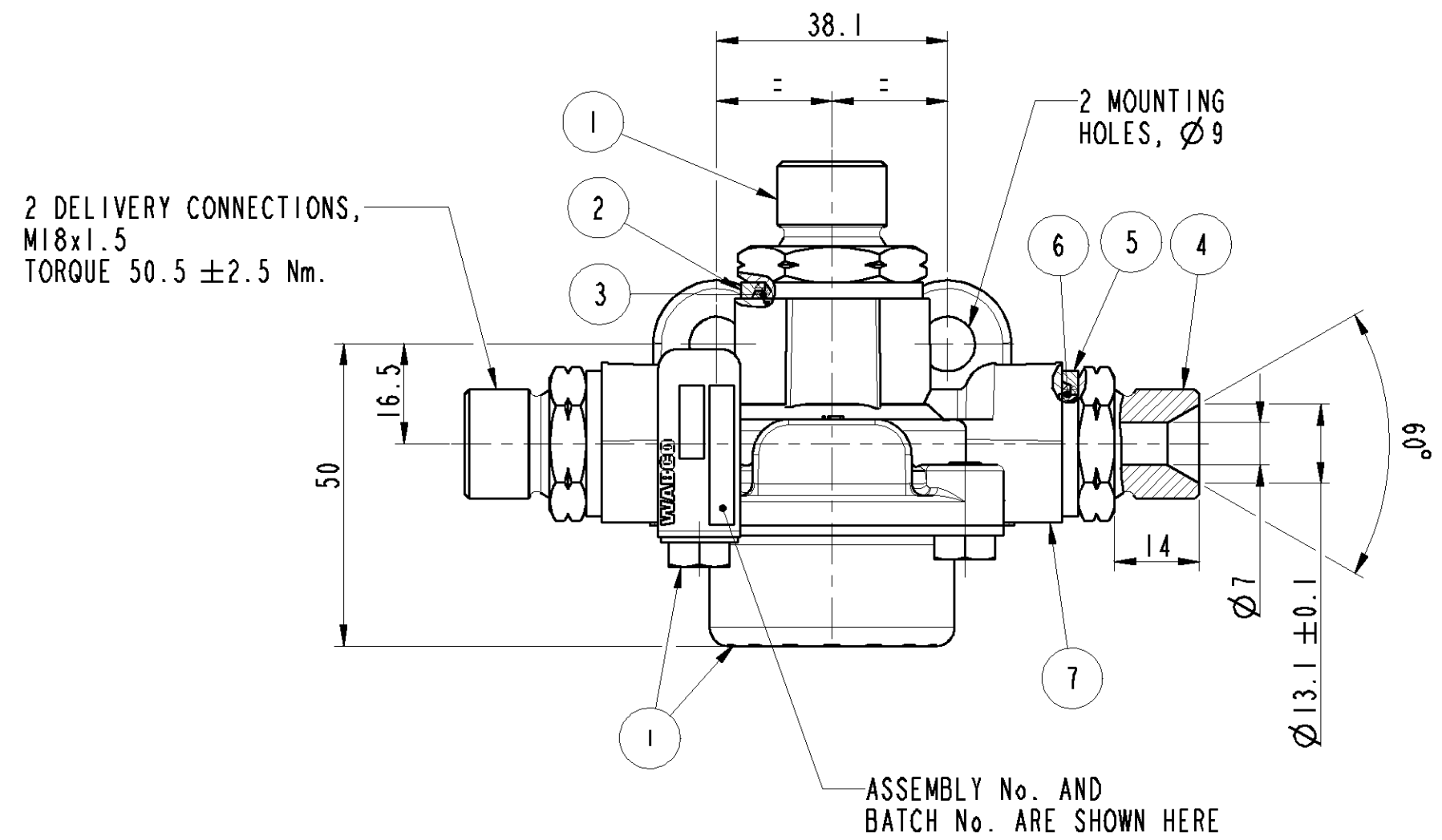
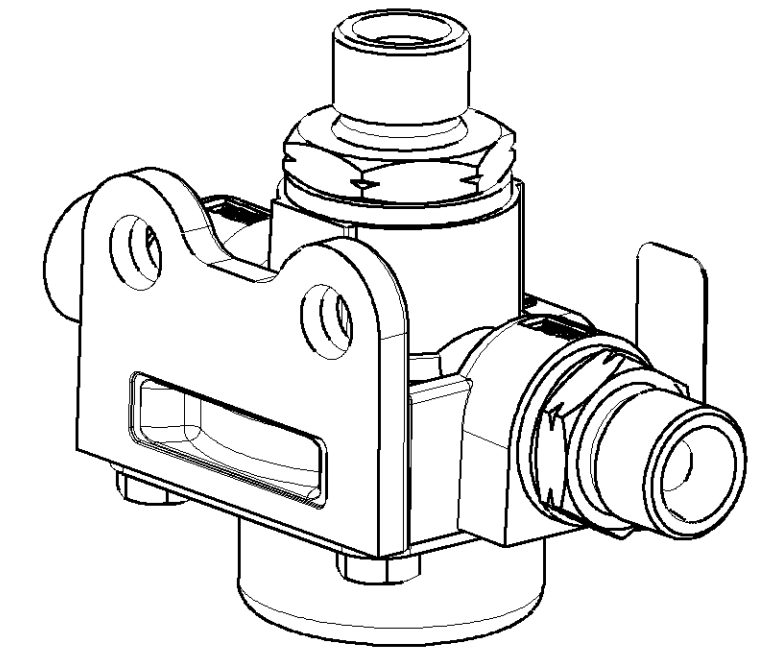
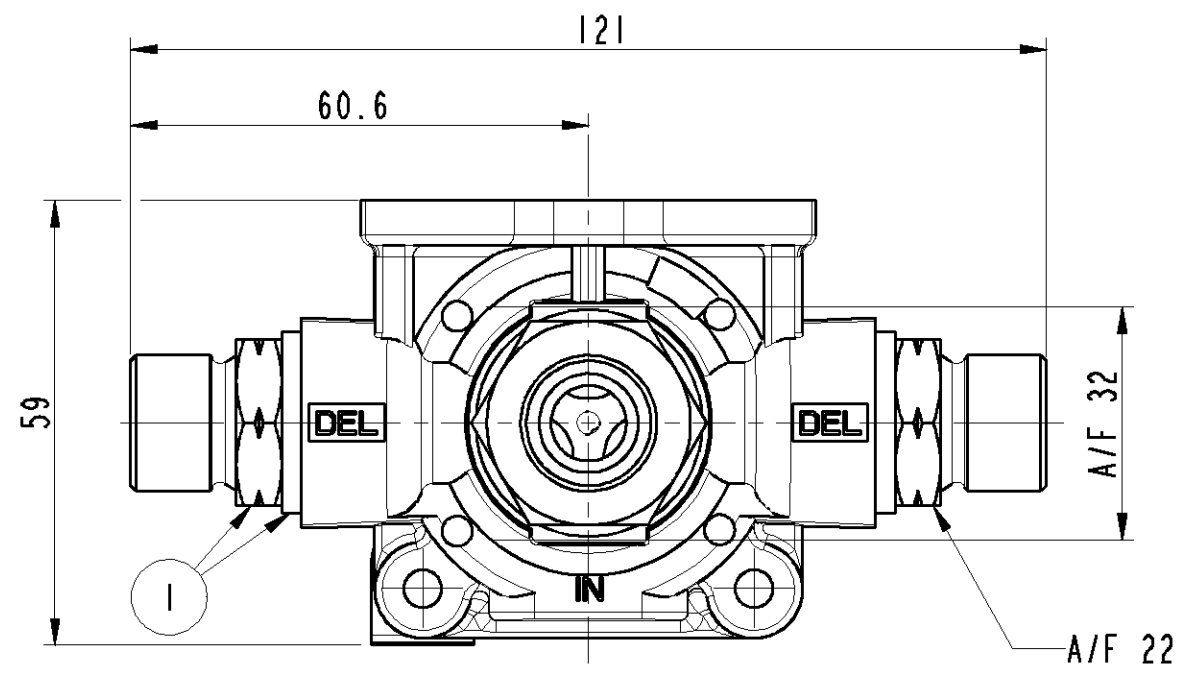

XVII	STEEL	NO TREATMENT
XVI	CAST IRON	PLATED
XV	STEEL	ZINC IRON PLATED
XIV	CAST IRON	NO TREATMENT
XIII	ZINC ALLOY	ANODISED
XII	PLASTIC	NO TREATMENT
XI	RUBBER	NO TREATMENT
X	STAINLESS STEEL	NO TREATMENT
IX	BRASS	NO TREATMENT
VIII	ZINC ALLOY	CHROMATED
VII	ALUMINIUM ALLOY	ANODISED
VI	ALUMINIUM ALLOY	CHROMATED
V	CAST IRON	PAINTED
IV	STEEL	POWDER COATED
III	STEEL	PAINTED
II	STEEL	PHOSPHATED
I	STEEL	ZINC PLATED
PART CODE	MATERIAL	SURFACE PROTECTION

SL No.	DESCRIPTION	SCL PART No.	VFJ PART No.	QTY
1	UNION BODY M22x18	M922780		1
2	SEALING WASHER	M925940		1
3	SEALING RING	M912620		1
4	UNION BODY M22x18	M917790		2
5	SEALING WASHER	M925860		2
6	SEALING RING	M925880		2
7	QUICK RELEASE VALVE	M304500		1

PRODUCT SPECIFICATION No. PSSC 150C
REV. 3, DATED: 21.05.07

WEIGHT : 426 g

MALE THREADS ARE FITTED WITH CLOSURE SLEEVE FOR STORAGE AND TRANSIT PURPOSES

● CRITICAL
● MAJOR
NO SYMBOL - MINOR

WABCO
AMBATTUR, CHENNAI - 600058, INDIA

SIGN	DATE	MATERIAL	----
DRN	RMK	25.09.12	ALTERNATE MATERIAL
CHD	TSH	25.09.12	SURFACE PROTECTION REFER TABLE
APD	SN	25.09.12	RAW PART No.

CONFIDENTIAL DRAWING
THIS DRAWING IS THE SOLE PROPERTY OF WABCO. IT SHOULD NOT BE COPIED OR COMMUNICATED TO ANY PERSON WITHOUT THE WRITTEN APPROVAL OF WABCO.
© 2007

GENERAL TOLERANCES				
RANGE OF NOMINAL DIMENSIONS (± mm)				
≤ 50	≤ 50	≤ 180	≤ 400	> 400
1	2	3	4	10

SCALE 1:1
⊕

QUICK RELEASE VALVE WITH FITTINGS

PART No. M306510 GA