

PART No.				M450400				GA			
ENGINEERING CHANGES											
ECN No.		DATE		REV		SIGN					
8428		29.06.01		NEW		RN					
8502		06.09.01		1		RN					
Thread length 20 for M6X1 added. Graph showing output load characteristics added. Drawing redrawn.											
8661		13.03.02		2		RN					
Surface finish 6.3 added to boss face. Tolerance $\pm 0.5$ added to DIM 46. Major symbol added to output load characteristics graph. DIM 46.5/45.5 and Note regarding 'PSSC 123C'											
9270		22.01.04		3		RN					
PSSC revision No. 3 dated 22.01.04 was revision No. 2 dated 13.03.2002. Dimension indication changed to nominal and balateral tolerance from Upper and lower limits. Drawing redrawn.											
11374		09.02.09		4		RBS					
In label, CD-TVS monogram was TVS monogram. Sundaram Clayton Ltd deleted. WABCO-TVS (INDIA) Ltd added. Drawing redrawn.											
12083		16.03.11		5		RBS					
Drawing template WABCO was WABCO-TVS (India) Ltd. Drawing pictorially modified inline with parts. Drawing redrawn.											
12281		22.03.12		6		PY					
Torque $19 \pm 2$ Nm and Torque $8 \pm 1$ Nm added for M8x1.25 and M6x1 respectively. Drawing redrawn.											

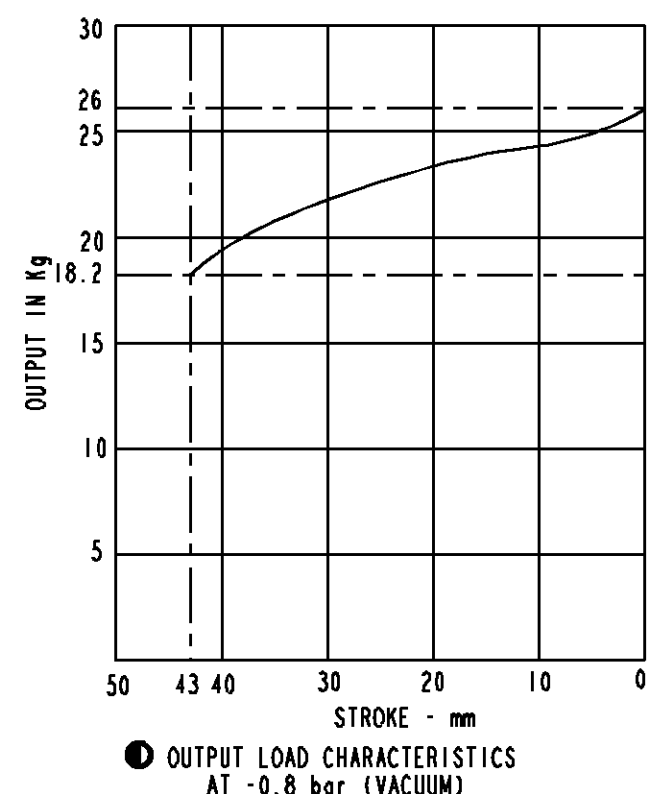
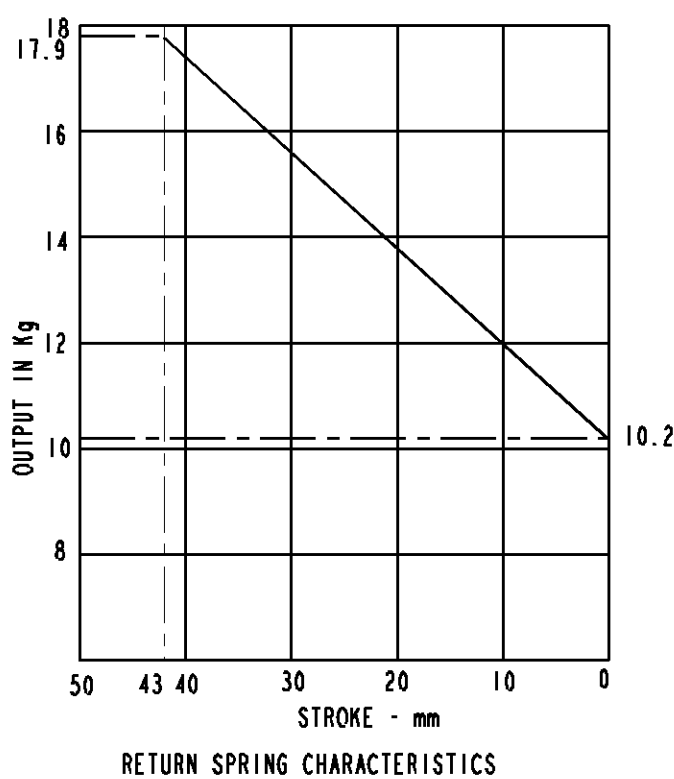
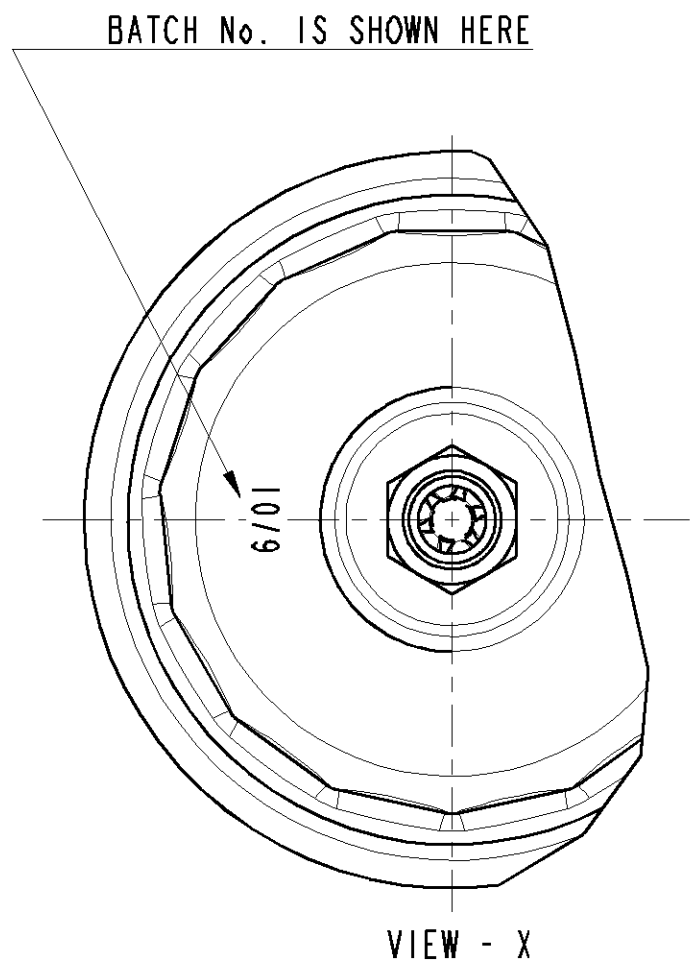
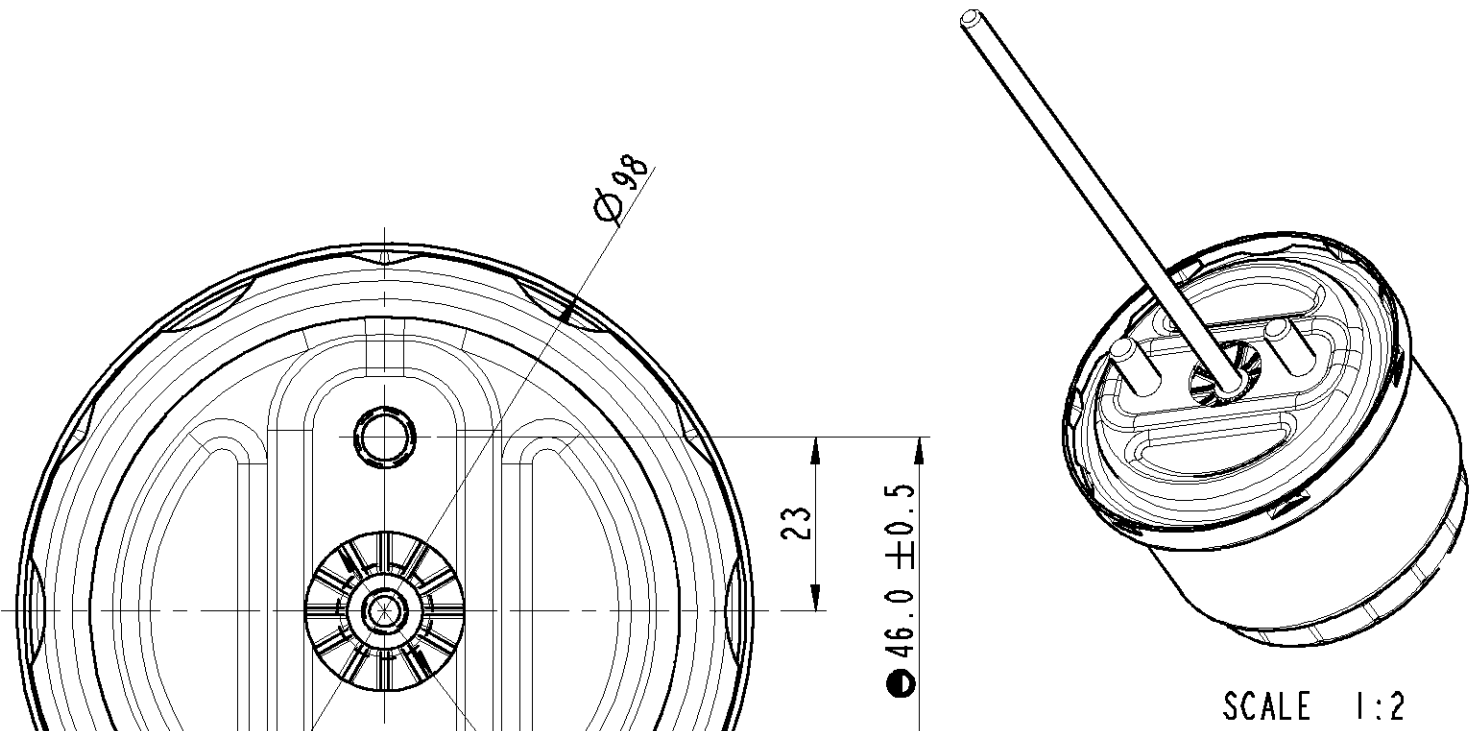
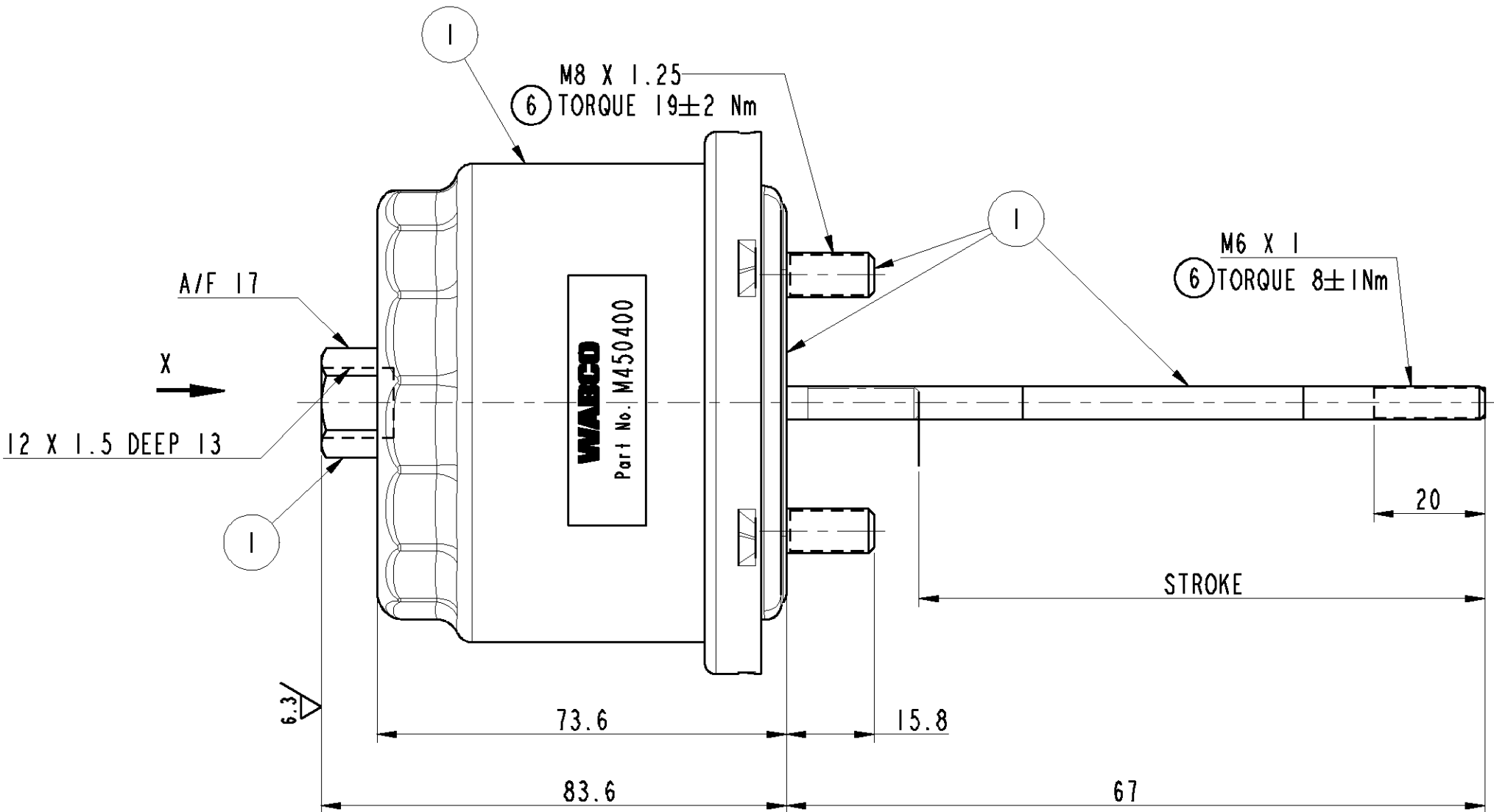

① PRODUCT SPECIFICATION NO: PSSC 123C  
(ISSUE No.3 DATED 22.01.2004)  
STROKE : 43±1mm.  
WORKING PRESSURE : -0.8 bar (VACUUM) MAX.  
ANGULAR ARTICULATION OF PUSH ROD : 4° min.ALL ROUND  
WORKING DIAMETER : 76.2mm NOMINAL  
WEIGHT: 450 gram  
OPEN PORTS AND M6 MALE THREADS ARE FITTED WITH CLOSURE PLUG AND CLOSURE SLEEVE RESPECTIVELY FOR STORAGE AND TRANSIT PURPOSES

PART IDENTIFICATION	MATERIAL	SURFACE PROTECTION
I	STEEL	ZINC PLATED
II	STEEL	PAINTED
III	STEEL	POWDER COATED
IV	ALUMINIUM ALLOY	CHROMATED
V	ALUMINIUM ALLOY	ANODISED
VI	ZINC ALLOY	CHROMATED
VII	BRASS	NO TREATMENT
VIII	RUBBER	NO TREATMENT
IX	PLASTIC	NO TREATMENT
X	STAINLESS STEEL	NO TREATMENT

- CRITICAL
- MAJOR
- NO SYMBOL - MINOR

**WABCO**  
AMBATTUR, CHENNAI - 600058, INDIA

SIGN	DATE	MATERIAL	---	CONFIDENTIAL DRAWING		GENERAL TOLERANCES		SCALE 1:1	PART No.	
DRN	MSKR	21.03.12	ALTERNATE MATERIAL	---	THIS DRAWING IS THE SOLE PROPERTY OF WABCO. IT SHOULD NOT BE COPIED OR COMMUNICATED TO ANY PERSON WITHOUT THE WRITTEN APPROVAL OF WABCO. © 2001	RANGE OF NOMINAL DIMENSIONS (± mm)		FORCE, POWER, PRESSURE etc., (± %)	VACUUM CYLINDER	
CHD	PY	21.03.12	SURFACE PROTECTION	REFER TABLE		≤ 50	≥ 50			
APD	SN	21.03.12	RAW PART No.	---		≤ 180	≥ 180			
					UNLESS OTHERWISE SPECIFIED ALL DIMENSION IN mm REMOVE BURRS AND SHARP EDGES FROM FINISHED PARTS ALL DIMENSIONS ARE AFTER SURFACE PROTECTION / TREATMENT MALE THREAD TO IS 14962 (PART3) 6H : 2001 FEMALE THREAD TO IS 14962 (PART3) 6H : 2001		≥ 400	≥ 400	M 450400	
							≥ 1000	≥ 1000	GA	