

HAND BRAKE VALVE (961 722 XXX 0)

WABCO has been made aware of cases of improper functioning of the WABCO Hand Brake Valves in circumstances where the hand lever mechanism is worn. In particular, we have received a small number of Hand Brake Valves from the field where the handle was able to rotate in a manner which prevented them from securely locking into the parking position.

DESCRIPTION

The inner hand lever mechanism of the Hand Brake Valve is responsible for the locking/unlocking of the hand lever in the parking position. Rotation of the handle of the hand lever is prevented by its design, except for small tolerances of ± 10 degree (small free-play between parts). In certain parts inspected, where the inner hand lever was worn out, the handle could be rotated outside of the normal tolerances.

In case the Hand Brake Valve handle can be rotated outside of the normal tolerances described above, this indicates that the inner handle lever is worn out. Under these conditions a secure locking of the hand lever in the parking position is not ensured.

RECOMMENDATION

A Hand Brake Valve is subject to wear like any other mechanical components and must be replaced in case that proper functioning is no longer secured. We strongly recommend that you inform all customers who are using the Hand Brake Valve about the risk of operating worn out Hand Brake Valves.

Specifically Hand Brake Valve with hand lever handle that can be rotated more than 20 degrees in total (too high free-play between parts) in the drive position is worn and should be replaced. Verification should be performed by rotation movement from maximum left to maximum right position of handle as shown below.

Picture 1: Handbrake valve

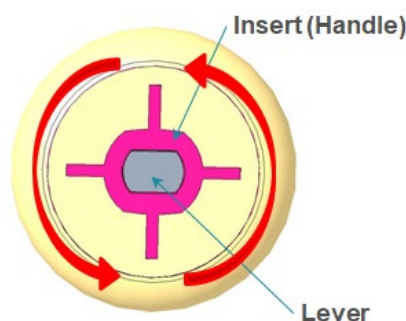
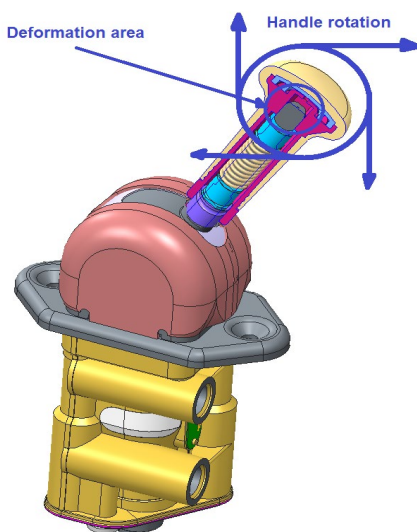
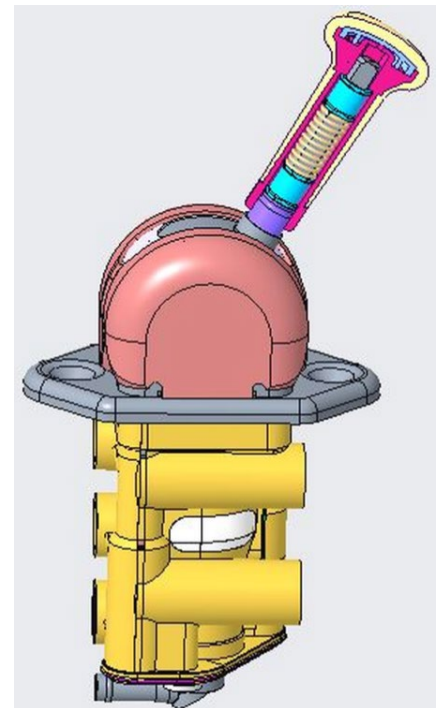

POTENTIALLY AFFECTED WABCO HAND BRAKE VALVES

Only some variants (part numbers below) of Family 961 722 xxx 0 of Hand Brake Valve are subject to this Product Advisory.

Table 1: Part numbers

4674100110;	9617221580;	9617222520;	9617222667;
4674100120;	9617221590;	9617222527;	9617222670;
4674100150;	9617221700;	9617222540;	9617222690;
8845018410;	9617221710;	9617222547;	9617222697;
8845019290;	9617221750;	9617222580;	9617222720;
8845025210;	9617221757;	9617222587;	9617222730;
9617221500;	9617221790;	9617222600;	9617222810;
9617221507;	9617221800;	9617222607;	9617222840;
9617221510;	9617221830;	9617222620;	9617222860;
9617221517;	9617221840;	9617222627;	9617222910;
9617221520;	9617221860;	9617222640;	9617222920;
9617221550;	9617222250;	9617222647;	9617223020;
9617221560;	9617222400;	9617222650;	9617223120;
9617221567;	9617222410;	9617222657;	9617223127;
9617221570;	9617222510;	9617222660;	9617223250;
9617230560;			

Picture 2: Hand lever with two pins



Picture 3: Hand lever with two pins (front view)



In assembled condition the WABCO Hand Brake Valve can be identified by two metal pins in the lower part of the handle as shown in picture 2 & 3.